

CHARLOTTE COUNTY
PUBLIC WORKS DEPARTMENT
CONTRACT PLANS

VETERANS BLVD AT HARBOR BLVD

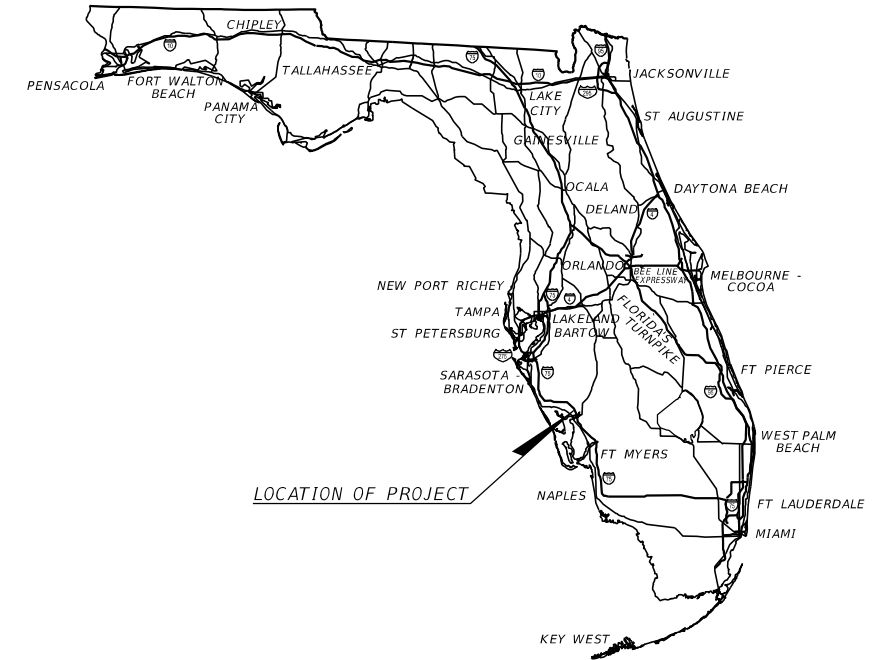

INDEX OF ROADWAY PLANS

SHEET NO.	SHEET DESCRIPTION
1	KEY SHEET
2	SIGNATURE SHEET
3	TYPICAL SECTION
4	SUMMARY OF DRAINAGE STRUCTURES
5 - 6	GENERAL NOTES
7	ROADWAY PLAN
8	GRADING PLAN
9	DRAINAGE STRUCTURES
10 - 12	CROSS SECTIONS
13	EROSION CONTROL PLAN
14	TEMPORARY TRAFFIC CONTROL PLAN
15	UTILITY ADJUSTMENTS
16	SIGNING AND PAVEMENT MARKING PLAN
17	ITS PLAN

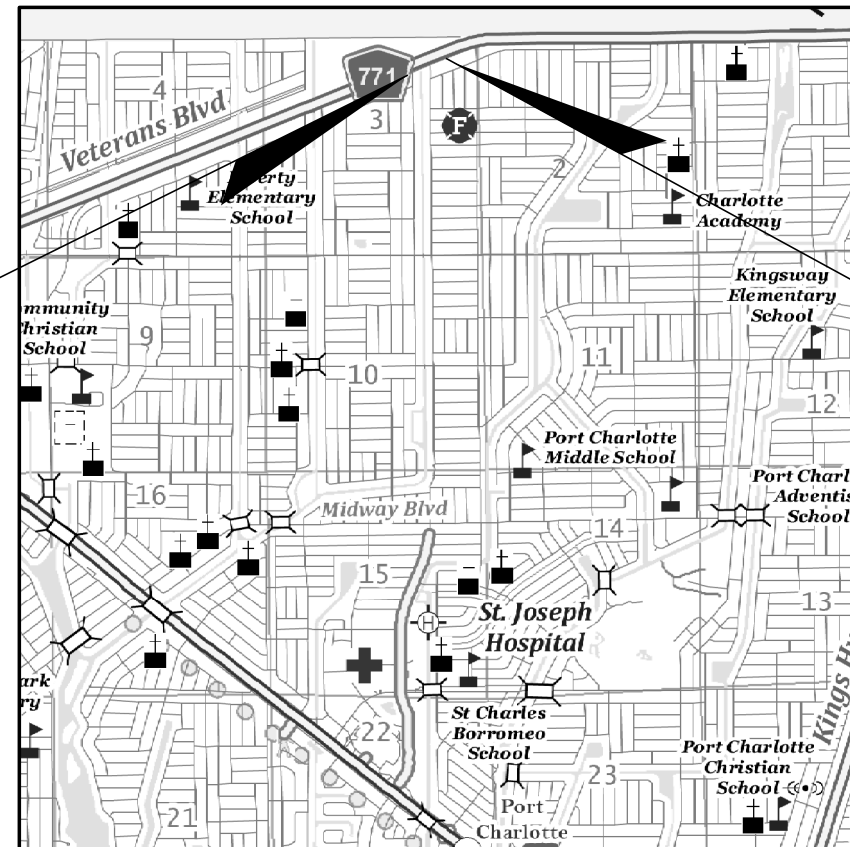

BEGIN PROJECT
STA. 2+80.00
℄ CONST. VETERANS BLVD.

END PROJECT
STA. 7+82.00
℄ CONST. VETERANS BLVD.

ROADWAY PLANS
 ENGINEER OF RECORD:

KRIS KARANXHA, P.E.
 P.E. LICENSE NUMBER 92368
 FLORIDA TRANSPORTATION ENGINEERING, INC.
 11458 NORTH 53RD STREET
 TAMPA, FLORIDA 33617
 CONTRACT NO.: 2019000297
 VENDOR NO.: F65-0183924

CHARLOTTE COUNTY PUBLIC WORKS DIRECTOR:

JOHN ELIAS

CHARLOTTE COUNTY COUNTY ENGINEER:

JOANNE VERNON, P.E.

CHARLOTTE COUNTY PROJECT MANAGER:

JEFF KEYSER

CHARLOTTE COUNTY BOARD OF COMMISSIONERS

DISTRICT 1: KEN DOHERTY

DISTRICT 2: CHRISTOPHER CONSTANCE

DISTRICT 3: BILL TRUEX

DISTRICT 4: STEPHEN R. DEUTSCH

DISTRICT 5: JOE TISEO

SHEET
 NO.

1

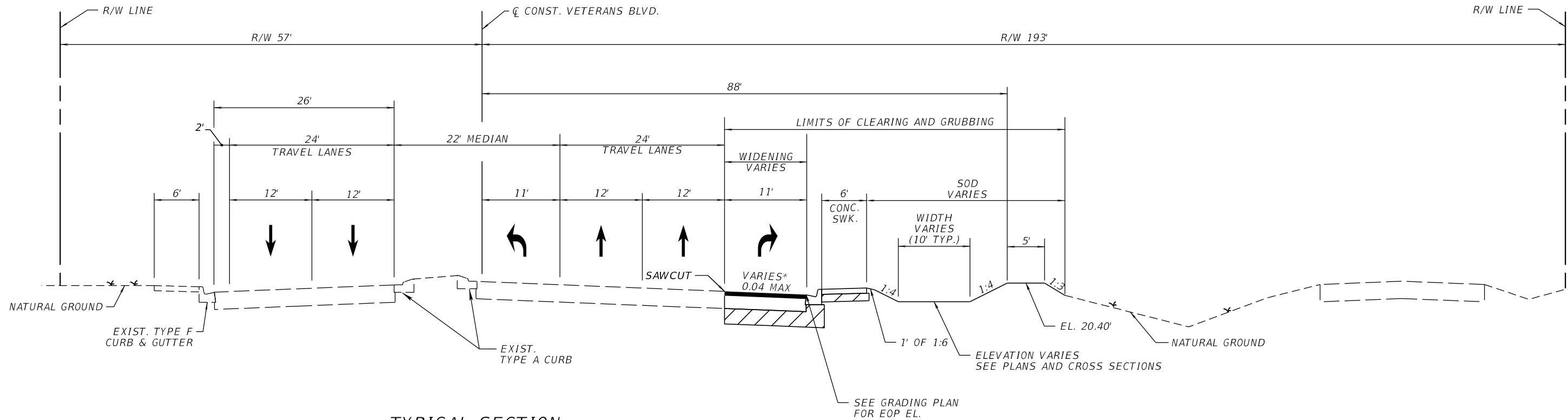

TYPICAL SECTION
VETERANS BLVD.
STA. 2+80.00 TO STA. 7+82.00

*SEE GRADING PLAN FOR DETAILS

WIDENING

OPTIONAL BASE GROUP 9
3" TYPE S-I ASPHALTIC CONCRETE
AND 1.5" TYPE S-III ASPHALT

RESURFACING

MILL EXIST. ASPHALT PAVEMENT 1.5" DEPTH
TYPE S-III ASPHALT 1.5" DEPTH

TRAFFIC DATA

CURRENT YEAR = 2024 AADT = 27968
K = 9% D = 53.2% T = 9% (24 HOUR)
DESIGN SPEED = 45 MPH
POSTED SPEED = 55 MPH

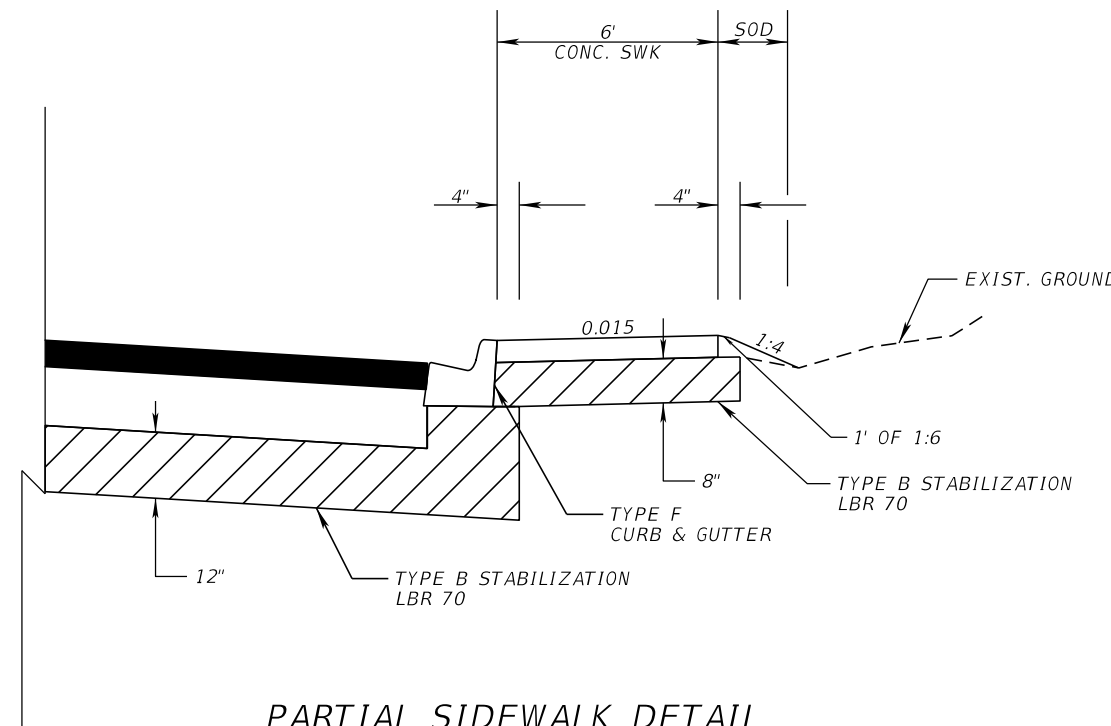

PARTIAL SIDEWALK DETAIL
(SEE PLANS FOR LOCATIONS)

12/18/2024 5:42:35 PM ShenlyReyes Z:\Projects\FDOT\Veterans at Harbor Roadway\TYP\SRD01.dgn

THE OFFICIAL RECORD OF THIS SHEET IS THE ELECTRONIC FILE DIGITALLY SIGNED AND SEALED UNDER RULE 61G15-23.004, F.A.C.

REVISIONS		ENGINEER OF RECORD		CHARLOTTE COUNTY PUBLIC WORKS DEPARTMENT	TYPICAL SECTION	SHEET NO. 3
DATE	DESCRIPTION	DATE	DESCRIPTION			
				KRIS KARANXHA, P.E. LICENSE NUMBER 92368 FLORIDA TRANSPORTATION ENGINEERING, INC. 11458 NORTH 53RD STREET TAMPA, FLORIDA 33617		

SUMMARY OF DRAINAGE STRUCTURES

QUANTITY	STR. NO.	STATION	SIDE	DESCRIPTION	BARRELS	MITERED END SECTIONS		STORM/CROSS DRAIN		CURB INLETS		MODIFICATION OF EXIST. DRAINAGE STRUCTURE (SEE DRAINAGE STRUCTURE SHEET FOR DETAILS)	REMARKS
						ELLIPTICAL	ELLIPTICAL	P-5	P-6	P-5	P-6		
						14"X23"	14"X23" RCP	<10'	<10'	<10'	<10'		
P	S-1	4+00.00	RT.	INLET, PIPE	1				18	1			
F													
P	S-2	4+00.00	RT.	MES	1	1							AT 1:4
F													
P	EX-1	5+16.40	RT.	EXIST. CS-7	1						1		
F													
P	S-3	5+59.85	RT.	INLET, PIPE	1			9		1			
F													
P	S-4	5+59.85	RT.	MES, PIPE	1	1		19					AT 1:4
F													

12/18/2024 5:42:37 PM ShenlyReyes L:\ProJects\FDOT\Veterans at Loveland\Drainage\SUMDR001.dgn

THE OFFICIAL RECORD OF THIS SHEET IS THE ELECTRONIC FILE DIGITALLY SIGNED AND SEALED UNDER RULE 61G15-23.004, F.A.C.

REVISIONS				ENGINEER OF RECORD		CHARLOTTE COUNTY PUBLIC WORKS DEPARTMENT	SUMMARY OF DRAINAGE STRUCTURES	SHEET NO.
DATE	DESCRIPTION	DATE	DESCRIPTION	MICHAEL T. MELTON, P.E. LICENSE NUMBER 77054 FLORIDA TRANSPORTATION ENGINEERING, INC. 8250 PASCAL DRIVE PUNTA GORDA, FLORIDA 33950				4

GENERAL NOTES

1. ALL BENCHMARK ELEVATIONS SHOWN ON THE PLANS ARE NORTH AMERICAN VERTICAL DATUM OF 1988 (NAVD 88). EXISTING AND PROPOSED ELEVATIONS SHOWN ARE BASED ON NORTH AMERICAN VERTICAL DATUM OF 1988 (NAVD 88).
2. ALL SURVEY INFORMATION WAS OBTAINED FROM A LICENSED FLORIDA PROFESSIONAL SURVEYOR AND MAPPER AND UTILIZED AS SUPPORTING DATA IN THE PRODUCTION OF DESIGN PLANS AND FOR CONSTRUCTION ON SUBJECT PROJECT. THE PROFESSIONAL SURVEYOR AND MAPPER OF RECORD IS:
 JOEL LABORDE RIVERA, P.L.S.
 NO: LS 7264
 FLORIDA TRANSPORTATION ENGINEERING, INC.
 11458 NORTH 53RD STREET
 TAMPA, FLORIDA, 33617
3. CONTACT CHARLOTTE COUNTY UTILITY DEPARTMENT 48 HOURS PRIOR TO CONSTRUCTION.
4. ALL WORK AND MATERIALS FOR THE PROJECT SHALL CONFORM TO CURRENT CHARLOTTE COUNTY SPECIFICATIONS.
5. EXISTING FACILITIES SHALL BE RESTORED TO A CONDITION EQUIVALENT OR BETTER TO THAT WHICH EXISTED PRIOR TO COMMENCING CONSTRUCTION, AT NO ADDITIONAL COST TO OWNER.
6. ANY LAND DISTURBED BY CONSTRUCTION SHALL BE SODDED. USE ARGENTINE BAHIA OR LIKE KIND AND CONFORM TO FDOT SPECIFICATION SECTION 570 AND STANDARD PLANS INDEX 570-010. SOD ALONG EDGES OF PAVEMENT OF ALL ROADS, SIDEWALKS, AND/OR CURB SHALL BE 1 INCH BELOW FINISHED PAVEMENT GRADE.
7. USE EXTREME CARE NOT TO DAMAGE THE ROOT SYSTEMS OF TREES AND OTHER LANDSCAPE FEATURES WHICH ARE TO REMAIN. NO EQUIPMENT, SUPPLIES, OR VEHICLES SHALL BE STORED WITHIN THE DRIP LINE OF TREES TO REMAIN.
8. ADJUST ALL VALVE BOXES, MANHOLE RIMS, GRATES, ETC. AS NECESSARY TO MATCH PROPOSED GRADES.
9. CONCRETE SIDEWALKS SHALL BE CONSTRUCTED PER FDOT INDEX NO. 522-001 (FY 2024-25) AND FDOT STANDARD SPECIFICATION NO. 522 EXCEPT FOR CURB CUT RUNS WHICH SHALL BE FINISHED IN ACCORDANCE WITH INDEX NO. 522-002 EXCEPT AMENDMENTS TO DESIGN PER CHARLOTTE COUNTY PUBLIC WORKS - ENGINEERING DIVISION. CLASS I CONCRETE, 3,000 PSI @ 28 DAYS SHALL BE USED FOR ALL SIDEWALKS AND CONCRETE STRUCTURES, SIDEWALKS TO RECEIVE FIBERMESH REINFORCING.
10. USE EXTREME CARE TO HAND-DIG THE SILT FENCE INSTALLATION IN AREAS WHERE THE IN-GROUND METER VAULT, VALVES, AND POWER LINES ARE LOCATED.
11. USE EXTREME CARE TO INSTALL THE NEW CURB OVER THE 36-INCH PCCP WATER MAIN DUE TO SHALLOW COVERAGE.
12. USE EXTREME CARE TO INSTALL THE NEW BERM OVER THE 36-INCH PCCP WATER MAIN.

DRAINAGE NOTES:

1. ALL CONCRETE PIPE SHALL BE REINFORCED WITH STEEL. PIPE LENGTH SHOWN IS CENTER OF STRUCTURE TO CENTER OF STRUCTURE AND OUTLET ENDS OF MITERED END SECTIONS AND FLARED END SECTIONS.
2. ALL CONCRETE BOX CULVERTS AND REINFORCED CONCRETE PIPE JOINTS (BOTH ROUND AND ELLIPTICAL PIPE) SHALL BE WRAPPED WITH GEOTEXTILE MATERIAL (MIRAFI, OR EQUAL). THE FABRIC SHALL COMPLETELY ENCIRCLE THE JOINT AND BE OVERLAPPED 2-1/2 FEET, AND EXTENDED 2-1/2 FEET BOTH SIDES OF THE JOINT. ALL FABRIC TO BE SECURED WITH AN APPROVED MASTIC DESIGNED FOR THIS PURPOSE.
3. THE STORM DRAINAGE PIPING AND FILTRATION SYSTEM SHALL BE SUBJECT TO A VISUAL INSPECTION BY THE OWNER'S ENGINEER PRIOR TO THE PLACEMENT OF BACKFILL. NOTIFY THE ENGINEER 48 HOURS IN ADVANCE TO SCHEDULE INSPECTION.
4. MAINTAIN THE STORM DRAINAGE SYSTEM UNTIL THE FINAL ACCEPTANCE OF THE PROJECT. THE STORM SYSTEM WILL BE INSPECTED BY THE OWNER'S ENGINEER PRIOR TO FINAL ACCEPTANCE.

HORIZONTAL & VERTICAL CONTROL TABLE						
POINT	STATION	OFFSET	NORTHING	EASTING	ELEVATION	DESCRIPTION
MT 11			980066.76	624802.59	21.00	WHITE CHEVRON - MOBILE TARGET
MT 12	3+10.30	35.89' LT	980287.10	625165.60	21.24	WHITE CHEVRON - MOBILE TARGET
MT 13	6+83.97	36.25' RT	980352.38	625540.52	20.83	WHITE CHEVRON - MOBILE TARGET
MT 14	10+05.70	35.94' LT	980534.15	625815.63	21.80	WHITE CHEVRON - MOBILE TARGET
MT 15	7+27.64	223.02' RT	980193.31	625647.69	19.73	WHITE CHEVRON - MOBILE TARGET

ORDINANCE 85-43 NOTE:

1. ORDINANCE 85-43 REQUIRES A STATEMENT WHETHER PROPOSED SWALE GRADES ARE CONSISTENT WITH ORIGINAL DRAINAGE PLANS.
2. THE PROPOSED GRADES ON THESE PLANS ARE CONSISTENT WITH THE ORIGINAL GRADES. THE ONLY MINOR MODIFICATION IS THAT THE FLOWLINE LOCATIONS ADJACENT TO THE PROPOSED ROADWAY ALIGNMENT AND WIDENING HAVE BEEN ADJUSTED. UPSTREAM SWALES OUTSIDE THE PROJECT AREA ARE NOT ALTERED, NO ADVERSE IMPACT FROM THIS ROADWAY PROJECT IS FORESEEN. ENGINEER DOES NOT MAKE ANY STATEMENT AS TO NON R/W DRAINAGE PATTERNS BEYOND THE EXTENT OF THE SURVEY AND PROJECT AREA.

12/18/2024 5:42:45 PM ShenlyReyes Z:\Projects\FDOT\Veterans at Harbor \Roadway\GINTRD01.dgn

THE OFFICIAL RECORD OF THIS SHEET IS THE ELECTRONIC FILE DIGITALLY SIGNED AND SEALED UNDER RULE 61G15-23.004, F.A.C.

REVISIONS				ENGINEER OF RECORD		SHEET NO.
DATE	DESCRIPTION	DATE	DESCRIPTION			
				KRIS KARANXHA, P.E. LICENSE NUMBER 92368 FLORIDA TRANSPORTATION ENGINEERING, INC. 11458 NORTH 53RD STREET TAMPA, FLORIDA 33617		5
				CHARLOTTE COUNTY PUBLIC WORKS DEPARTMENT		

GENERAL NOTES (1)

SIGNING AND PAVEMENT MARKING NOTES

1. ALL MARKINGS SHALL BE PAINT, NO THERMOPLASTIC.
2. PERMANENT RPM'S AS REQUIRED FOR MAINLINE EDGE, CENTER, AND LANE LINES SHALL BE PLACED WITHIN 72 HOURS OF COMPLETION OF THE MAINLINE SURFACE COURSE. OTHER LOCATIONS FOR RPM'S PLACEMENT MAY BE DESIGNATED BY THE COUNTY.

ITS NOTES







1. OBTAIN PRIOR AUTHORIZATION FOR MODIFICATION TO CHARLOTTE COUNTY IT FIBER. ALL FIBER IS TO BE COMPLETED AFTER NORMAL WORKING HOURS.

12/18/2024 5:42:46 PM ShenlyReyes
 S:\Projects\DOT Veterans at Harbor\Roadway\GNTRD01.dgn

THE OFFICIAL RECORD OF THIS SHEET IS THE ELECTRONIC FILE DIGITALLY SIGNED AND SEALED UNDER RULE 61G15-23.004, F.A.C.

REVISIONS				ENGINEER OF RECORD		SHEET NO.
DATE	DESCRIPTION	DATE	DESCRIPTION	CHARLOTTE COUNTY PUBLIC WORKS DEPARTMENT		
				OLIVER REMY RODRIGUES, P.E., P.T.O.E. LICENSE NUMBER 50646 FLORIDA TRANSPORTATION ENGINEERING, INC. 11458 NORTH 53RD STREET TAMPA, FLORIDA 33617		GENERAL NOTES (2) 6

LEGEND

	WIDENING
	CONCRETE DITCH PAVEMENT
	DETECTABLE WARNING
	MILLING AND RESURFACING
	RIP RAP
	4" THICK CONCRETE SIDEWALK

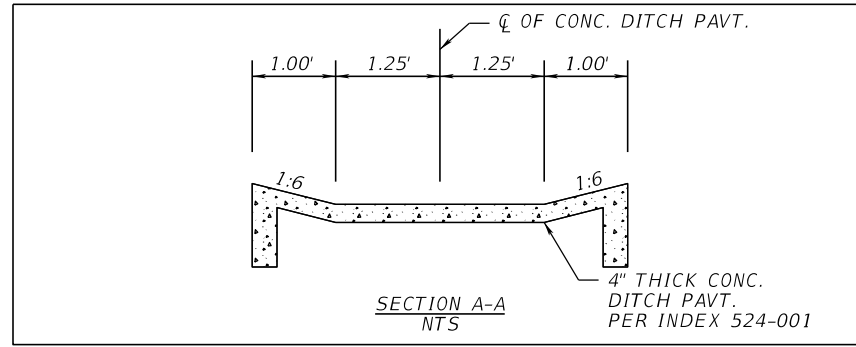

VETERANS BLVD.

END PROJECT
STA. 7+82.00
CL CONST. VETERANS BLVD.

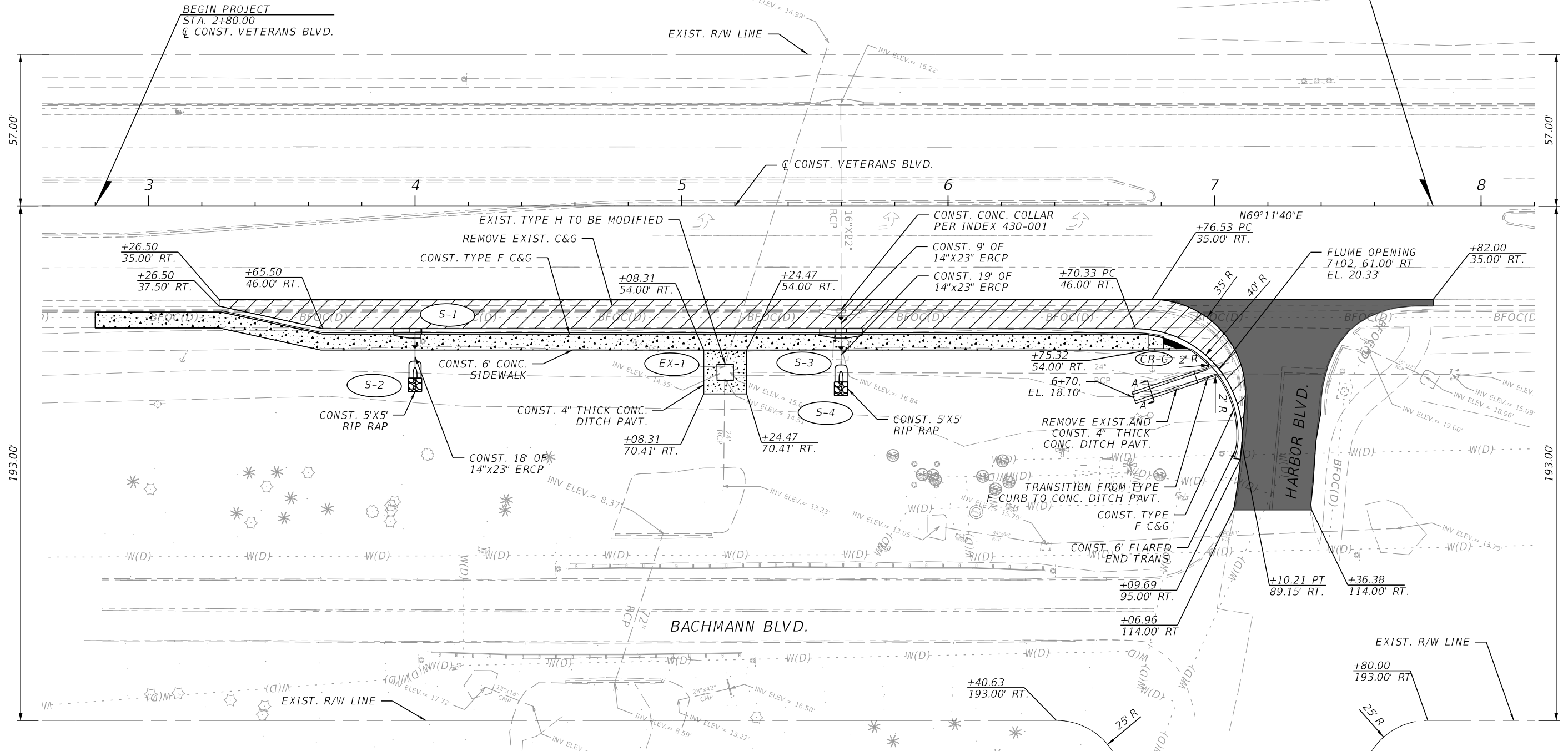

BACHMANN BLVD.

HARBOR BLVD.

11/19/2025 4:01:48 PM KaiwenChen Z:\Projects\FDOT\Veterans at Harbor\Roadway\PLANR001.dgn

REVISIONS		ENGINEER OF RECORD		SHEET NO.
DATE	DESCRIPTION	DATE	DESCRIPTION	
			KRIS KARANXHA, P.E. LICENSE NUMBER 92368 FLORIDA TRANSPORTATION ENGINEERING, INC. 11458 NORTH 53RD STREET TAMPA, FLORIDA 33617	7
			CHARLOTTE COUNTY PUBLIC WORKS DEPARTMENT	

ROADWAY PLAN

THE OFFICIAL RECORD OF THIS SHEET IS THE ELECTRONIC FILE DIGITALLY SIGNED AND SEALED UNDER RULE 61G15-23.004, F.A.C.

LEGEND

[XX.XX] EXIST. ELEVATION

[XX.XX] PROPOSED ELEVATION



VETERANS BLVD.

EXIST. R/W LINE

CONST. VETERANS BLVD.

N69°11'40"E

BACHMANN BLVD.

EXIST. R/W LINE

HARBOR BLVD.

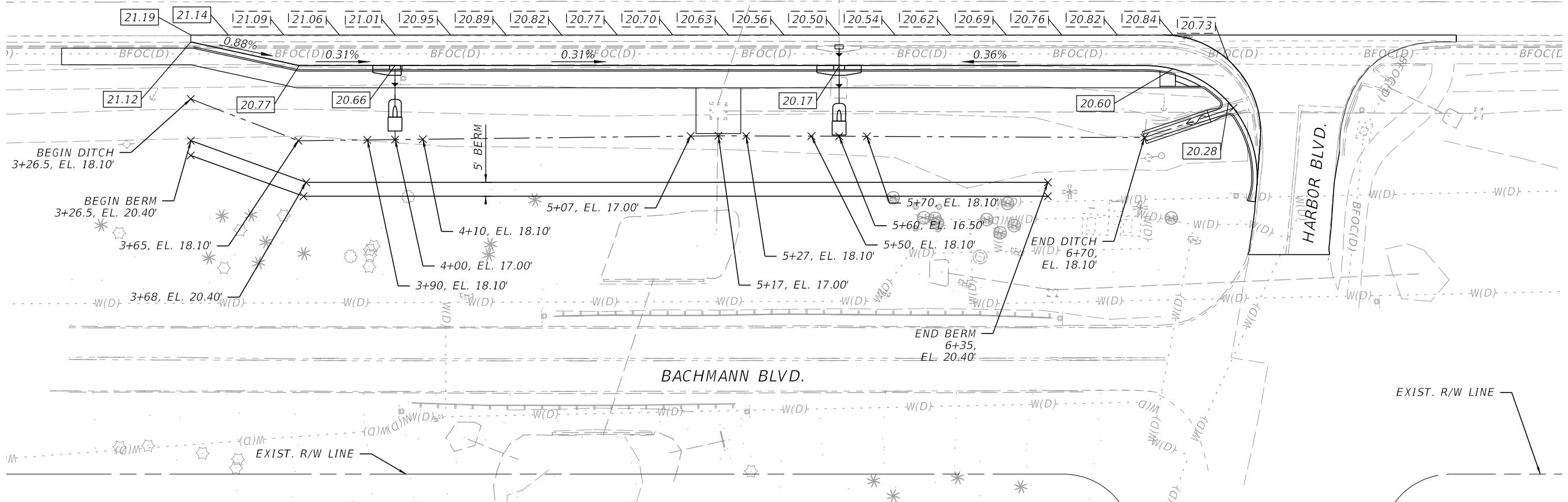

11/19/2025 11:58:21 AM KaiwenChen S:\Projects\FDOT\Veterans at Harbor Roadway\PLAN\RD01 - Grading.dgn

REVISIONS			
DATE	DESCRIPTION	DATE	DESCRIPTION

ENGINEER OF RECORD
 KRIS KARANXHA, P.E.
 LICENSE NUMBER 92368
 FLORIDA TRANSPORTATION ENGINEERING, INC.
 11458 NORTH 53RD STREET
 TAMPA, FLORIDA 33617

CHARLOTTE COUNTY
 PUBLIC WORKS DEPARTMENT

GRADING PLAN

SHEET NO.
 8

THE OFFICIAL RECORD OF THIS SHEET IS THE ELECTRONIC FILE DIGITALLY SIGNED AND SEALED UNDER RULE 61G15-23.004, F.A.C.

12/18/2024 5:43:23 PM ShenlyReyes
 Z:\Projects\FDOT\Veterans at Harbor\Drainage\DRXSRD01.dgn

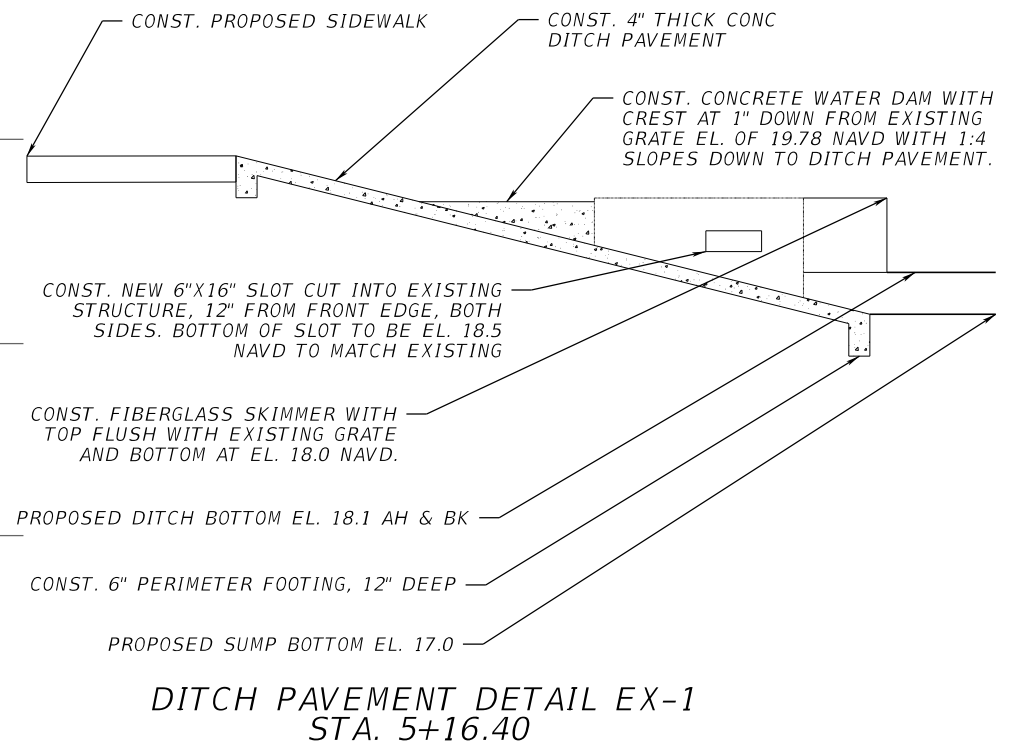
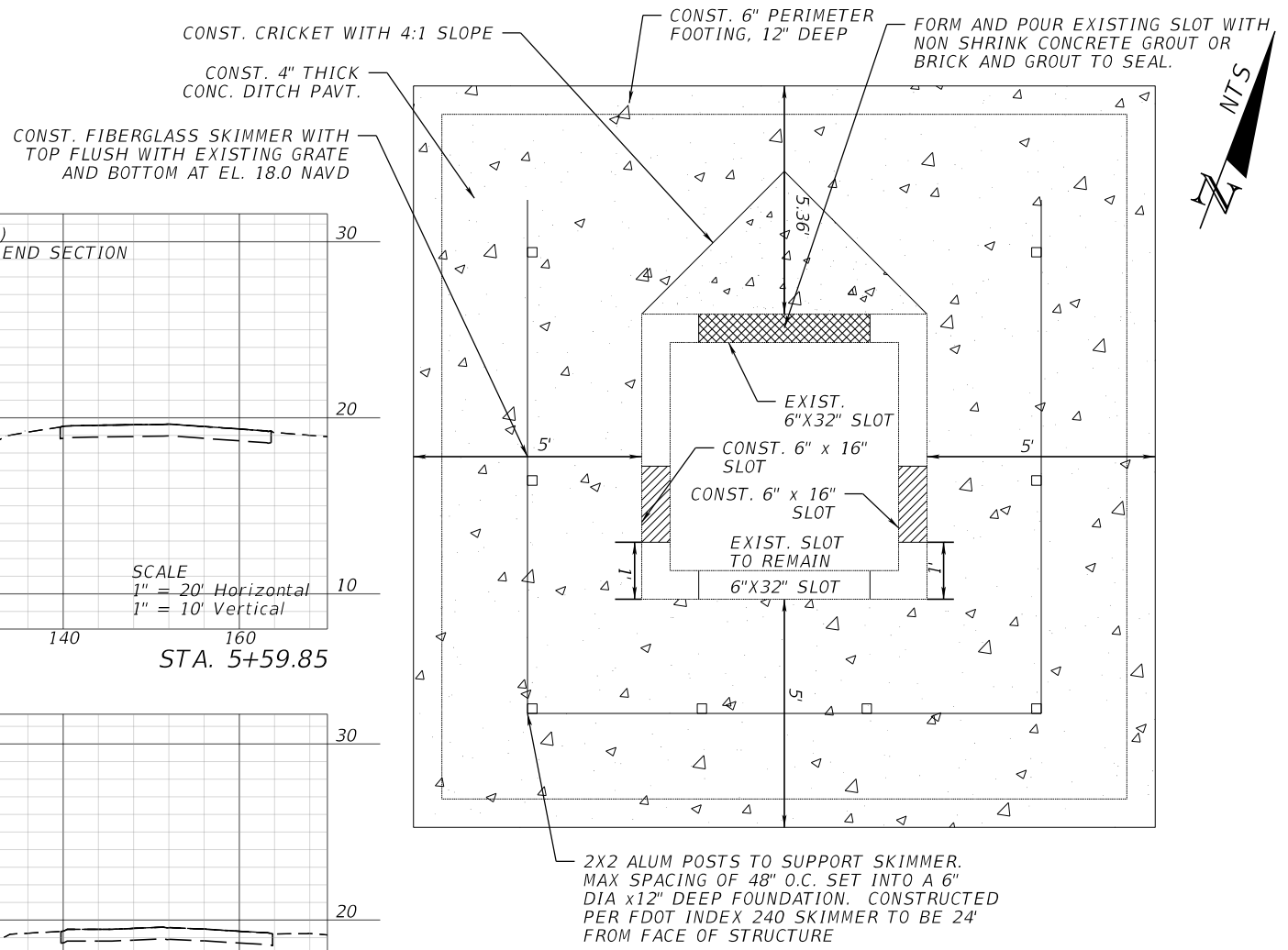
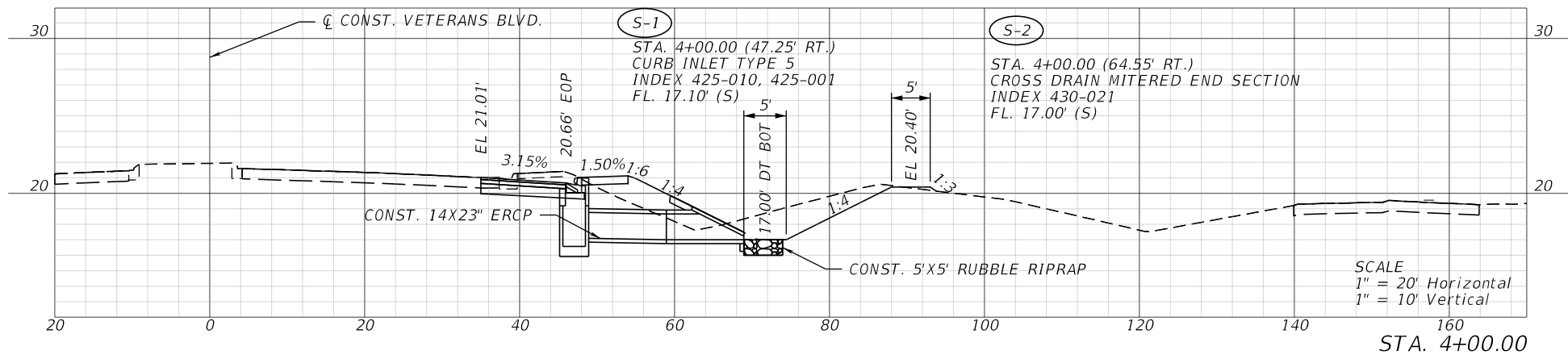
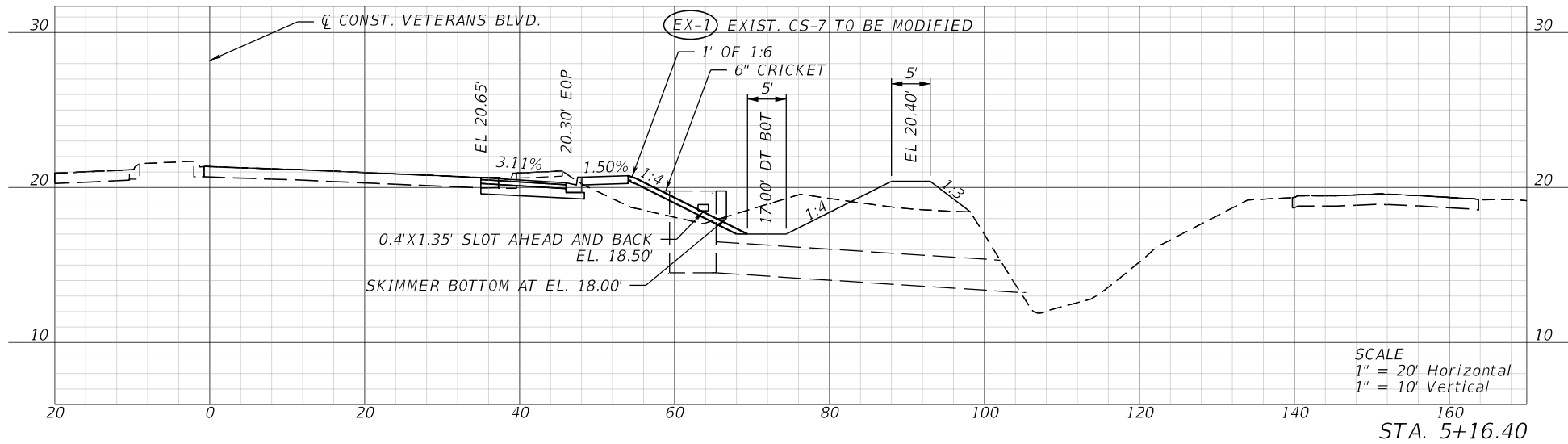
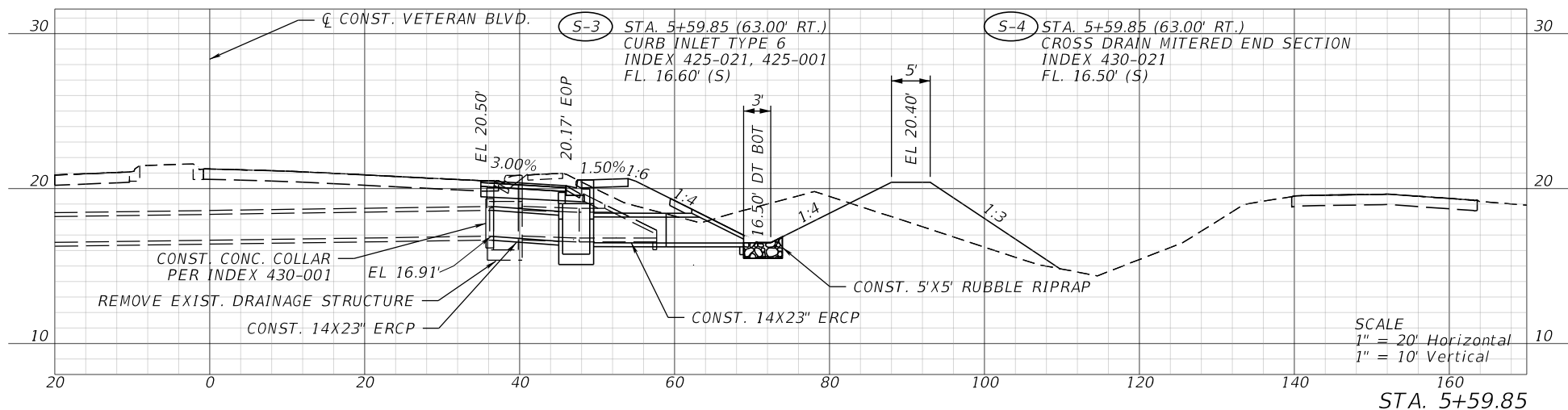

DITCH PAVEMENT DETAIL EX-1
 STA. 5+16.40

REVISIONS				ENGINEER OF RECORD		CHARLOTTE COUNTY PUBLIC WORKS DEPARTMENT	DRAINAGE STRUCTURES	SHEET NO. 9
DATE	DESCRIPTION	DATE	DESCRIPTION					
				MICHAEL T. MELTON, P.E. LICENSE NUMBER 77054 FLORIDA TRANSPORTATION ENGINEERING, INC. 8250 PASCAL DRIVE PUNTA GORDA, FLORIDA 33950				

THE OFFICIAL RECORD OF THIS SHEET IS THE ELECTRONIC FILE DIGITALLY SIGNED AND SEALED UNDER RULE 61G15-23.004, F.A.C.

12/18/2024 5:43:40 PM ShenlyReyes
 S:\Projects\DOT Veterans at Harbor Roadway\RD\SRD01.dgn

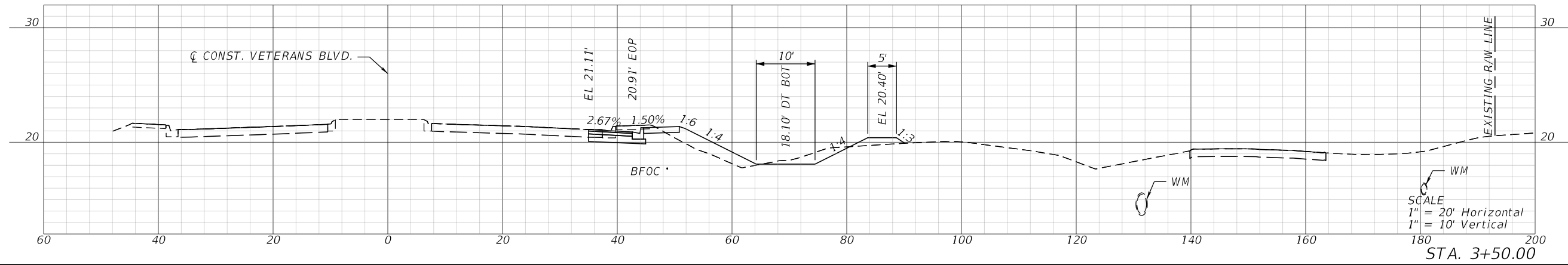
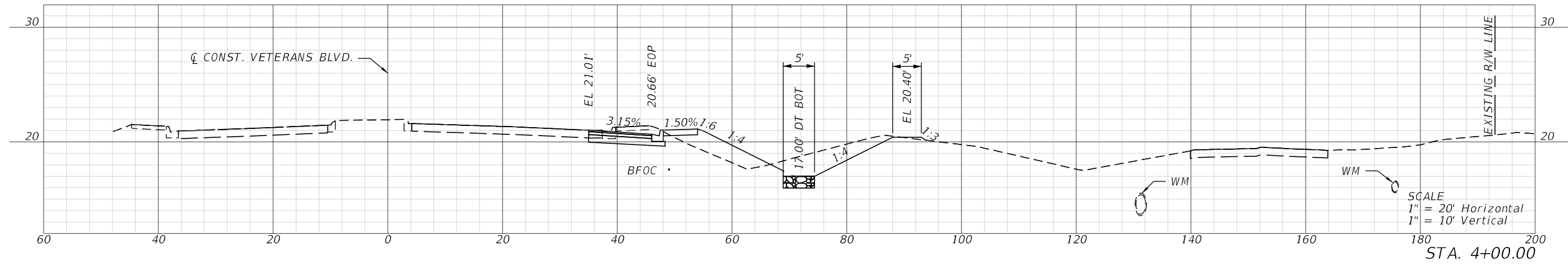

REVISIONS				ENGINEER OF RECORD		CHARLOTTE COUNTY PUBLIC WORKS DEPARTMENT	CROSS SECTIONS (1)	SHEET NO.
DATE	DESCRIPTION	DATE	DESCRIPTION	KRIS KARANXHA, P.E. LICENSE NUMBER 92368 FLORIDA TRANSPORTATION ENGINEERING, INC. 11458 NORTH 53RD STREET TAMPA, FLORIDA 33617				10

THE OFFICIAL RECORD OF THIS SHEET IS THE ELECTRONIC FILE DIGITALLY SIGNED AND SEALED UNDER RULE 61G15-23.004, F.A.C.

12/18/2024 5:43:42 PM ShenlyReyes
 S:\Projects\FDOT Veterans at Harbor Roadway\RD\SRD01.dgn

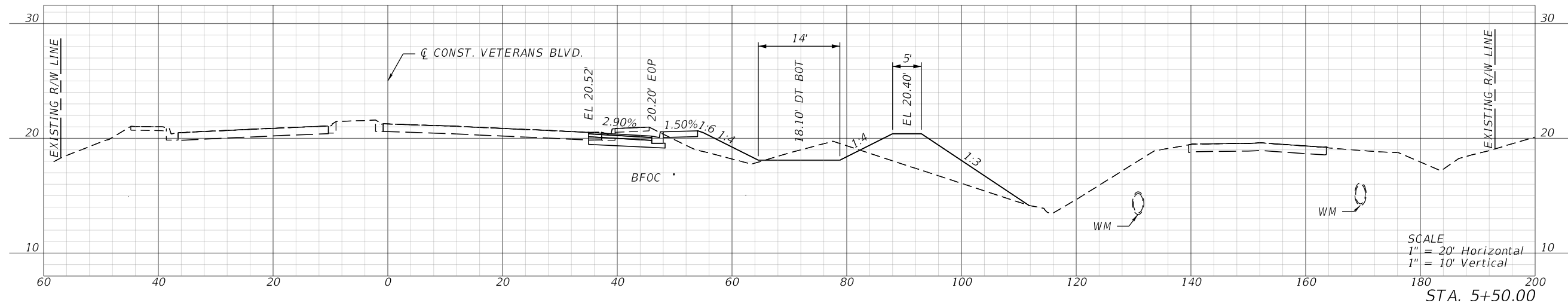

SCALE
 1" = 20' Horizontal
 1" = 10' Vertical

STA. 5+50.00

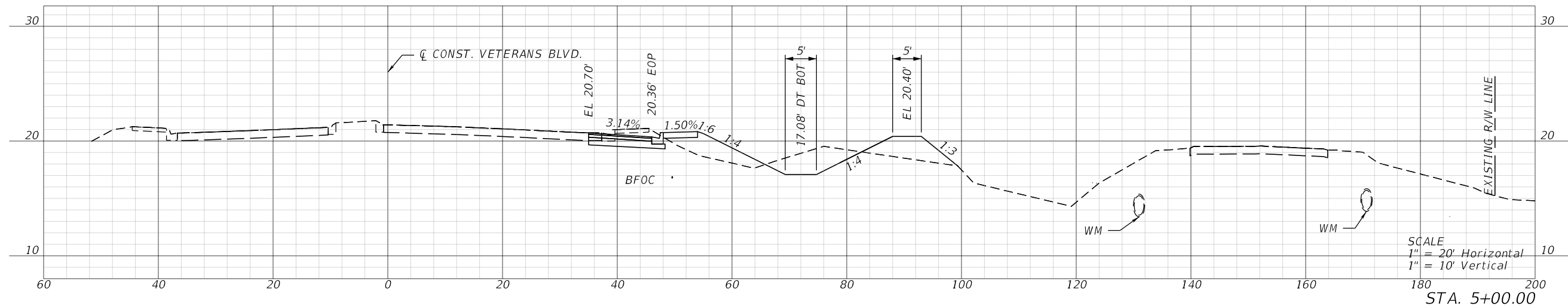

SCALE
 1" = 20' Horizontal
 1" = 10' Vertical

STA. 5+00.00

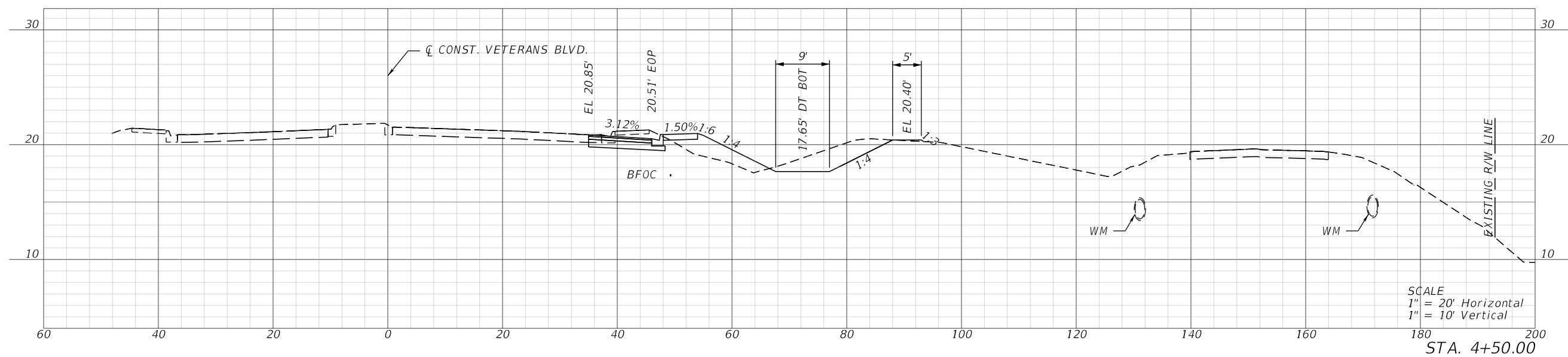

SCALE
 1" = 20' Horizontal
 1" = 10' Vertical

STA. 4+50.00

REVISIONS		ENGINEER OF RECORD		CHARLOTTE COUNTY PUBLIC WORKS DEPARTMENT	CROSS SECTIONS (2)	SHEET NO.
DATE	DESCRIPTION	DATE	DESCRIPTION			11
			KRIS KARANXHA, P.E. LICENSE NUMBER 92368 FLORIDA TRANSPORTATION ENGINEERING, INC. 11458 NORTH 53RD STREET TAMPA, FLORIDA 33617			

THE OFFICIAL RECORD OF THIS SHEET IS THE ELECTRONIC FILE DIGITALLY SIGNED AND SEALED UNDER RULE 61G15-23.004, F.A.C.

11/13/2025 3:32:46 PM KaiwenChen Z:\Projects\DOT\Veterans at Harbor \Roadway\RD\SRD01.dgn

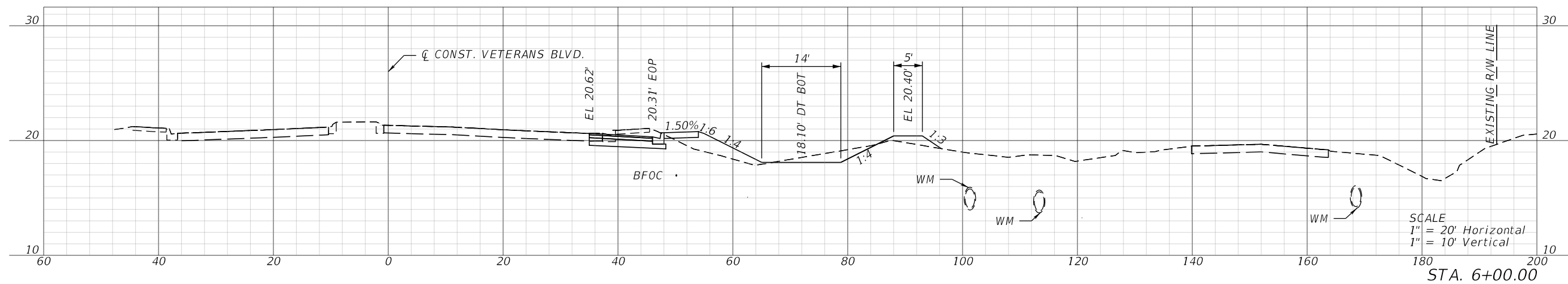
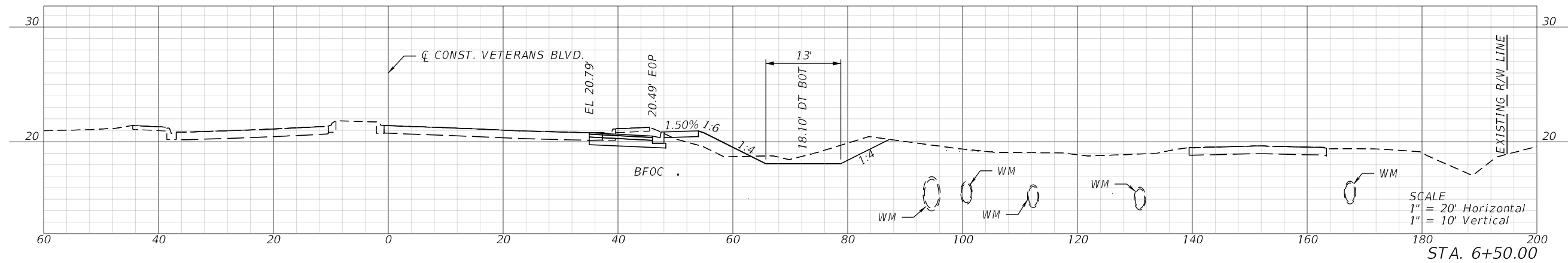
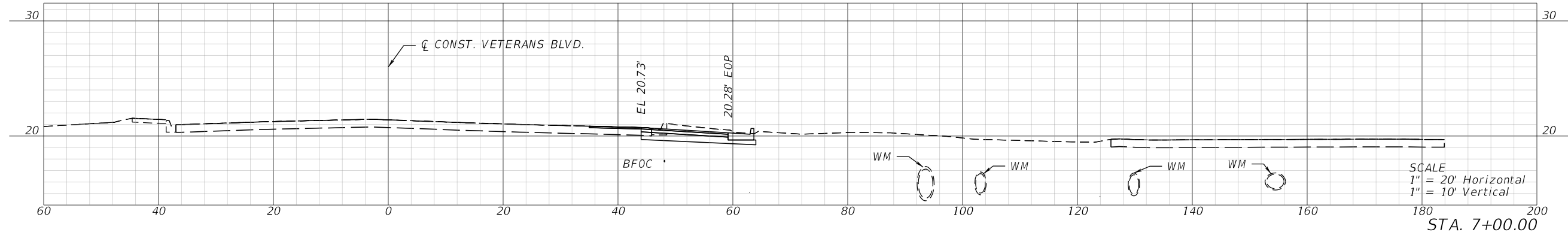

REVISIONS		ENGINEER OF RECORD		CHARLOTTE COUNTY PUBLIC WORKS DEPARTMENT	CROSS SECTIONS (3)	SHEET NO. 12
DATE	DESCRIPTION	DATE	DESCRIPTION			
				KRIS KARANXHA, P.E. LICENSE NUMBER 92368 FLORIDA TRANSPORTATION ENGINEERING, INC. 11458 NORTH 53RD STREET TAMPA, FLORIDA 33617		

THE OFFICIAL RECORD OF THIS SHEET IS THE ELECTRONIC FILE DIGITALLY SIGNED AND SEALED UNDER RULE 61G15-23.004, F.A.C.

VETERANS BLVD.

LEGEND

□□□□□□ INLET PROTECTION

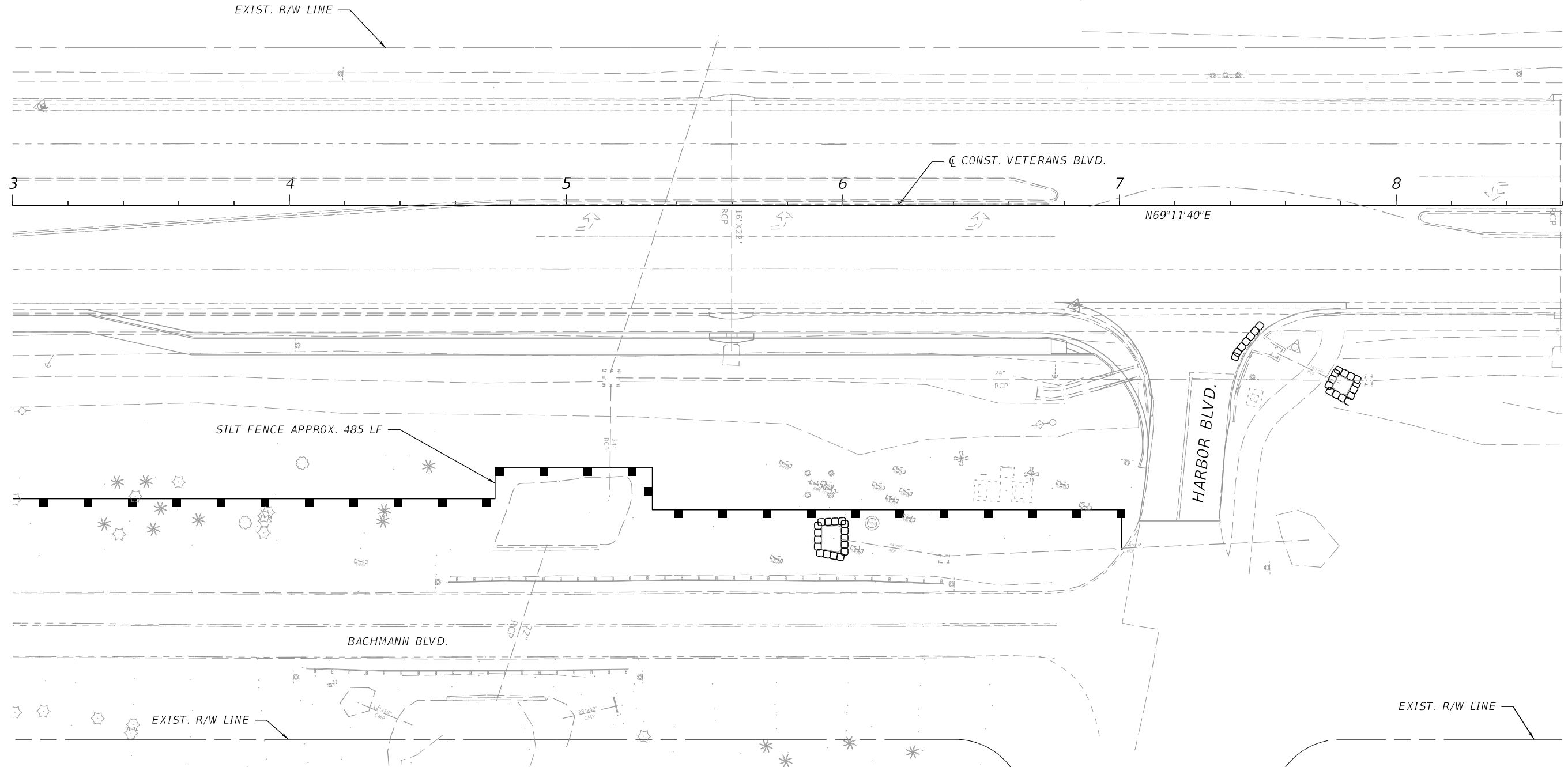
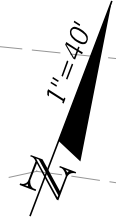

12/18/2024 5:43:53 PM SherylReyes S:\Projects\FDOT Veterans at Harbor Roadway\PLMRD01 - EC.dgn

THE OFFICIAL RECORD OF THIS SHEET IS THE ELECTRONIC FILE DIGITALLY SIGNED AND SEALED UNDER RULE 61G15-23.004, F.A.C.

REVISIONS		REVISIONS		ENGINEER OF RECORD		SHEET NO.
DATE	DESCRIPTION	DATE	DESCRIPTION			
				KRIS KARANXHA, P.E. LICENSE NUMBER 92368 FLORIDA TRANSPORTATION ENGINEERING, INC. 11458 NORTH 53RD STREET TAMPA, FLORIDA 33617		13
				CHARLOTTE COUNTY PUBLIC WORKS DEPARTMENT		

EROSION CONTROL PLAN

PHASING NOTES

PHASE I

1. INSTALL ADVANCE WARNING SIGNS AND WARNING DEVICES UTILIZING TRAFFIC CONTROL PLAN AND STANDARD PLAN INDEX 102 SERIES.
2. INSTALL TEMPORARY EROSION CONTROL DEVICES.
3. CONSTRUCT DRAINAGE AND ROADWAY WIDENING (EXCLUDING FINAL PAVEMENT LAYER) AND PEDESTRIAN IMPROVEMENTS UTILIZING INDEX 102-600, 102-602, 102-613 AND 102-615.

PHASE II

1. PLACE FINAL PAVEMENT LAYER, FINAL PAVEMENT MARKINGS AND SIGNS, UTILIZING INDEX 102-600, 102-602, 102-613 AND 102-615.

TRAFFIC CONTROL NOTES

1. CONTACT CHARLOTTE COUNTY PUBLIC WORKS DEPARTMENT FOR REVIEW AND APPROVAL OF THE TRAFFIC CONTROL PLAN PRIOR TO COMMENCING CONSTRUCTION.
2. REDUCE THE EXISTING POSTED SPEED FROM 55 MPH TO 45 MPH IN ADVANCE OF THE CONSTRUCTION LIMITS UTILIZING INDEX 102-600.
3. MAINTAIN PEDESTRIAN ACCESS UTILIZING INDEX 102-660.

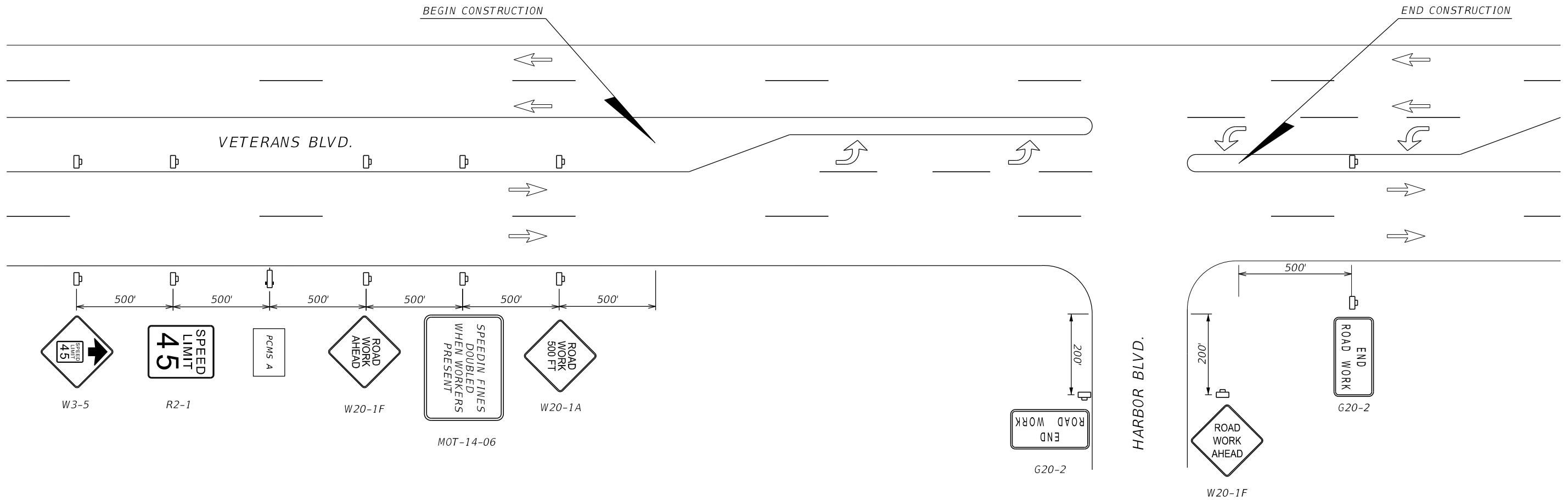

PCMS A		PCMS A	
14 DAYS PRIOR TO CONSTRUCTION		DURING CONSTRUCTION	
ROAD WORK	XX/XX TO XX/XX	RIGHT LANE CLOSED	MERGE LEFT

REVISIONS				ENGINEER OF RECORD		CHARLOTTE COUNTY PUBLIC WORKS DEPARTMENT	TEMPORARY TRAFFIC CONTROL PLAN	SHEET NO.
DATE	DESCRIPTION	DATE	DESCRIPTION	KRIS KARANXHA, P.E. LICENSE NUMBER 92368 FLORIDA TRANSPORTATION ENGINEERING, INC. 11458 NORTH 53RD STREET TAMPA, FLORIDA 33617				14

12/18/2024 5:43:55 PM ShenlyReyes S:\Projects\FDOT Veterans at Harbor Roadway\TCPLR001.dgn

THE OFFICIAL RECORD OF THIS SHEET IS THE ELECTRONIC FILE DIGITALLY SIGNED AND SEALED UNDER RULE 61G15-23.004, F.A.C.

NOTES

1. THE LOCATION(S) OF THE UTILITIES SHOWN IN THE PLANS (INCLUDING THOSE DESIGNATED VV, VH, AND VVH) ARE BASED ON LIMITED INVESTIGATION TECHNIQUES AND SHOULD BE CONSIDERED APPROXIMATE ONLY. THE VERIFIED LOCATIONS/ELEVATIONS APPLY ONLY AT THE POINTS SHOWN. INTERPOLATIONS BETWEEN THESE POINTS HAVE NOT BEEN VERIFIED.

2. UTILITY/AGENCY OWNERS:

COMPANY:
 CHARLOTTE COUNTY UTILITIES
 CHARLOTTE COUNTY LIGHTING DISTRICT
 CHARLOTTE COUNTY ITS SYSTEM
 FLORIDA POWER & LIGHT (TRANSMISSION)
 PEACE RIVER MANASOTA REGIONAL WATER SUPPLY AUTHORITY

CONTACT
 HENDRIK DOLLEMAN
 JODY MANSELL
 EVAN LEIBMAN
 CRAIG LEDBETTER
 SCOTT CUNNINGHAM

PHONE NUMBER:
 (941) 883-3521
 (941) 575-3648
 (941) 764-5504
 (561) 803-7942
 (836) 993-4656

EMAIL ADDRESS
 HENDRIK.DOLLEMAN@CHARLOTTECOUNTYFL.GOV
 JODY.MANSELL@CHARLOTTECOUNTYFL.GOV
 EVAN.LEIBMAN@CHARLOTTECOUNTYFL.GOV
 CRAIG.LEDBETTER@FPL.COM
 SCUNNINGHAM@REGIONALWATER.ORG

3. ENSURE THAT PEACE RIVER AUTHORITY AND CCU WATER MAINS ARE PROTECTED AT ALL TIMES. THESE MAINS ARE THE MAJOR TRANSMISSION MAINS THAT SERVE MID AND WEST COUNTY.

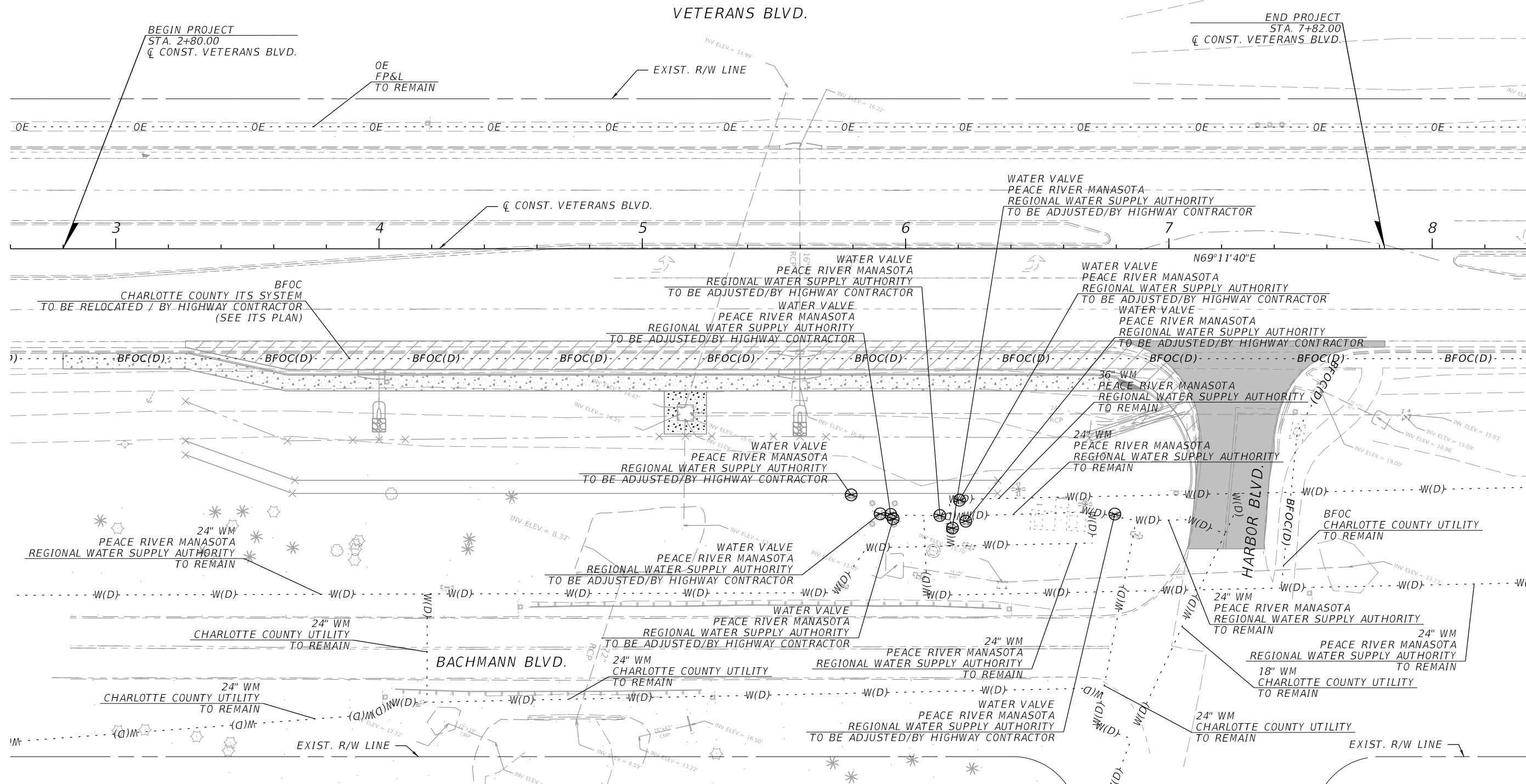

11/18/2025 2:06:21 PM KaiwenChen Z:\Projects\FDOT\Veterans at Harbor\Roadway\UT\ADRD01.dgn

REVISIONS		ENGINEER OF RECORD		CHARLOTTE COUNTY PUBLIC WORKS DEPARTMENT	UTILITY ADJUSTMENTS	SHEET NO. 15
DATE	DESCRIPTION	DATE	DESCRIPTION			
				KRIS KARANXHA, P.E. LICENSE NUMBER 92368 FLORIDA TRANSPORTATION ENGINEERING, INC. 11458 NORTH 53RD STREET TAMPA, FLORIDA 33617		

THE OFFICIAL RECORD OF THIS SHEET IS THE ELECTRONIC FILE DIGITALLY SIGNED AND SEALED UNDER RULE 61G15-23.004, F.A.C.

VETERANS BLVD.

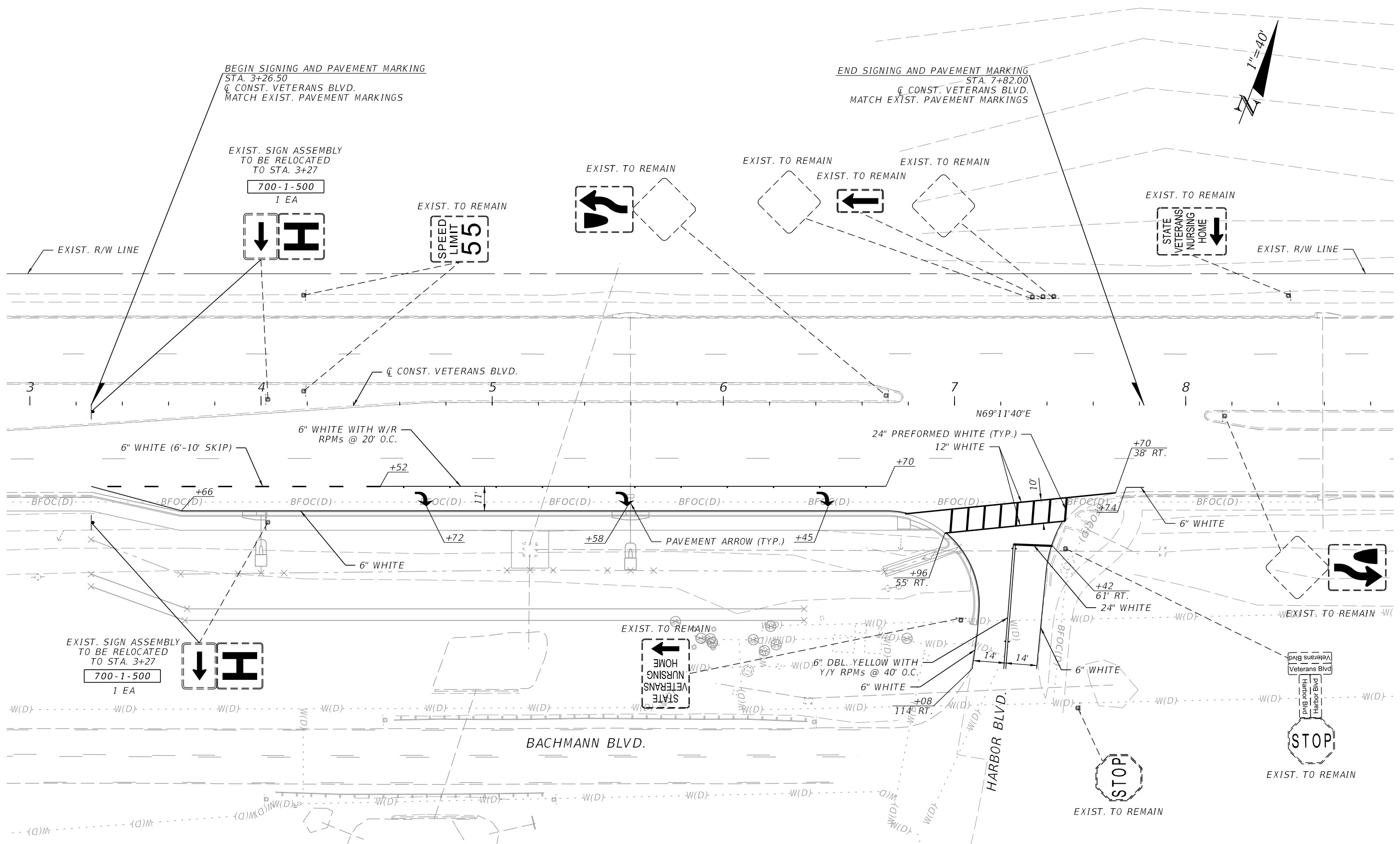

11/18/2025 2:00:26 PM KaiwenChen S:\Projects\FDOT Veterans at Harbor\SigningAndMarking\PLANS001.dgn

THE OFFICIAL RECORD OF THIS SHEET IS THE ELECTRONIC FILE DIGITALLY SIGNED AND SEALED UNDER RULE 61G15-23.004, F.A.C.

REVISIONS		ENGINEER OF RECORD		CHARLOTTE COUNTY PUBLIC WORKS DEPARTMENT	SIGNING AND PAVEMENT MARKING PLAN	SHEET NO. 16
DATE	DESCRIPTION	DATE	DESCRIPTION			
			OLIVER REMY RODRIGUES, P.E. LICENSE NUMBER 50646 FLORIDA TRANSPORTATION ENGINEERING, INC. 11458 NORTH 53RD STREET TAMPA, FLORIDA 33617			

