

CHARLOTTE COUNTY
BOARD OF COUNTY COMMISSIONERS

KEN DOHERTY
DISTRICT 1

CHRISTOPHER CONSTANCE
DISTRICT 2

BILL TRUEX
DISTRICT 3

STEPHEN R. DEUTSCH
DISTRICT 4

JOSEPH TISEO
DISTRICT 5

HECTOR FLORES
COUNTY ADMINISTRATOR

CCU PRJ # 22-0001 DORCHESTER ST WM REPLACEMENT



S04, 09,16-T40S-R22E

Sheet List Table

Sheet Number	Sheet Title
1	COVER
2	KEYSHEET
3	NOTES-LEGEND
4	PLAN-01
5	PLAN-02
6	PLAN-03
7	PLAN-04
8	PLAN-05
9	PLAN-06
10	PLAN-07
11	PLAN-08
12	PLAN-09
13	PLAN-10

PROJECT VICINITY

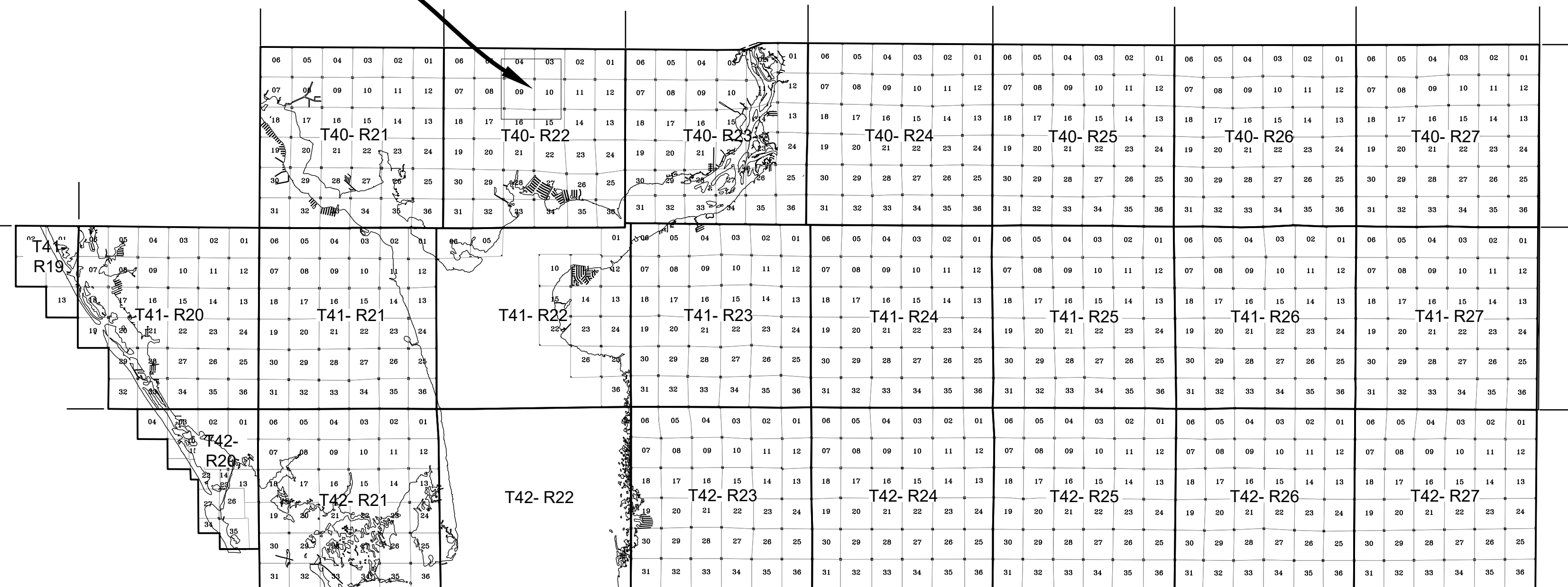

All elevations are based on North American Vertical Datum (NAVD) 1988 unless otherwise noted. Coordinates are in the Florida West Zone/ NAD 83-90 State Plane FEET Coordinate System.

The Contractor is responsible for compliance with the applicable technical requirements of the Charlotte County Utility (CCU) Design Compliance Standards dated November 1, 2011 which are not included with the engineering drawings but are available for download on the CCU website at <http://www.charlottecountyfl.com/CCU/Engineering>.

Any exception(s) to the Design Compliance Standards are included in the Special Provisions of the Bid documents.



Call 811 or visit sunshine811.com two full business days before digging to have buried facilities located and marked. Check positive response codes before you dig!

CONSTRUCTION



DESIGNED BY:	DRAWN BY:	CHECKED BY:	PROJECT NO.:	DATE:	SCALE:	PLANT DATE:	FILE LOCATION:	SIZE:	DESCRIPTION:
S-T-R	DEC	DEC	22-0001	2021-10-19	AS SHOWN	2021-11-17 11:32 AM	R:\CURRENT-PROJECTS_ACTIVE\2022-0001_Dorchester St\Main\Registration\CAD\Production\Drawings	24x36x 0.0108.dwg	

CHARLOTTE COUNTY UTILITIES
25550 HARBOR VIEW RD.
PORT CHARLOTTE FL 33980
PH: 941-764-4516
FAX: 941-764-4969

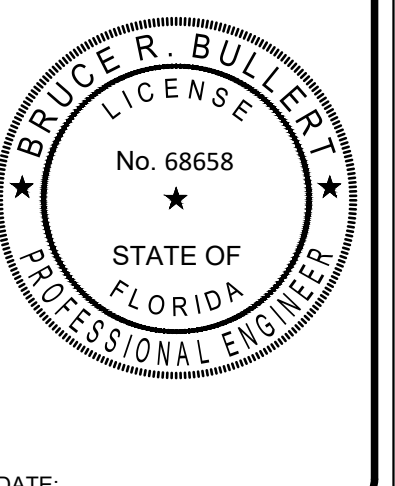

22-0001 DORCHESTER ST WM REPLACEMENT
COVER

SHEET
1

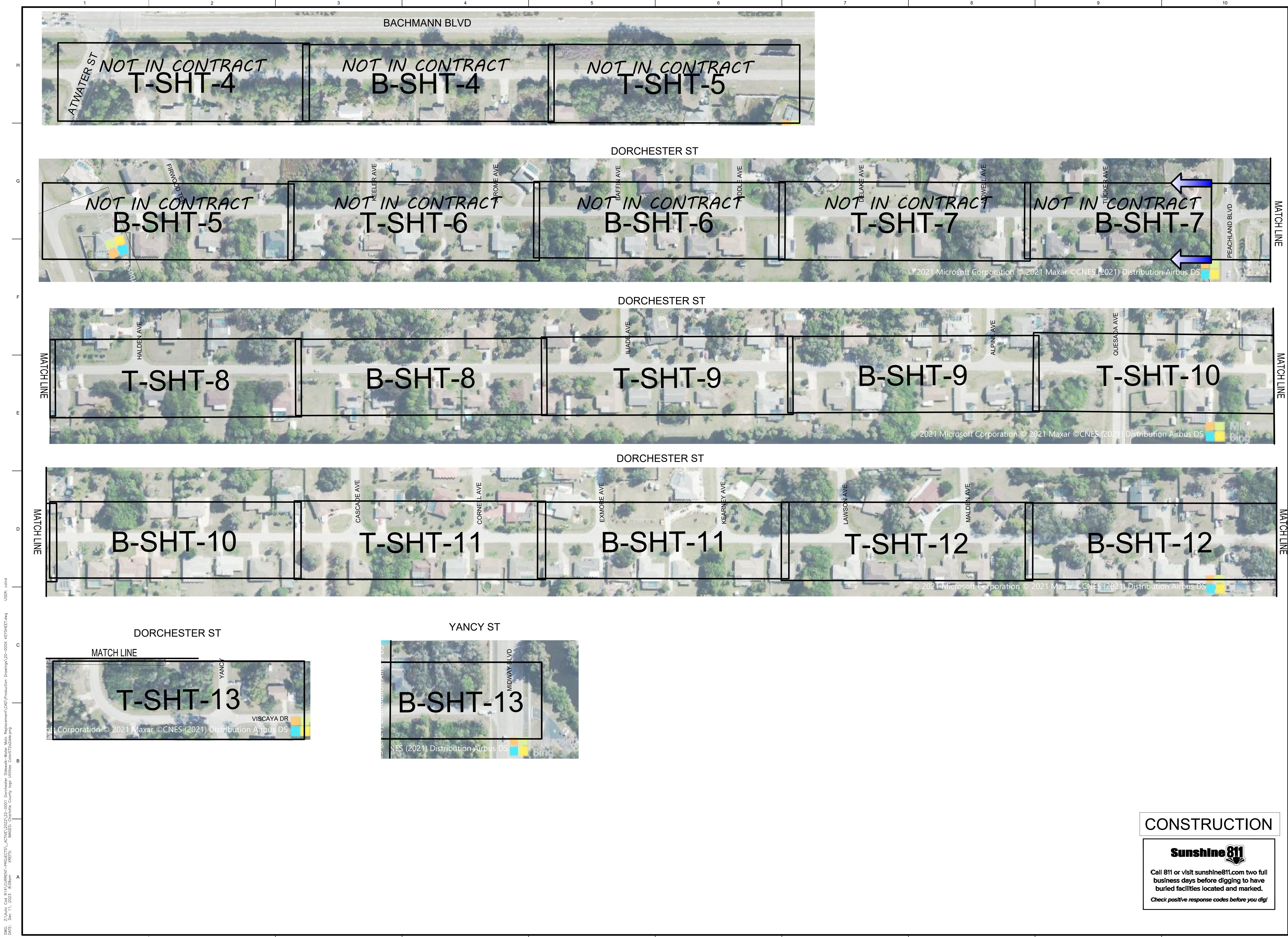

No.	DESCRIPTION	DATE	BY

DESIGNED BY: DEC	DRAWN BY: DEC	CHKD BY: BBC
DATE: 2021-10-19	S.F.P. S04_00_16-T-105-R2E 22-0001	PROJECT NO.
DATE: 2021-10-19	SCALE: 1" = 100'	PLOT DATE: 2023-12-11 8:08 AM
DATE: 2021-10-19	SCALE: 1" = 100'	PLOT DATE: 2023-12-11 8:08 AM
FILE LOCATION: Z:\AUGUS CH	FILE NAME: R:\CURRENT PROJECTS_ACTIVE\2022\22-0001 Dorchester	FILE NUMBER
FILE NAME: S:\work\Water Main Replacement\CAD Production Drawings	FILE NUMBER: 22-0001	FILE NUMBER
FILE NAME: S:\work\Water Main Replacement\CAD Production Drawings	FILE NUMBER: 22-0001	FILE NUMBER
FILE NAME: S:\work\Water Main Replacement\CAD Production Drawings	FILE NUMBER: 22-0001	FILE NUMBER
FILE NAME: S:\work\Water Main Replacement\CAD Production Drawings	FILE NUMBER: 22-0001	FILE NUMBER
FILE NAME: S:\work\Water Main Replacement\CAD Production Drawings	FILE NUMBER: 22-0001	FILE NUMBER

CHARLOTTE COUNTY UTILITIES
 25550 HARBOR VIEW RD.
 PORT CHARLOTTE FL 33980
 PH: 941-764-4516
 FAX: 941-764-4969

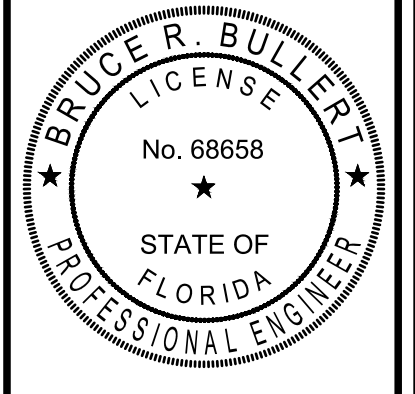

DATE: _____

22-0001 DORCHESTER ST WM
 REPLACEMENT
 KEYSHEET

SHEET
 2

CONSTRUCTION

Sunshine 811
 Call 811 or visit sunshine811.com two full business days before digging to have buried facilities located and marked.
 Check positive response codes before you dig!

DWG: Z:\AUGUS CH\PROJECTS_ACTIVE\2022\22-0001 Dorchester - S:\work\Water Main Replacement\CAD Production Drawings\22-0001 KEYSHEET.dwg
 DATE: 11/11/2023 9:08am
 USER: cshd

NOTES:

1. ALL EXISTING UTILITIES SHOWN ON THESE PLANS ARE APPROXIMATE ONLY AND SHALL BE FIELD VERIFIED PRIOR TO CONSTRUCTION.
2. FOR UTILITY AND DRAINAGE CONFLICTS, SEE THE CCU "TYPICAL UTILITY CROSSING DETAIL" PAGE GD-23 AND MAIN SEPARATION DETAIL PAGE GD-05 IN THE STANDARD DRAWING DETAILS ONLINE.
3. FOR DIRECTIONAL BORE REQUIREMENTS SEE TYPICAL DIRECTIONAL BORE DETAIL PAGE GD-10 IN THE STANDARD DRAWING DETAILS ONLINE.
4. DIMENSIONS SHOWN ON THESE PLANS ARE FROM MATCHLINE TO MATCHLINE UNLESS NOTED.
5. OPEN CUT ROADS:
 - A. ANY STRIPING, STOP BARS, ETC, DAMAGED OR OBLITERATED AS THE RESULTS OF CONSTRUCTION ACTIVITY SHALL BE REPLACED IN KIND.
6. OPEN CUT DRIVEWAYS:
 - A. ALL DISTURBED CONCRETE DRIVEWAYS SHALL BE REMOVED AND REPLACED FROM THE EDGE OF PAVEMENT TO THE NEAREST CONSTRUCTION / EXPANSION JOINT.
7. CONTRACTOR SHALL OBTAIN PERMITS WITHIN CHARLOTTE COUNTY RIGHT-OF-WAY.
8. METERS SHALL BE PLACED IN ACCORDANCE WITH THE CHARLOTTE COUNTY UNIFORM WATER AND SEWER TARIFF, BOOK 1159 PAGE 735 ADOPTED MAY 9, 1991, RECORDED MAY 31ST, 1991, RULE NUMBER 30.0 - METERS.
9. THESE DRAWINGS WERE CREATED UTILIZING GPS EQUIPMENT. DUE TO THE SMALL VARIANCES IN ELEVATIONS CREATED BY USING GPS ANY ELEVATIONS WE SUPPLY ARE ONLY FOR THE PROJECT SPECIFIED. THEY ARE BASED ON NAVD88 BUT ARE NOT SET BY DIFFERENTIAL LEVELING SURVEY METHODS AND SHOULD BE REGARDED IN THE SAME MANNER AS AN ASSUMED BENCH MARK.
10. THE STATIONED ALIGNMENTS DEPICTED ON THESE PLANS ARE BASED ON THE APPROXIMATE CENTERLINE OF THE RIGHT-OF-WAY ONLY. THE LOCATIONS OF THE RIGHT-OF-WAYS AND PROPERTY LINES HAVE NOT BEEN VERIFIED IN THE FIELD, OR CERTIFIED BY A LICENSED LAND SURVEYOR.
11. THE STATIONED ALIGNMENT GEOMETRY HAS BEEN IDENTIFIED FOR THE PURPOSES OF ESTABLISHING A RELATIONSHIP BETWEEN THE STATIONED ALIGNMENTS AND THE PROPOSED APPURTENANCES TO BE PLACED IN THE GROUND BY CHARLOTTE COUNTY UTILITIES, AND IN NO WAY DEPICTS THE ACTUAL LOCATION OF SUCH APPURTENANCES.
12. THE INTENTION OF THESE PLANS IS TO HAVE ALL PROPOSED CHARLOTTE COUNTY APPURTENANCES LOCATED WITHIN CHARLOTTE COUNTY RIGHTS-OF WAYS, OR WITHIN PROPERTY LINES OF LAND OWNED BY CHARLOTTE COUNTY/CHARLOTTE COUNTY UTILITIES, OR WITHIN EASEMENTS GRANTED TO THE SAME.

13. CHARLOTTE COUNTY SHALL ASSUME NO LIABILITY FOR ANY ERRORS, OMISSIONS, OR INACCURACIES IN THE INFORMATION PROVIDED REGARDLESS OF HOW CAUSED. CHARLOTTE COUNTY SHALL ASSUME NO LIABILITY FOR ANY DECISIONS MADE OR ACTIONS TAKEN OR NOT TAKEN BY THE USER OF THE INFORMATION OR DATA FURNISHED HEREIN.
14. THE RESOURCES FOR THE RIGHT-OF-WAY LINES, PROPERTY LINES AND BUILDING OUTLINES IS THE CHARLOTTE COUNTY G.I.S. DEPARTMENT (C) COPYRIGHT 2021.
15. PLEASE REFER TO THE CHARLOTTE COUNTY G.I.S. WEB SITE FOR ADDITIONAL DATA INFORMATION AND ACCURACIES. (<https://www.charlottecountyfl.gov/gis/shapefile-gallery.shtml>)
16. PLEASE REFER TO THE CHARLOTTE COUNTY UTILITIES DEPARTMENT STANDARD DRAWING DETAILS LOCATED AT THIS WEB ADDRESS; (<https://www.charlottecountyfl.gov/departments/utilities/engineering/standard-drawing-details.shtml>)
17. PLEASE REFER TO THE CHARLOTTE COUNTY UTILITIES DEPARTMENT STANDARD SPECIFICATIONS LOCATED AT THIS WEB ADDRESS; (<https://www.charlottecountyfl.gov/departments/utilities/engineering/standard-specifications.shtml>)
18. PLEASE REFER TO CHARLOTTE COUNTY PUBLIC WORKS DEPARTMENT FOR PAVEMENT RESTORATION. (<https://www.charlottecountyfl.gov/core/fileparse.php/363/urlt/engineering-design-and-construction-standards.pdf>)
19. PLEASE REFER TO THE CHARLOTTE COUNTY UTILITIES MOST CURRENT APPROVED PRODUCTS LIST DATED JUNE 1, 2021 AND AMENDED JUNE 2, 2021 FOR ALL PRODUCTS. (<https://www.charlottecountyfl.gov/core/fileparse.php/532/urlt/approved-product-s-list-06-21.pdf>)
20. ALL EXISTING METER BOXES AND SERVICES WILL BE REPLACED TO THE MAIN. NO METER BOXES SHALL BE PLACE IN THE SIDEWALK. ALL METER BOXES SHALL BE PLACED AT THE PROPERTY LINE IN THE ROW OR AS CLOSE AS POSSIBLE TO THE ROW LINE ON THE CUSTOMERS SIDE OF THE PROPERTY PIN.
21. A TEMPORARY MAIN MAY BE NEEDED IN AREAS OF CONFLICT WITH THE EXISTING MAIN.

ABBREVIATIONS

AC	ASBESTOS CONCRETE PIPE	G	NATURAL GAS
APROX	APPROXIMATELY	N	NORTH
ASPH	ASPHALT	N:	NORTHING
BO	BLOW-OFF	NIC	NOT IN CONTRACT
CTV	CABLE TV	NTS	NOT TO SCALE
CI	CAST IRON PIPE	OHL	OVERHEAD UTILITY LINE
CB	CATCH BASIN	PG	PAGE
CL	CENTER LINE	PED	PEDESTAL
CO	CLEAN-OUT	PCP	PERMANENT CONTROL POINT
CONC	CONCRETE	PG	PLUG VALVE
CM	CONCRETE MONUMENT	PT.	POINT
DAT	DATUM	PVC	POLYVINYL CHLORIDE PIPE
DWG	DRAWING	PL	PROPERTY LINE
DI	DUCTILE IRON PIPE	RGE	RANGE
ESMT	EASEMENT	RCM	RECLAIMED WATER MAIN
E	EAST	RCP	REINFORCED CONCRETE PIPE
E:	EASTING	RT	RIGHT
ELEC	ELECTRIC	ROW	RIGHT OF WAY
ETB	TOP OF BANK	SARV	SEWER AIR RELEASE VALVE
EBS	BOTTOM OF SLOPE	SEC	SECTION
EX	EXISTING	SFV	SEWER FORCEMAIN VALVE
FH	FIRE HYDRANT	ST	SEPTIC TANK
FT	FOOT	SVC	SERVICE
FM	FORCE MAIN	SLE	SEWER LINE EXTENSION
FOC	FIBER OPTIC CABLE	SLV	SLEEVE
GALV	GALVANIZED PIPE	S	SOUTH
GV	GATE VALVE	SST	STAINLESS STEEL
HORZ	HORIZONTAL	STA	STATION
IN	INCH	SD	STORM DRAIN
INST	INSTALL	TEL	TELEPHONE
INV	INVERT	TEMP	TEMPORARY
IP	IRON PIPE	TERM	TERMINAL
IR	IRON ROD	TOS	TOE OF SLOPE
IRC	IRON ROD AND CAP	TOB	TOP OF BANK
LF	LINEAR FEET	T.O.P.	TOP OF PIPE
LFT	LEFT	TWP	TOWNSHIP
LS	LIFT STATION	TYP	TYPICAL
LT	LIGHT	UG	UNDERGROUND
LF	LINEAR FEET	UG-TEL	UNDERGROUND TELEPHONE
LP	LOW PRESSURE	UTIL	UTILITY
LPS	LOW PRESSURE SEWER	VAC	VACUUM
MH	MANHOLE	VERT	VERTICAL
ML	MATCH LINE	WLE	WATER LINE EXTENSION
M	METER	WM	WATER MAIN
		W	WEST

SYMBOL LEGEND

	RIGHT OF WAY LINE		45°, 22.5° OR 11.25° BEND
	PROPERTY LINE		SANITARY WYE CONNECTION
	BASELINE STATIONING		AIR RELEASE VALVE
	EXISTING 6" WATER MAIN		SLEEVE
	EXISTING 4" WATER MAIN		TEMPORARY SAMPLE POINT
	PROPOSED 8" WATER MAIN		EXISTING SANITARY SEWER MANHOLE
	EDGE OF PAVEMENT		CLEAN-OUT
	EXISTING OVERHEAD UTILITY LINE		EXISTING UTILITY POLE
	EXISTING UNDERGROUND TELEPHONE		EXISTING WATER SERVICE
	EXISTING FIRE HYDRANT		PROPOSED DOUBLE WATER SERVICE
	PROPOSED FIRE HYDRANT ASSEMBLY		PROPOSED SINGLE WATER SERVICE
	EXISTING WATER VALVE		EXISTING DRAINAGE PIPE
	EXISTING SEWER VALVE		BLOCK NUMBER
	PROPOSED GATE VALVE		LOT NUMBER
	PROPOSED PLUG VALVE		PARCEL ADDRESS
	PIPE CAP		EXISTING FENCE
	REDUCER		BLOW OFF
	TEE		WATER METER
	CROSS		
	90° BEND		

	ELECTRICAL BOX		PROPOSED DRAINAGE PIPE BY OTHERS
	TELEPHONE BOX		PROPOSED OPEN-CUT
	CABLE TV BOX		PROPOSED DIRECTIONAL BORE
	BENCH MARK		
	GROUND ELEVATION		
	IRON PIPE		
	IRON ROD		
	CONCRETE MONUMENT		
	IRON ROD WITH CAP		
	ALUMINUM DISK		
	GUY ANCHOR		
	SIGN		
	PROPOSED SIDEWALK BY OTHERS		



DESIGNED BY: DEC	DWN BY: DEC	CAD BY: BBC
DATE: 2021-11-17	S-T-R: S14, 09-16-1406-RZEE	PROJECT NO: 22-0001
DATE: 2021-11-17	SCALE: NTS	PLOT DATE: 2021-12-08 3:02 PM
FILE LOCATION: Z:\Auto Cad	FILE NAME: 22-0001	FILE TYPE: DWG
FILE LOCATION: Z:\Auto Cad	FILE NAME: 22-0001	FILE TYPE: DWG
FILE LOCATION: Z:\Auto Cad	FILE NAME: 22-0001	FILE TYPE: DWG
FILE LOCATION: Z:\Auto Cad	FILE NAME: 22-0001	FILE TYPE: DWG
FILE LOCATION: Z:\Auto Cad	FILE NAME: 22-0001	FILE TYPE: DWG
FILE LOCATION: Z:\Auto Cad	FILE NAME: 22-0001	FILE TYPE: DWG
FILE LOCATION: Z:\Auto Cad	FILE NAME: 22-0001	FILE TYPE: DWG
FILE LOCATION: Z:\Auto Cad	FILE NAME: 22-0001	FILE TYPE: DWG

CHARLOTTE COUNTY UTILITIES
ENGINEERING SERVICES DIVISION
25550 HARBOR VIEW RD.
PORT CHARLOTTE FL 33980
PH: 941-764-4516
PH: 941-764-4969

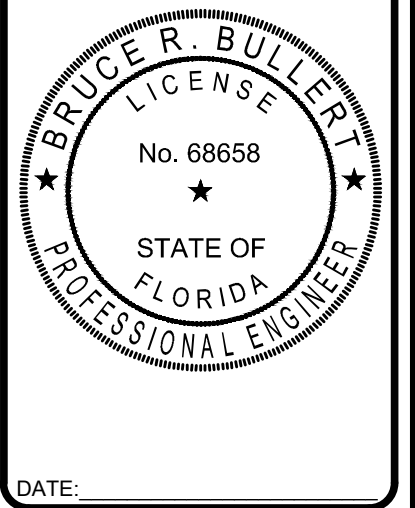

22-0001 DORCHESTER ST WM REPLACEMENT NOTES-LEGEND



CONSTRUCTION

DWG: Z:\Auto Cad R14\G04\BENT-PROJECTS\ACTIVE\2022\22-0001 Dorchester Water Main Replacement\CAD\Production Drawing\20-0001 NOTES-LEGEND.dwg
 DATE: Dec 08, 2021 3:02pm
 USER: cobd

DWG: Z:\Info Cor R\A\GIS\REG-PROJECTS\ACTIVE\2023\23-0001 Dorchester Sidewalk-Water Main Replacement\Drawings\23-0001 PLAN.dwg USER: cshd DATE: Dec 11, 2023 8:11am

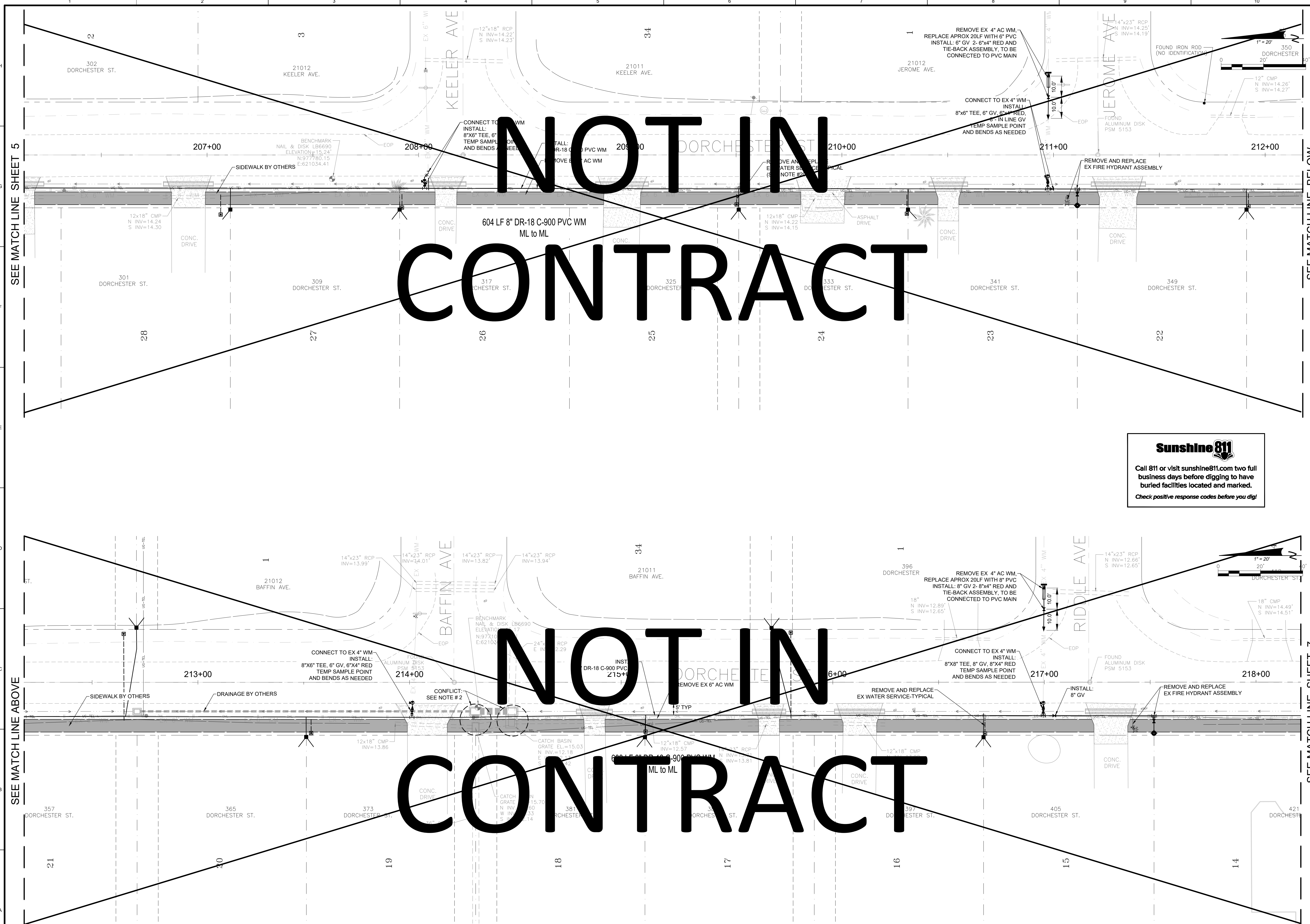

NOT IN CONTRACT

NOT IN CONTRACT

SEE MATCH LINE SHEET 5

SEE MATCH LINE BELOW

SEE MATCH LINE ABOVE

SEE MATCH LINE SHEET 7

Sunshine 811
 Call 811 or visit sunshine811.com two full business days before digging to have buried facilities located and marked.
 Check positive response codes before you dig!



DESIGNED BY: DEC	DRAWN BY: DEC	CHECKED BY: BBC
DATE: 2023-12-11	S.T.R. 804.09 - T.A.S. - R22-22-0001	PROJECT NO. 22-0001
DATE: 08/18	SCALE: 1" = 20'	PLOT DATE: 2023-12-11 8:11 AM
FILE LOCATION: Z:\Info Cor R\A\GIS\REG-PROJECTS\ACTIVE\2023\23-0001 Dorchester Sidewalk-Water Main Replacement\CAD\Production Drawings		
SIZE: ARCH full sheet D 36"X48" X 24.00		
FILE NUMBER 23-0001-PUN.dwg		
No. _____		
DESCRIPTION _____		
DATE _____		
BY _____		

CHARLOTTE COUNTY UTILITIES
 25550 HARBOR VIEW RD.
 PORT CHARLOTTE FL 33980
 PH: 941-764-4516
 FAX: 941-764-4969

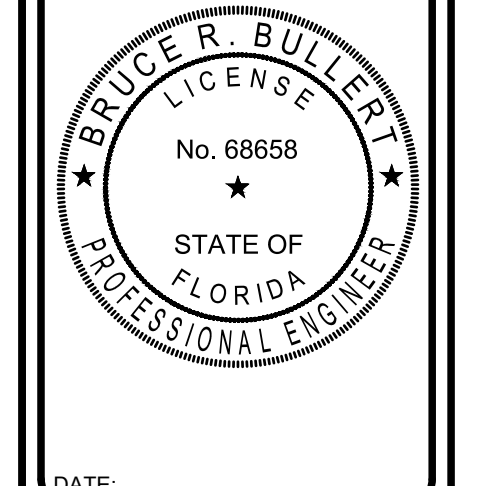

22-0001 DORCHESTER ST WM REPLACEMENT DORCHESTER ST PLAN-03

SHEET 6

CONSTRUCTION

DWG: Z:\Info Cor R\A\GIS\REG-PROJECTS\ACTIVE\2023\22-0001 Dorchester St\Water Main Replacement\Drawings\22-0001 PLAN.dwg
 USER: cad
 DATE: Dec 11, 2023 8:11am

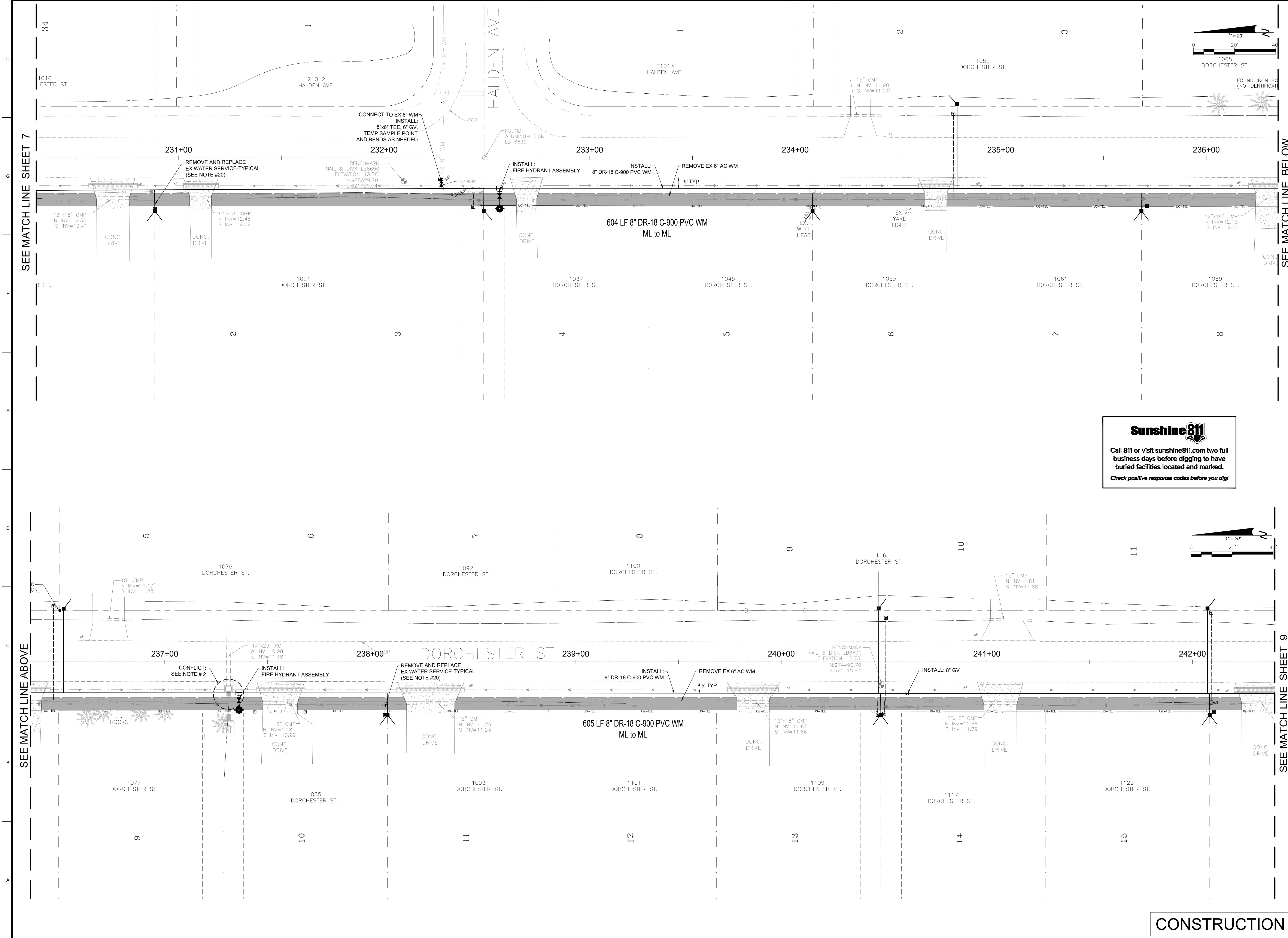

SEE MATCH LINE SHEET 7

SEE MATCH LINE ABOVE

SEE MATCH LINE BELOW

SEE MATCH LINE SHEET 9

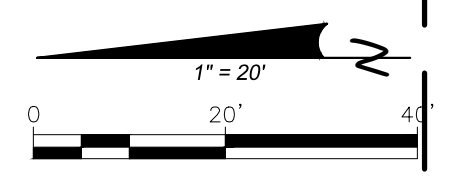
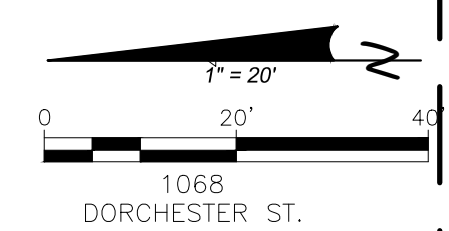

Sunshine 811

Call 811 or visit sunshine811.com two full business days before digging to have buried facilities located and marked.
 Check positive response codes before you dig!



NO.	DESCRIPTION	DATE	BY

DESIGNED BY: DEC	DRAWN BY: DEC	CHKD BY: BBC
DATE: 2023-12-11	S.T.R. S04.09 - T40S - R22-22-0001	PROJECT NO. 22-0001
DATE: 2023-12-11	SCALE: 1" = 20'	PLOT DATE: 2023-12-11 8:11 AM
DATE: 2023-12-11	SCALE: 1" = 20'	PLOT DATE: 2023-12-11 8:11 AM
FILE LOCATION: Z:\Info Cor R\A\GIS\REG-PROJECTS\ACTIVE\2023\22-0001 Dorchester St\Water Main Replacement\CAD\Production Drawings	FILE NUMBER: 22-0001	FILE NUMBER: 22-0001
SIZE: ARCH full sheet D	DATE: 12/11/2023	DATE: 12/11/2023

CHARLOTTE COUNTY UTILITIES
 25550 HARBOR VIEW RD.
 PORT CHARLOTTE FL 33980
 PH: 941-764-4516
 FAX: 941-764-4969

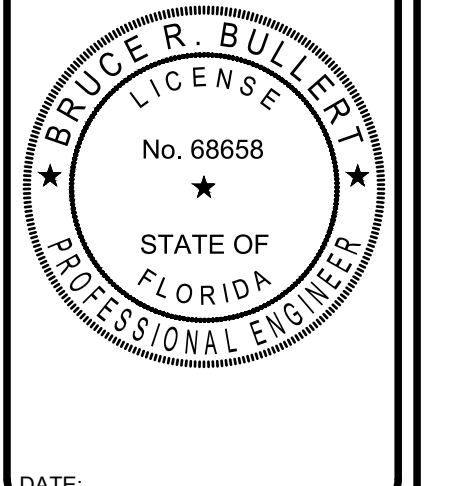

22-0001 DORCHESTER ST WM
 REPLACEMENT
 DORCHESTER ST
 PLAN-05

SHEET
 8

CONSTRUCTION

DWG: Z:\Info Cor R\A\GIS\REG-PROJECTS\ACTIVE\2023\03-0001 Dorchester Sidewalk-Water Main Replacement\GIS\Production Drawings\30-000X PLAN.dwg
 USER: cshd
 DATE: Dec 11, 2023 8:11am

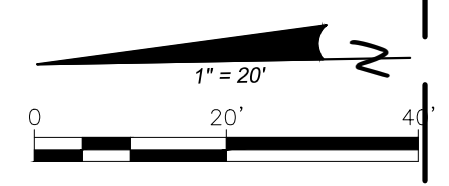
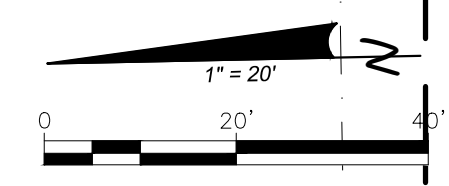
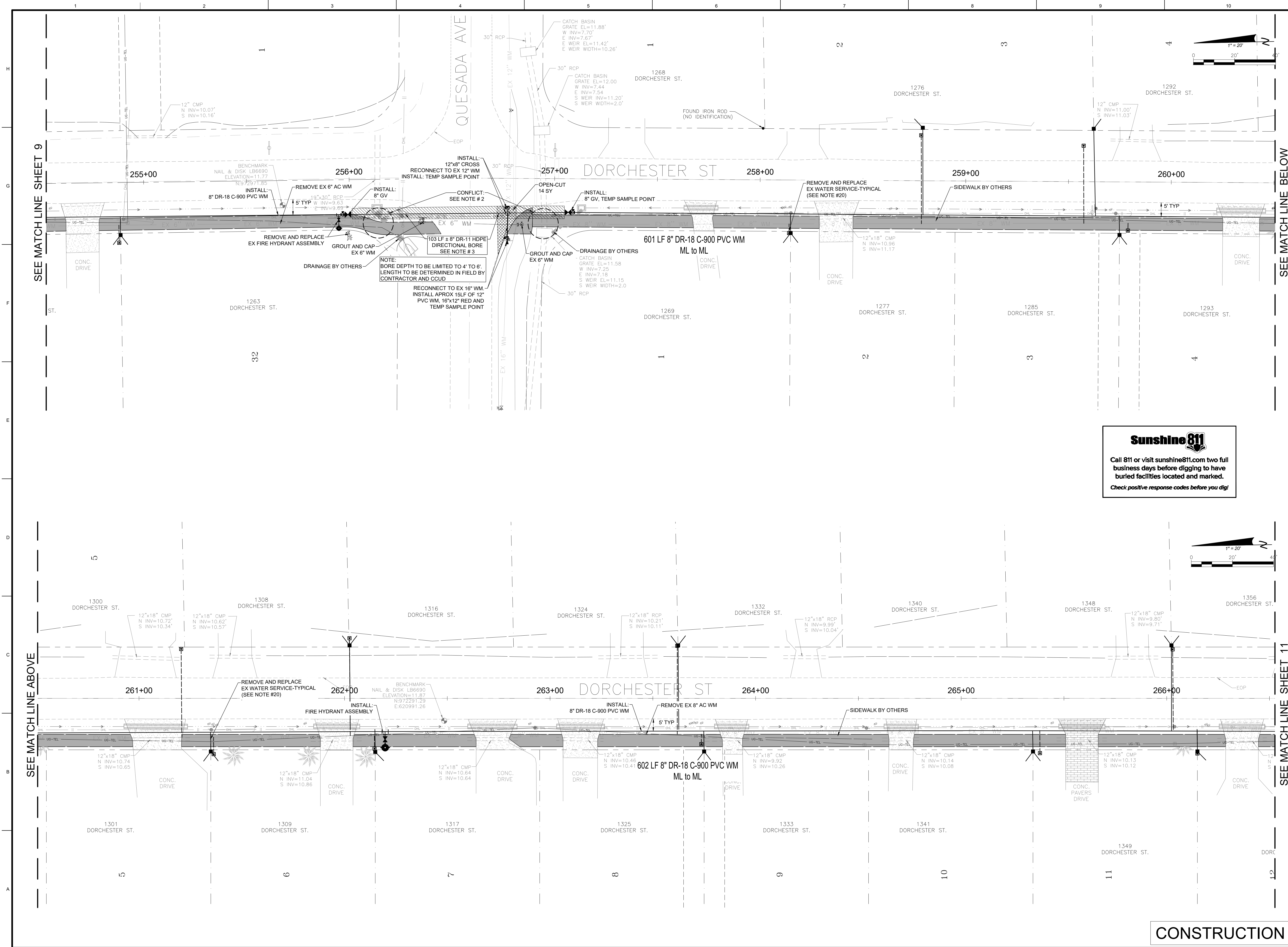

SEE MATCH LINE SHEET 9

SEE MATCH LINE BELOW

SEE MATCH LINE ABOVE

SEE MATCH LINE SHEET 11

Sunshine 811

Call 811 or visit sunshine811.com two full business days before digging to have buried facilities located and marked.
 Check positive response codes before you dig!

DESIGNED BY: DEC	DRAWN BY: DEC	CHK BY: BBC
DATE: 2023-12-11	S.T.R. S04.09 - T405 - R22-22-0001	PROJECT NO.
DATE: 2023-12-11	SCALE: 1" = 20'	PLAT DATE: 2023-12-11 8:11 AM
FILE LOCATION: Z:\Info Cor R\A\GIS\REG-PROJECTS\ACTIVE\2023\03-0001 Dorchester Sidewalk-Water Main Replacement\GIS\Production Drawings	FILE NUMBER	DESCRIPTION
SIZE: ARCH full sheet D (8.50 x 24.00)	20-000X PLAN.dwg	

CHARLOTTE COUNTY UTILITIES
 25550 HARBOR VIEW RD.
 PORT CHARLOTTE FL 33980
 PH: 941-764-4516
 FAX: 941-764-4969

BRUCE R. BULLER
 LICENSE
 No. 68658
 STATE OF FLORIDA
 PROFESSIONAL ENGINEER

22-0001 DORCHESTER ST WM REPLACEMENT DORCHESTER ST PLAN-07

CONSTRUCTION

DWG: Z:\Info Cor R\A\GIS\BID\PROJECTS\ACTIVE\2022\22-0001 Dorchester Sidelink-Water Main Replacement\CAD\Production Drawings\22-0001 PLAN.dwg USER: cadw DATE: Dec 11, 2023 8:11am

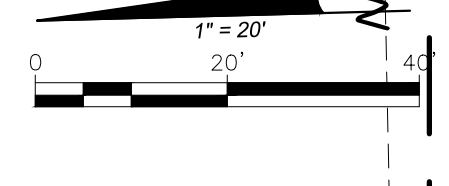
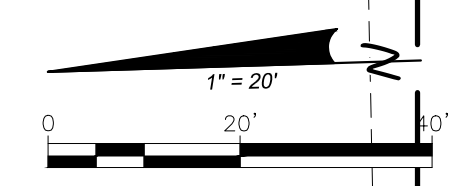
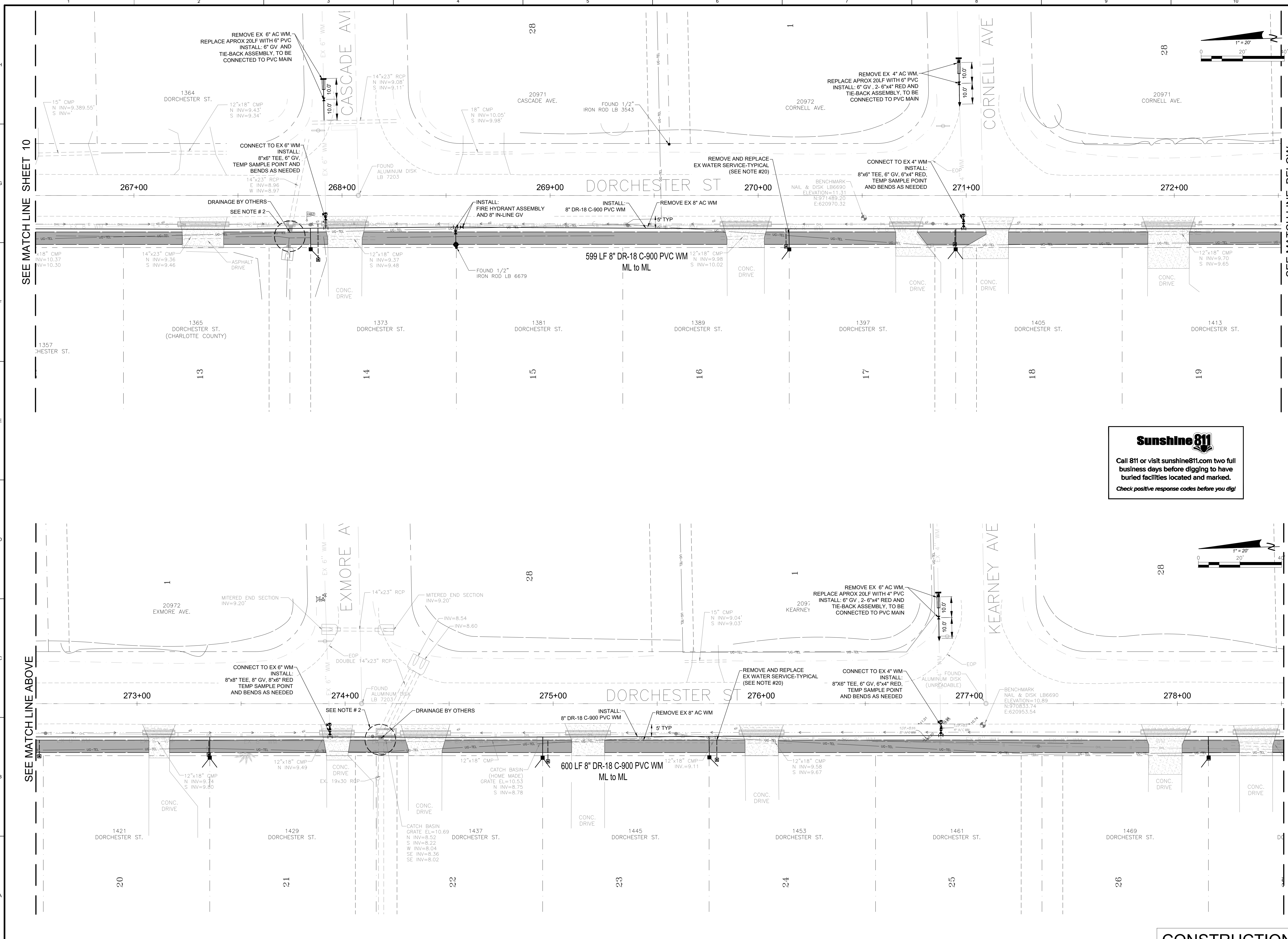

Sunshine 811

Call 811 or visit sunshine811.com two full business days before digging to have buried facilities located and marked.
Check positive response codes before you dig!



DESIGNED BY: DEC	DRAWN BY: DEC	CAD BY: BBC
DATE: 2023-12-11	S:TR S04.09 - T405 - R22-22-0001	PROJECT NO: 2023-12-11 8:11 AM
DRAWN: 0188	SCALE: 1" = 20'	PLOT DATE:
FILE LOCATION: Z:\Info Cor R\A\GIS\BID\PROJECTS\ACTIVE\2022\22-0001 Dorchester Sidelink-Water Main Replacement\CAD\Production Drawings		
FILE NUMBER: 22-0001		
SIZE: ARCH (ut) sheet D (8) 24 x 36		

CHARLOTTE COUNTY UTILITIES
25550 HARBOR VIEW RD.
PORT CHARLOTTE FL 33980
PH: 941-764-4516
FAX: 941-764-4969

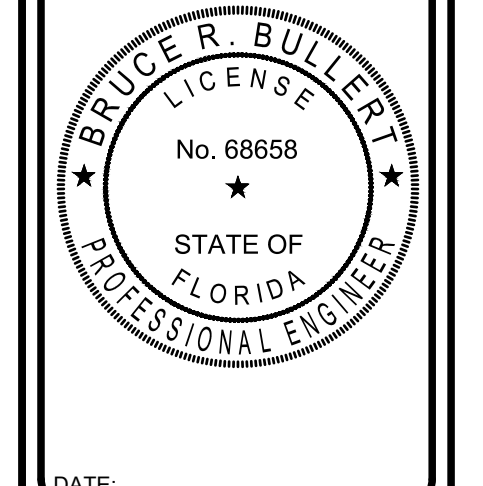

22-0001 DORCHESTER ST WM REPLACEMENT DORCHESTER ST PLAN-08

CONSTRUCTION

DWG: Z:\Info Cor R\A\GIS\REDESIGN-PROJECTS\ACTIVE\2023\22-0001 Dorchester Sewer-Water Main Replacement\GIS\Production Drawings\22-0001 PLAN.dwg USER: cshd DATE: Dec 11, 2023 8:12am

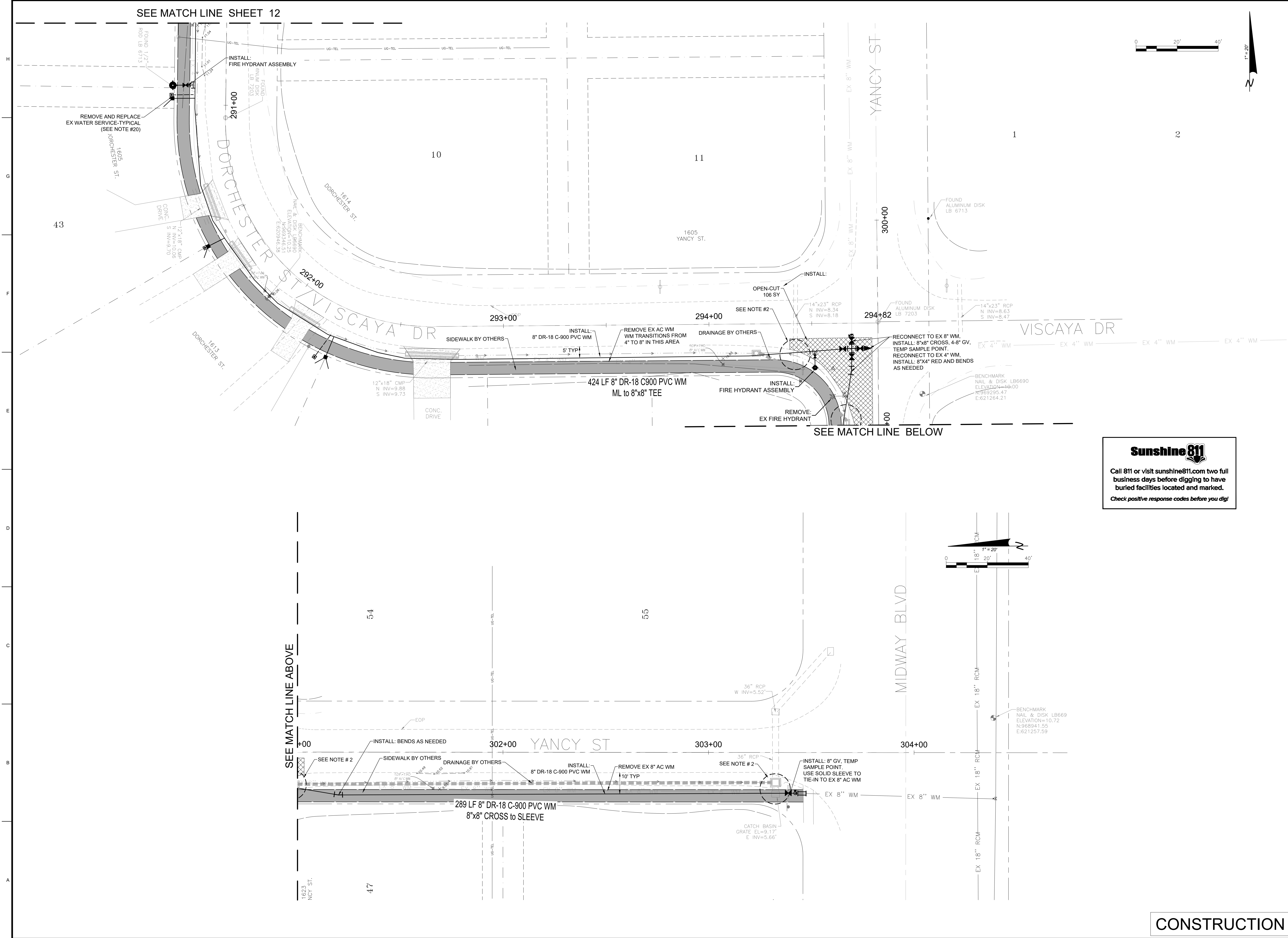

SEE MATCH LINE SHEET 12

SEE MATCH LINE BELOW

SEE MATCH LINE ABOVE



Sunshine 811
 Call 811 or visit sunshine811.com two full business days before digging to have buried facilities located and marked.
 Check positive response codes before you dig!



No.	DESCRIPTION	DATE	BY

DESIGNED BY: DEC	DRAWN BY: DEC	CHKD BY: BGC
DATE: 2023-12-11	S.T.R.	PROJECT NO. S04.09 - TMS - R22-22-0001
DATE: 2023-12-11	SCALE: 1" = 20'	PLOT DATE: 2023-12-11 8:12 AM
FILE LOCATION: Z:\Info Cor R\A\GIS\REDESIGN-PROJECTS\ACTIVE\2023\22-0001 Dorchester Sewer-Water Main Replacement\GIS\Production Drawings	FILE NUMBER: 22-0001	FILE NUMBER: 22-0001
SIZE: ARCH full bleed D	SCALE: 1" = 20'	SCALE: 1" = 20'
DATE: 2023-12-11	DATE: 2023-12-11	DATE: 2023-12-11

CHARLOTTE COUNTY UTILITIES
 25550 HARBOR VIEW RD.
 PORT CHARLOTTE FL 33980
 PH: 941-764-4516
 FAX: 941-764-4969

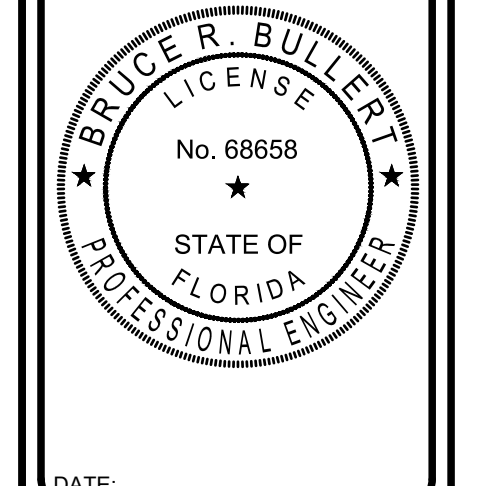

22-0001 DORCHESTER ST WM REPLACEMENT
 DORCHESTER ST @ YANCY ST
 PLAN-10

SHEET
 13

CONSTRUCTION