

CHARLOTTE COUNTY  
PUBLIC WORKS DEPARTMENT

CONTRACT PLANS

VETERANS BLVD. AT NORMAN ST.

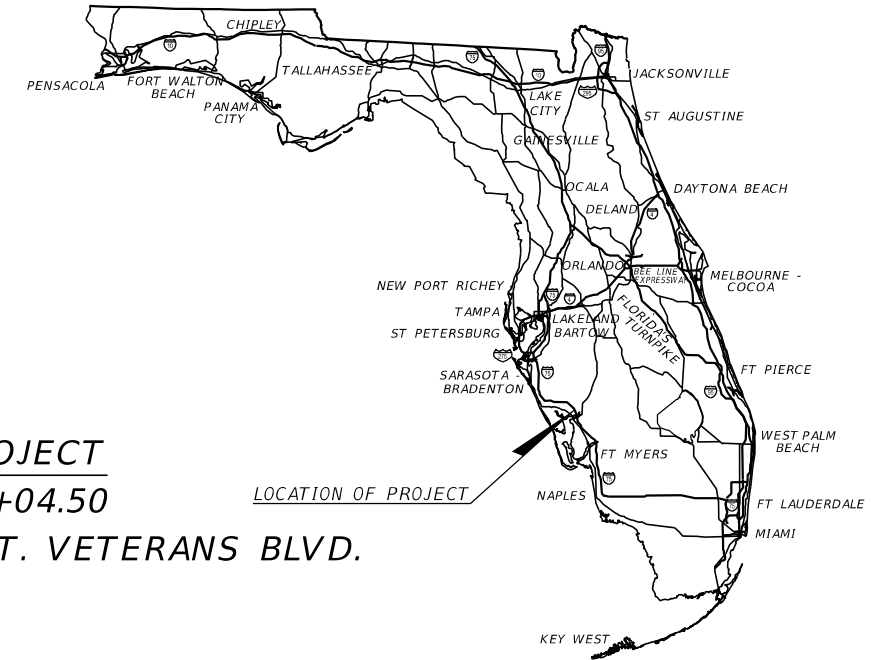

**INDEX OF ROADWAY PLANS**

SHEET NO.	SHEET DESCRIPTION
1	KEY SHEET
2	SIGNATURE SHEET
3	TYPICAL SECTION
4	SUMMARY OF DRAINAGE STRUCTURES
5 - 6	GENERAL NOTES
7 - 8	ROADWAY PLAN
9 - 10	GRADING PLAN
11	DRAINAGE STRUCTURES
12 - 15	CROSS SECTIONS
16 - 17	EROSION CONTROL PLAN
18	TEMPORARY TRAFFIC CONTROL PLAN
19 - 20	SUMMARY OF VERIFIED UTILITIES
21 - 22	UTILITY ADJUSTMENTS
23	SIGNING AND PAVEMENT MARKING PLAN
24 - 25	ITS PLAN
26	POLE DATA & LEGEND
27	LIGHTING PLAN
28	CHARLOTTE COUNTY OPEN TRENCH DETAIL

**BEGIN PROJECT**

**STA. 53+90.00**

**Q CONST. VETERANS BLVD.**

**END PROJECT**

**STA. 60+04.50**

**Q CONST. VETERANS BLVD.**



**ROADWAY PLANS**

**ENGINEER OF RECORD:**

KRIS KARANXHA, P.E.  
P.E. LICENSE NUMBER 92368  
FLORIDA TRANSPORTATION ENGINEERING, INC.  
12550 TELECOM DRIVE  
TEMPLE TERRACE, FLORIDA 33637  
(813) 989 - 0729, EXT. 120  
CONTRACT NO.: 2019000297  
VENDOR NO.: F65-0183924

**CHARLOTTE COUNTY PUBLIC WORKS DIRECTOR:**

JOHN ELIAS

**CHARLOTTE COUNTY COUNTY ENGINEER:**

JOANNE VERNON, P.E.

**CHARLOTTE COUNTY PROJECT MANAGER:**

JEFF KEYSER

**CHARLOTTE COUNTY BOARD OF COMMISSIONERS**

DISTRICT 1: KEN DOHERTY

DISTRICT 2: CHRISTOPHER CONSTANCE

DISTRICT 3: BILL TRUEX

DISTRICT 4: STEPHEN R. DEUTSCH

DISTRICT 5: JOE TISEO

SHEET  
NO.

1





**SUMMARY OF DRAINAGE STRUCTURES**

QUANTITY	STR. NO.	STATION	SIDE	DESCRIPTION	BARRELS	STRAIGHT CONCRETE ENDWALLS	WINGED CONCRETE ENDWALLS	STORM/CROSS DRAIN		CURB INLETS		MANHOLES	REMARKS	
						ROUND	ELLIPTICAL	ROUND	ELLIPTICAL	P-5	P-6	J-8		
						24"	29"x45"	18"	24"	29"x45"	<10'	<10'		
P	S-1	56+27.00	RT.	CURB INLET, PIPE	1			12			1		CONCRETE COLLAR INDEX 430-001. REMOVE EXISTING INLET	
F														
P	S-2	56+27.00	RT.	STRAIGHT CONCRETE ENDWALLS, 24", SINGLE, 0 DEGREES, ROUND, PIPE	1	1			18				REMOVE EXISTING MES	
F														
P	S-3	58+00.00	RT.	CURB INLET	1					1				
F														
P	S-4	58+00.00	RT.	STRAIGHT CONCRETE ENDWALLS, 24", SINGLE, 0 DEGREES, ROUND, PIPE	1	1			20					
F														
P	S-5	101+26.00	RT.	WINGED CONCRETE ENDWALLS, U-TYPE INDEX 430-040, 29"x45", PIPE	1		1			22			REMOVE EXISTING MES	
F														
P	S-6	101+26.00	RT.	MANHOLES, J-8								1	CONNECT EXISTING PIPE TO NEW MANHOLE	
F														
GRAND TOTALS				PLAN QUANTITY		2	1	12'	38'	22'	1	1	1	
				FINAL QUANTITY										

10/15/2025 4:13:26 PM MaxwellNg Z:\Projects\FDOT\Veterans at Norman\Drainage\SUMDRD01.dgn

THE OFFICIAL RECORD OF THIS SHEET IS THE ELECTRONIC FILE DIGITALLY SIGNED AND SEALED UNDER RULE 61G15-23.004, F.A.C.

REVISIONS				ENGINEER OF RECORD				CHARLOTTE COUNTY PUBLIC WORKS DEPARTMENT	SUMMARY OF DRAINAGE STRUCTURES	SHEET NO.
DATE	DESCRIPTION	DATE	DESCRIPTION	LUIS ALFREDO CELY, P.E. LICENSE NUMBER 70653 ALFKA, LLC. 400 N. TAMPA STREET, STE 1440 TAMPA, FLORIDA 33602						4

**GENERAL NOTES**

1. ALL BENCHMARK ELEVATIONS SHOWN ON THE PLANS ARE NORTH AMERICAN VERTICAL DATUM OF 1988 (NAVD 88). EXISTING AND PROPOSED ELEVATIONS SHOWN ARE BASED ON NORTH AMERICAN VERTICAL DATUM OF 1988 (NAVD 88).
2. CONTACT CHARLOTTE COUNTY UTILITY DEPARTMENT 48 HOURS PRIOR TO CONSTRUCTION.
3. ALL WORK AND MATERIALS FOR THE PROJECT SHALL CONFORM TO CURRENT CHARLOTTE COUNTY SPECIFICATIONS.
4. EXISTING FACILITIES SHALL BE RESTORED TO A CONDITION EQUIVALENT OR BETTER TO THAT WHICH EXISTED PRIOR TO COMMENCING CONSTRUCTION, AT NO ADDITIONAL COST TO THE OWNER.
5. ANY LAND DISTURBED BY CONSTRUCTION SHALL BE SODDED. USE ARGENTINE BAHIA OR LIKE KIND AND CONFORM TO FDOT SPECIFICATION SECTION 570 AND STANDARD PLANS INDEX 570-010. SOD ALONG EDGES OF PAVEMENT OF ALL ROADS, SIDEWALKS, AND/OR CURB SHALL BE 1 INCH BELOW FINISHED PAVEMENT GRADE.
6. USE EXTREME CARE NOT TO DAMAGE THE ROOT SYSTEMS OF TREES AND OTHER LANDSCAPE FEATURES WHICH ARE TO REMAIN. NO EQUIPMENT, SUPPLIES, OR VEHICLES SHALL BE STORED WITHIN THE DRIP LINE OF TREES TO REMAIN.
7. ADJUST ALL VALVE BOXES, MANHOLE RIMS, GRATES, ETC. AS NECESSARY TO MATCH PROPOSED GRADES.
8. CONCRETE SIDEWALKS SHALL BE CONSTRUCTED PER FDOT INDEX NO. 522-001 (FY 2024-25) AND FDOT STANDARD SPECIFICATION NO. 522 EXCEPT FOR CURB CUT RUNS WHICH SHALL BE FINISHED IN ACCORDANCE WITH INDEX NO. 522-002 EXCEPT AMENDMENTS TO DESIGN PER CHARLOTTE COUNTY PUBLIC WORKS - ENGINEERING DIVISION. CLASS I CONCRETE, 3,000 PSI @ 28 DAYS SHALL BE USED FOR ALL SIDEWALKS AND CONCRETE STRUCTURES, SIDEWALKS TO RECEIVE FIBERMESH REINFORCING.
9. ANY IMPACT TO THE 24" WATER MAIN WILL HAVE SERIOUS CONSEQUENCES. THIS LINE IS A MAIN FEED FOR MOST OF CHARLOTTE COUNTY AND DUE CARE SHALL BE EXERCISED WHEN EXCAVATING IN THE AREA.

**DRAINAGE NOTES:**

1. ALL CONCRETE PIPE SHALL BE REINFORCED WITH STEEL. PIPE LENGTH SHOWN IS CENTER OF STRUCTURE TO CENTER OF STRUCTURE AND OUTLET ENDS OF MITERED END SECTIONS AND FLARED END SECTIONS.
2. ALL CONCRETE BOX CULVERTS AND REINFORCED CONCRETE PIPE JOINTS (BOTH ROUND AND ELLIPTICAL PIPE) SHALL BE WRAPPED WITH GEOTEXTILE MATERIAL (MIRAFI, OR EQUAL). THE FABRIC SHALL COMPLETELY ENCIRCLE THE JOINT AND BE OVERLAPPED 2-1/2 FEET, AND EXTENDED 2-1/2 FEET BOTH SIDES OF THE JOINT. ALL FABRIC TO BE SECURED WITH AN APPROVED MASTIC DESIGNED FOR THIS PURPOSE.
3. THE STORM DRAINAGE PIPING AND FILTRATION SYSTEM SHALL BE SUBJECT TO A VISUAL INSPECTION BY THE OWNER'S ENGINEER PRIOR TO THE PLACEMENT OF BACKFILL. NOTIFY THE ENGINEER 48 HOURS IN ADVANCE TO SCHEDULE INSPECTION.
4. MAINTAIN THE STORM DRAINAGE SYSTEM UNTIL THE FINAL ACCEPTANCE OF THE PROJECT. THE STORM SYSTEM WILL BE INSPECTED BY THE OWNER'S ENGINEER PRIOR TO FINAL ACCEPTANCE.

**ORDINANCE 85-43 NOTE:**

1. ORDINANCE 85-43 REQUIRES A STATEMENT WHETHER PROPOSED SWALE GRADES ARE CONSISTENT WITH ORIGINAL DRAINAGE PLANS.
2. THE PROPOSED GRADES ON THESE PLANS ARE CONSISTENT WITH THE ORIGINAL GRADES. THE ONLY MINOR MODIFICATION IS THAT THE FLOWLINE LOCATIONS ADJACENT TO THE PROPOSED ROADWAY ALIGNMENT AND WIDENING HAVE BEEN ADJUSTED. UPSTREAM SWALES OUTSIDE THE PROJECT AREA ARE NOT ALTERED, NO ADVERSE IMPACT FROM THIS ROADWAY PROJECT IS FORESEEN. ENGINEER DOES NOT MAKE ANY STATEMENT AS TO NON R/W DRAINAGE PATTERNS BEYOND THE EXTENT OF THE SURVEY AND PROJECT AREA.

**ROADWAY PAY ITEMS NOTES :**

536-1-1:  
INCLUDE GUARDRAIL AND 9" CONCRETE PAVEMENT AS INDICATED IN THE PLANS AND ROADWAY AND TRAFFIC DESIGN STANDARDS. PROVIDE CONCRETE BASE UNDER THE SPECIAL STEEL POST AS PER FDOT INDEX 536-001 SHEET 24 OF 25. ALSO COST INCLUDE THE GUARDRAIL AND CONSTRUCTION OF 9" THICK CONCRETE.

HORIZONTAL & VERTICAL CONTROL TABLE						
POINT	STATION	OFFSET	NORTHING	EASTING	ELEVATION	DESCRIPTION
MT 22			980849.79	633402.32	22.99	WHITE CHEVRON - MOBILE TARGET
MT 23			980688.19	633421.72	22.12	WHITE CHEVRON - MOBILE TARGET
MT 24	53+13.80	39.34' RT	980773.98	633770.64	22.44	WHITE CHEVRON - MOBILE TARGET
MT 25	58+04.15	36.16' LT	980847.36	634106.90	23.36	WHITE CHEVRON - MOBILE TARGET
MT 26	59+26.21	40.45' RT	980674.98	634021.94	22.20	WHITE CHEVRON - MOBILE TARGET
TR 1	58+35.37	175.90' RT	980807.61	635232.29	24.53	TRAVERSE POINT
TR 2			980849.79	636227.66	23.41	TRAVERSE POINT

10/15/2025 4:13:27 PM Maxwelling Z:\Projects\DOT\Veterans at Norman\Roadway\GNWTRD01.dgn

THE OFFICIAL RECORD OF THIS SHEET IS THE ELECTRONIC FILE DIGITALLY SIGNED AND SEALED UNDER RULE 61G15-23.004, F.A.C.

REVISIONS			ENGINEER OF RECORD		CHARLOTTE COUNTY PUBLIC WORKS DEPARTMENT	GENERAL NOTES (1)	SHEET NO.
DATE	DESCRIPTION	DATE	DESCRIPTION	5			
				KRIS KARANXHA, P.E. LICENSE NUMBER 92368 FLORIDA TRANSPORTATION ENGINEERING, INC. 12550 TELECOM DRIVE TEMPLE TERRACE, FLORIDA 33637			

**SIGNING AND PAVEMENT MARKING NOTES**

1. ALL PROPOSED PAVEMENT MARKING SHALL MATCH WITH EXISTING PAVEMENT MARKINGS AT THE ENDS OF THE MILLING AND RESURFACING LIMITS.
2. ALL MARKINGS SHALL BE PAINT, NO THERMOPLASTIC.
3. PERMANENT RPM'S AS REQUIRED FOR MAINLINE EDGE, CENTER, AND LANE LINES SHALL BE PLACED WITHIN 72 HOURS OF COMPLETION OF THE MAINLINE SURFACE COURSE. OTHER LOCATIONS FOR RPM'S PLACEMENT MAY BE DESIGNATED BY THE COUNTY.

**LIGHTING NOTES**

1. REFER TO STANDARD PLANS INDEX 715-002 FOR USE OF STANDARD CONCRETE FOUNDATIONS.
2. ANY DAMAGED PORTIONS OF POLES, FIXTURES AND BRACKET ARMS WILL BE REJECTED.
3. ALL CONDUITS THAT WILL REMAIN EMPTY SHALL BE MANDREL TESTED, CLEANED INSIDE AND BOTH ENDS CAPPED. LEAVE THE CORROSION RESISTANT PULL WIRE AND PLACE PULL BOXES TO MARK THE LOCATION OF THE ENDS OF THE CONDUITS.
4. ALL MATERIAL, UNLESS OTHERWISE SPECIFIED, SHALL BE UNDERWRITERS LABORATORY (UL APPROVED).
5. PULL BOXES SHALL MEET CHARLOTTE COUNTY STANDARDS.
6. ALL PULL BOXES FOR ROADWAY LIGHTING SHALL HAVE STAMPED COVERS LABELED "STREET LIGHTING".
7. INSTALLATION OF LIGHTING POLES AND CIRCUITS SHALL BE IN ACCORDANCE WITH THE FDOT STANDARD PLANS-FY 2024-25, INDEX 715-001, AND THE LATEST NATIONAL ELECTRIC CODE. ALL COMPONENTS SHALL BE PROPERLY GROUNDED AND BONDED PER N.E.C. AND N.E.S.C. CODE AND CURRENT EDITION OF THE CHARLOTTE COUNTY LIGHTING DISTRICT SUPPLEMENTAL SPECIFICATIONS.
8. FOUR COPIES OF SHOP DRAWINGS AND DESIGN DATA SHALL BE SUBMITTED TO THE ENGINEER OF RECORD WITH A COPY OF THE SUBMITTAL LETTER SENT TO CHARLOTTE COUNTY PUBLIC WORKS, PROJECT MANAGER. A COPY OF SHOP DRAWINGS SHALL BE SENT TO CHARLOTTE COUNTY FOR REVIEW AND APPROVAL. ALLOW A 30 DAY TURNAROUND FOR SUBMITTALS.
9. LIGHTING CONTRACTOR MUST FOLLOW ALL OSHA RULES AND REGULATIONS WHEN WORKING IN THE VICINITY OF ENERGIZED FPL HIGH VOLTAGE ELECTRIC LINES. AT NO TIME SHOULD ANY PERSONNEL OR EQUIPMENT BE CLOSER THAN 16 FEET TO ENERGIZED LINES.
10. NOTIFY FPL AT LEAST 48 HOURS PRIOR TO ANY INSTALLATION THAT IS WITHIN 20 FEET OF ENERGIZED ELECTRICAL CONDUCTORS. FPL, AT ITS OPTION, SHALL ASSIST THE CONTRACTOR TO COVER UP ENERGIZED CONDUCTORS AT INSTALLATION SITE OR TAKE OTHER ACTION AT ALL TIMES IN PERFORMANCE OF WORK AROUND ANY PRIMARY, HIGH VOLTAGE COMPONENTS.
11. PULLING INSTRUCTIONS: CONNECT PULLING DEVICES TO COPPER WIRE AND NOT TO JACKET AND MEET MANUFACTURER'S REQUIREMENTS. ALL BENDS SHALL BE NOT LESS THAN RECOMMENDED BY N.E.C. OR N.E.S.C. FOR CABLES USED.
12. STAKE ALL POLE LOCATIONS AND REQUEST UTILITY COMPANIES TO LOCATE AND STAKE UNDERGROUND UTILITIES PRIOR TO DRILLING.
13. MINIMUM DEPTH OF COVER FOR LIGHTING CONDUIT SHALL BE 36".
14. INSTALL SURGE PROTECTIVE DEVICES, PROPERLY GROUNDED IN POWER (SECONDARY) ENTRANCES.
15. WHENEVER POSSIBLE ALL CONDUITS UNDER ROADWAY AND SIDEWALK SHALL BE INSTALLED PRIOR TO INSTALLATION OF THE ROADWAY BASE AND SURFACE. NO OPEN CUT OF FINAL PAVEMENT SURFACES SHALL BE ALLOWED.
16. CONSTRUCT DIRECTIONAL BORE CONDUIT AND TERMINATE INTO SEPARATE PULL BOXES.
17. AT LOCATIONS WHERE UNDERGROUND UTILITIES ARE WITHIN 4 FEET OF THE LIGHT POLE FOUNDATIONS OR CONDUIT RUN, AS DETERMINED BY THE ENGINEER, INVESTIGATE FOUNDATION OR CONDUIT RUN BY HAND DIGGING.
18. ALL CONDUIT TRENCHES SHALL BE BACKFILLED COMPLETELY TO PROVIDE SAFE CROSSING BY THE END OF EACH WORKING DAY OR WHENEVER THE WORK ZONE BECOMES INACTIVE. DO NOT OPEN ANY AREA THAT CANNOT BE BACKFILLED IN THE SAME DAY/NIGHT OPERATION.
19. ANY EXCESS DIRT AND DEBRIS RESULTING FROM INSTALLATION OF POLE FOUNDATION, TRENCHING OR DIRECTIONAL DRILLING SHALL BE REMOVED DAILY TO AREAS APPROVED BY THE ENGINEER.
20. THERE SHALL BE NO SPLICES MADE IN PULL BOXES UNLESS AUTHORIZED BY CHARLOTTE COUNTY LIGHTING DISTRICT.
21. PULL BOX SPLICING MUST BE APPROVED BY THE CHARLOTTE COUNTY LIGHTING DISTRICT. CONTACT JODY MANSELL AT 941-575-3648 OR JODY.MANSELL@CHARLOTTECOUNTYFL.GOV FOR AUTHORIZATION.

22. ALL STREET LIGHT PULL BOXES SHALL HAVE A CONCRETE MOW PAD INSTALLED OR PLACED IN SIDEWALK.
23. ALL CURRENT CARRYING CONDUCTORS SHALL HAVE BLACK AND WHITE THHN/THWN INSULATION RATED AT 600 VOLTS. ALL GROUNDED CONDUCTORS SHALL HAVE WHITE CONTINUOUS THHN/THWN INSULATION RATED AT 600 VOLTS. ALL GROUNDING CONDUCTORS SHALL HAVE CONTINUOUS GREEN THHN/THWN INSULATION RATED AT 600 VOLTS.
24. CONDUCTORS SHALL BE INSTALLED WITH SUFFICIENT SLACK AT THE BASE OF THE POLE TO ALLOW WIRES AND CONNECTIONS TO BE PULLED OUTSIDE THE TRANSFORMER BASE HOUSING.
25. CONNECT PULL BOX TO LIGHT POLE FOUNDATION BY MEANS OF TWO 2" CONDUITS.
26. AT EACH LIGHT POLE CONNECT PULL BOX TO LIGHT POLE FOUNDATION BY MEANS OF TWO 2" PVC CONDUITS.
27. ALL NON-ELECTRICAL THREADED HARDWARE, ALL MECHANICAL ELECTRICAL CONNECTIONS AND ANY THREADED COMPONENT REQUIRING ASSEMBLY SHALL BE COATED WITH IDEAL NOALOX ANTI-OXIDANT COMPOUND.

**LIGHTING PAY ITEM NOTES:**

630-2-11: INCLUDE CONDUIT, ELBOWS, SWEEPS, CONNECTING HARDWARE, TRENCHING AND BACKFILL AS INDICATED IN THE PLANS AND THE ROADWAY AND TRAFFIC DESIGN STANDARDS. THE LINEAR FDOT PRICE FOR CONDUIT SHALL ALSO INCLUDE THE COST OF RESTORING CUT PAVEMENT, SIDEWALKS, SOD AND ETC., TO ITS ORIGINAL CONDITION.

635-2-11 INCLUDES THE PULL BOX AND COVER AS PER THE PLANS AND STANDARD INDEXES. LABEL "STREET LIGHTING" FOR POWER- CONVENTIONAL POLE CABLE DISTRIBUTION SYSTEM AT EACH POLE WILL NOT BE USED ON THIS PROJECT. PROVIDE CONCRETE BASE AROUND ALL PULL BOXES PER FDOT INDEX 715-001 SHEET 2 OF 3. PULL BOXES SHALL BE QUAZITE BRAND. STREET LIGHT PULL BOXES SHOULD BE NOMINAL 24" LONG BY 13" WIDE.

715-1-12: INCLUDES CONDUCTORS AS INDICATED IN THE PLANS AND THE ROADWAY AND TRAFFIC DESIGN STANDARDS. PAYMENT SHALL BE MADE BASED ON LINEAR FEET OF SINGLE CONDUCTOR.

715-61-300: INCLUDE THE POLE, LUMINAIRE WITH LED BOARDS, ANCHOR BOLTS WITH LOCK NUTS AND WASHERS, FRANGIBLE T-BASE, CONCRETE FOUNDATION, SURGE PROTECTOR (DITEK DL480), FUSE HOLDERS, AND #10 STRANDED COPPER RISERS AS INDICATED IN THE FDOT STANDARD PLANS FOR ROAD AND BRIDGE CONSTRUCTION AND CHARLOTTE COUNTY SPECIFICATIONS - CURRENT EDITION.

**ITS NOTES**

1. OBTAIN PRIOR AUTHORIZATION FOR MODIFICATION TO CHARLOTTE COUNTY IT FIBER. ALL FIBER IS TO BE COMPLETED AFTER NORMAL WORKING HOURS.

10/15/2025 4:13:27 PM Maxwelling Z:\Projects\DOT\Veterans at Norman\Roadway\GNWTRD01.dgn

THE OFFICIAL RECORD OF THIS SHEET IS THE ELECTRONIC FILE DIGITALLY SIGNED AND SEALED UNDER RULE 61G15-23.004, F.A.C.

REVISIONS		ENGINEER OF RECORD		SHEET NO.
DATE	DESCRIPTION	DATE	DESCRIPTION	
			OLIVER REMY RODRIGUES, P.E., P.T.O.E. LICENSE NUMBER 50646 FLORIDA TRANSPORTATION ENGINEERING, INC. 12550 TELECOM DRIVE TEMPLE TERRACE, FLORIDA 33637	6



CHARLOTTE COUNTY  
PUBLIC WORKS DEPARTMENT

GENERAL NOTES (2)

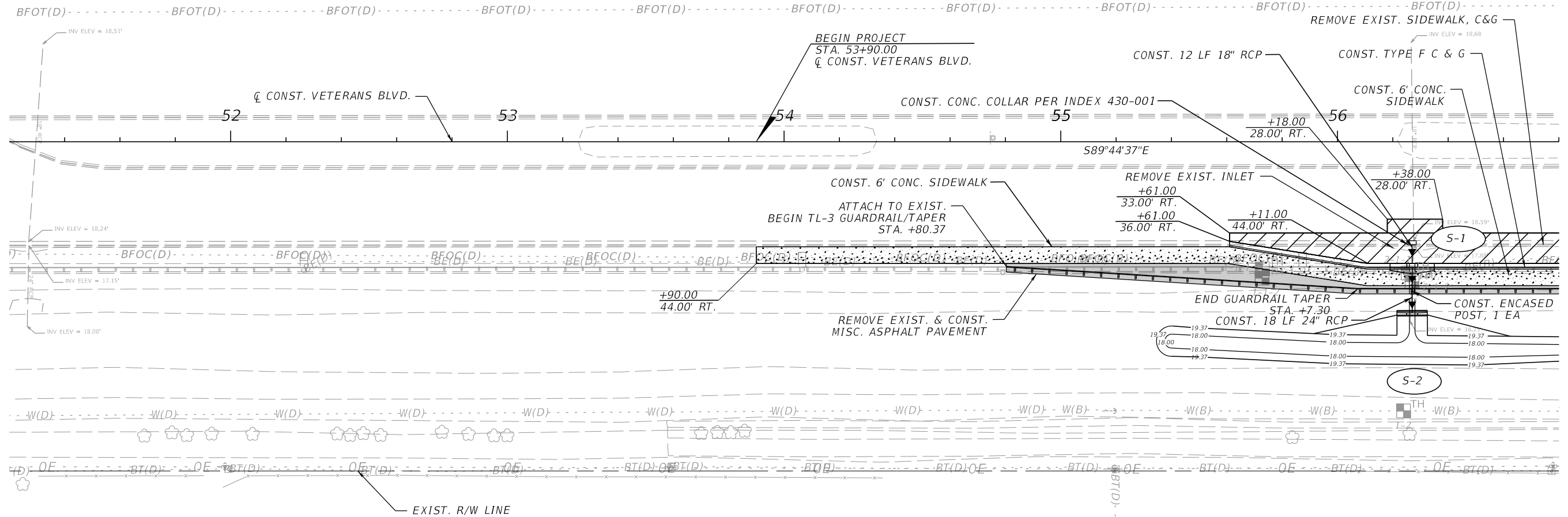
VETERANS BLVD.



LEGEND

-  WIDENING
-  4" THICK CONCRETE SIDEWALK
-  2" MISCELLANEOUS ASPHALT PAVEMENT

REVISIONS				ENGINEER OF RECORD		CHARLOTTE COUNTY PUBLIC WORKS DEPARTMENT	ROADWAY PLAN (1)		SHEET NO.
DATE	DESCRIPTION	DATE	DESCRIPTION	KRIS KARANXHA, P.E. LICENSE NUMBER 92368 FLORIDA TRANSPORTATION ENGINEERING, INC. 12550 TELECOM DRIVE TEMPLE TERRACE, FLORIDA 33637					7

10/16/2025 4:17:48 PM CarryCorrales Z:\Projects\DOT\Veterans at Norman\Roadway\PLANRD01.dgn



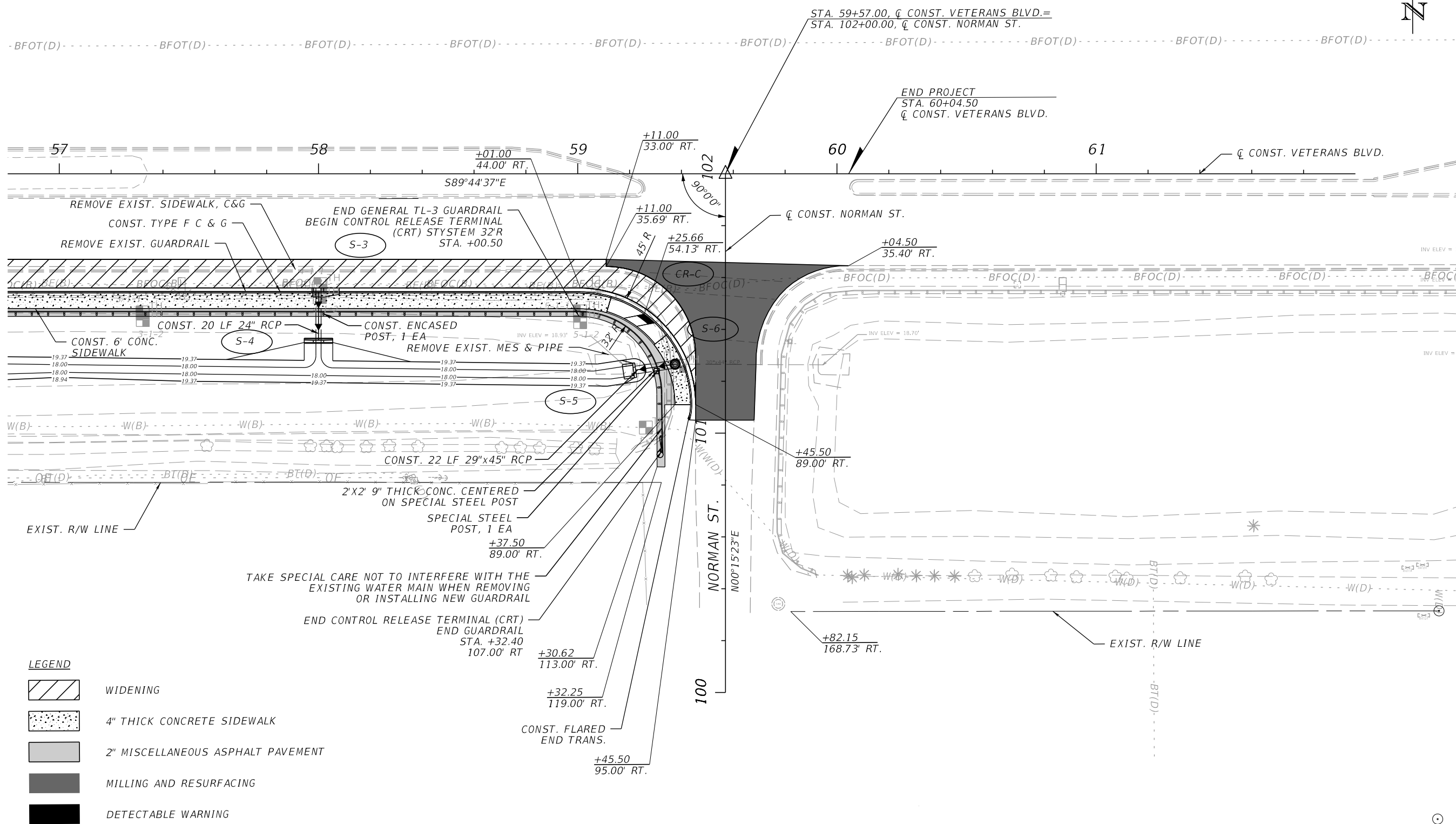

THE OFFICIAL RECORD OF THIS SHEET IS THE ELECTRONIC FILE DIGITALLY SIGNED AND SEALED UNDER RULE 61G15-23.004, F.A.C.

VETERANS BLVD.

NOTE: ALL DIMENSIONS & CALLOUTS ON THIS SHEET ARE MEASURED FROM  $\bar{C}$  CONST. VETERANS BLVD.



LEGEND

-  WIDENING
-  4" THICK CONCRETE SIDEWALK
-  2" MISCELLANEOUS ASPHALT PAVEMENT
-  MILLING AND RESURFACING
-  DETECTABLE WARNING

REVISIONS		ENGINEER OF RECORD		CHARLOTTE COUNTY PUBLIC WORKS DEPARTMENT	ROADWAY PLAN (2)	SHEET NO. 8
DATE	DESCRIPTION	DATE	DESCRIPTION			
			KRIS KARANXHA, P.E. LICENSE NUMBER 92368 FLORIDA TRANSPORTATION ENGINEERING, INC. 12550 TELECOM DRIVE TEMPLE TERRACE, FLORIDA 33637			

10/16/2025 4:15:57 PM CarryCorrales Z:\Projects\DOT\Veterans at Norman\Roadway\PLANRD01.dgn

THE OFFICIAL RECORD OF THIS SHEET IS THE ELECTRONIC FILE DIGITALLY SIGNED AND SEALED UNDER RULE 61G15-23.004, F.A.C.

VETERANS BLVD.

LEGEND

- XX.XX    EXIST. ELEVATION
- XX.XX    PROPOSED ELEVATION

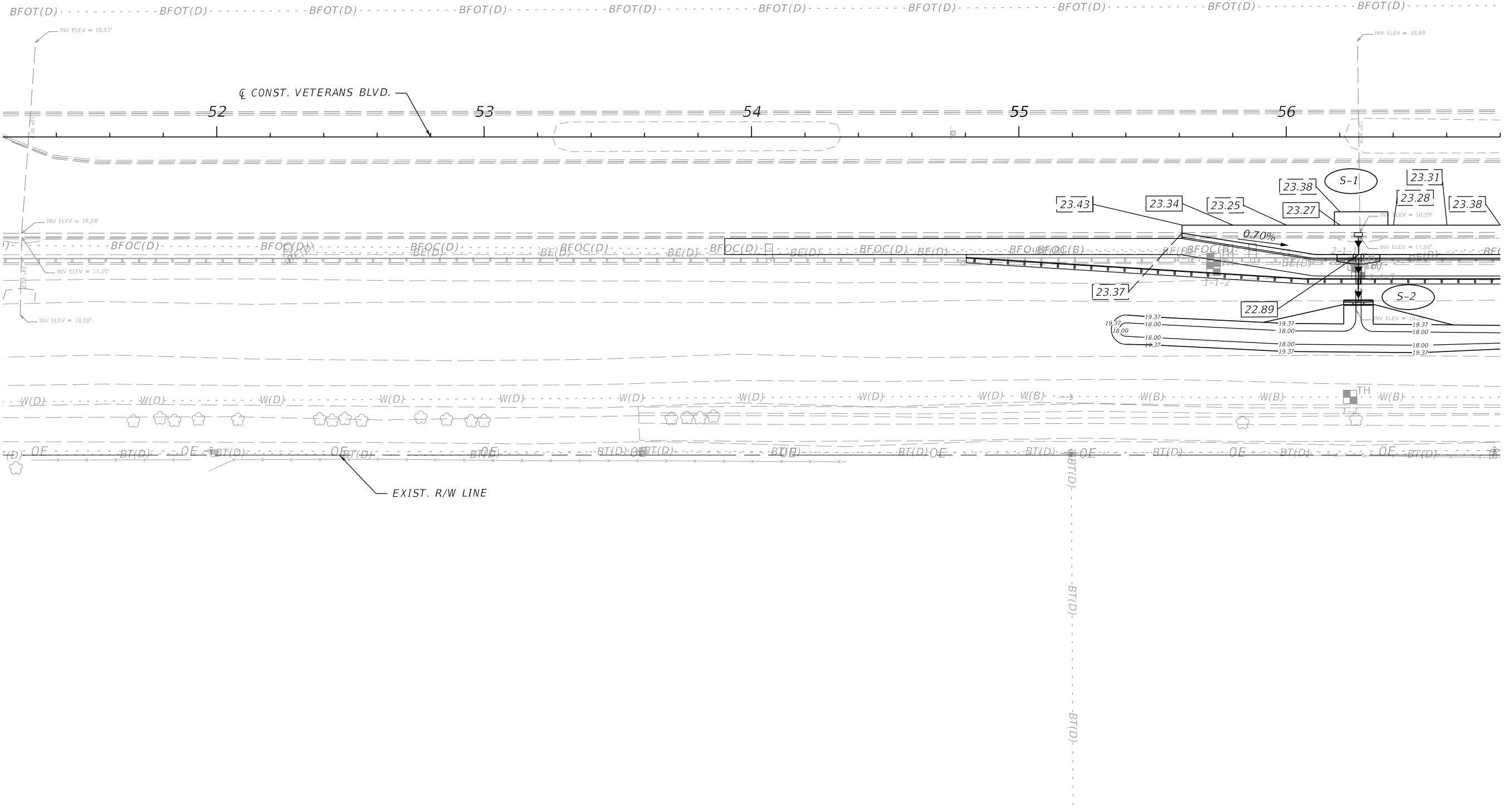

THE OFFICIAL RECORD OF THIS SHEET IS THE ELECTRONIC FILE DIGITALLY SIGNED AND SEALED UNDER RULE 61G15-23.004, F.A.C.

REVISIONS				ENGINEER OF RECORD		CHARLOTTE COUNTY PUBLIC WORKS DEPARTMENT	GRADING PLAN (1)		SHEET NO.
DATE	DESCRIPTION	DATE	DESCRIPTION	KRIS KARANXHA, P.E. LICENSE NUMBER 92368 FLORIDA TRANSPORTATION ENGINEERING, INC. 12550 TELECOM DRIVE TEMPLE TERRACE, FLORIDA 33637					9



THE OFFICIAL RECORD OF THIS SHEET IS THE ELECTRONIC FILE DIGITALLY SIGNED AND SEALED UNDER RULE 61G15-23.004, F.A.C.

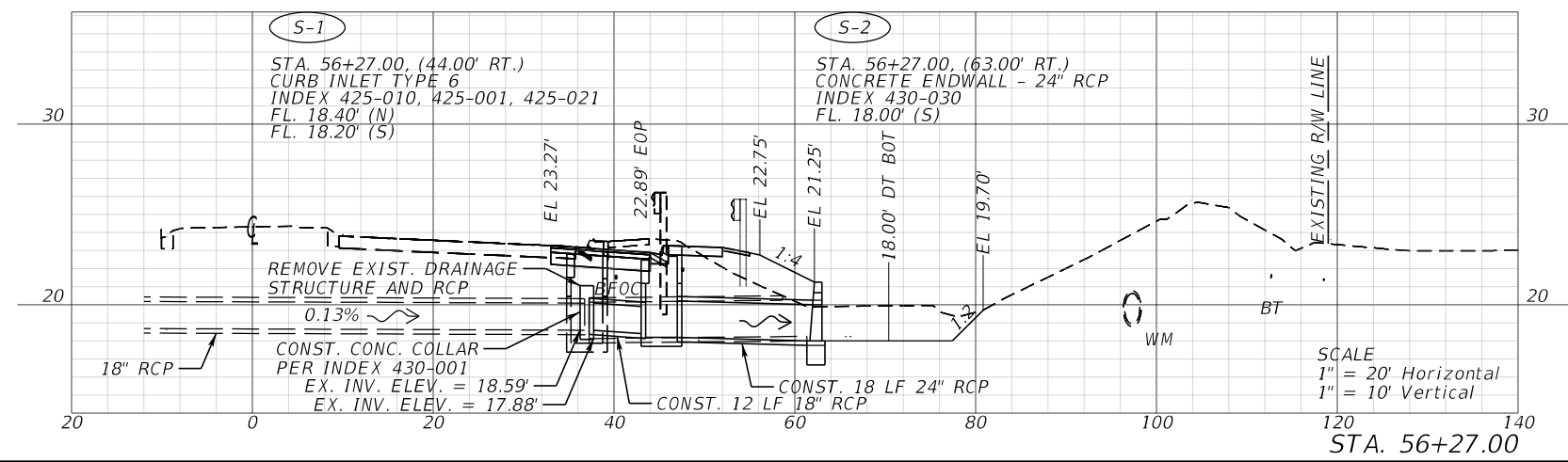
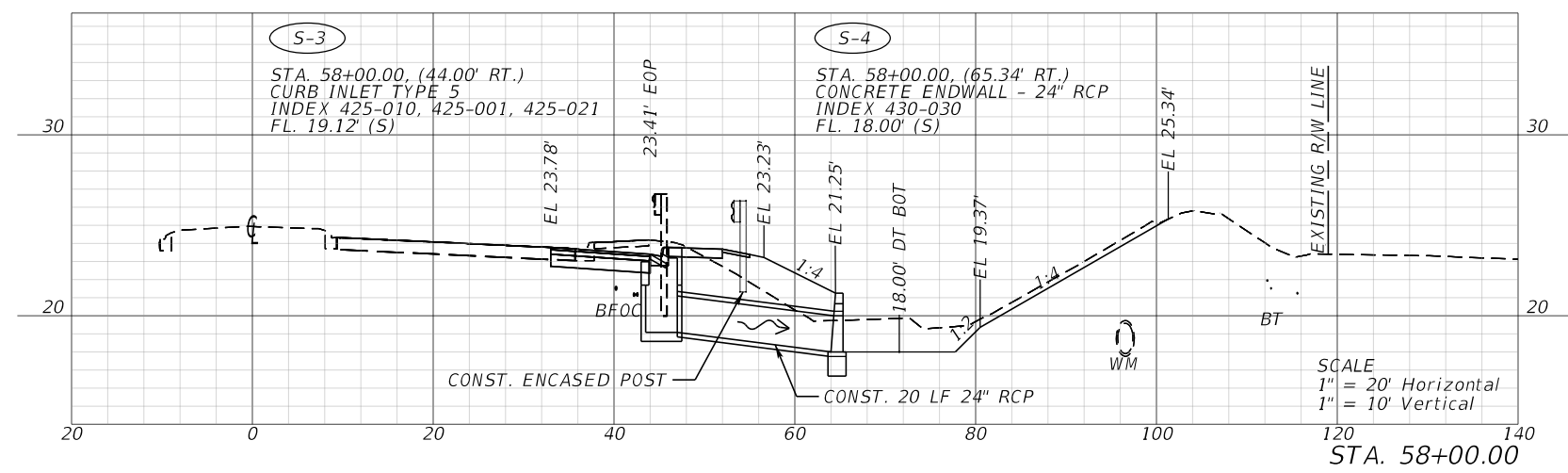
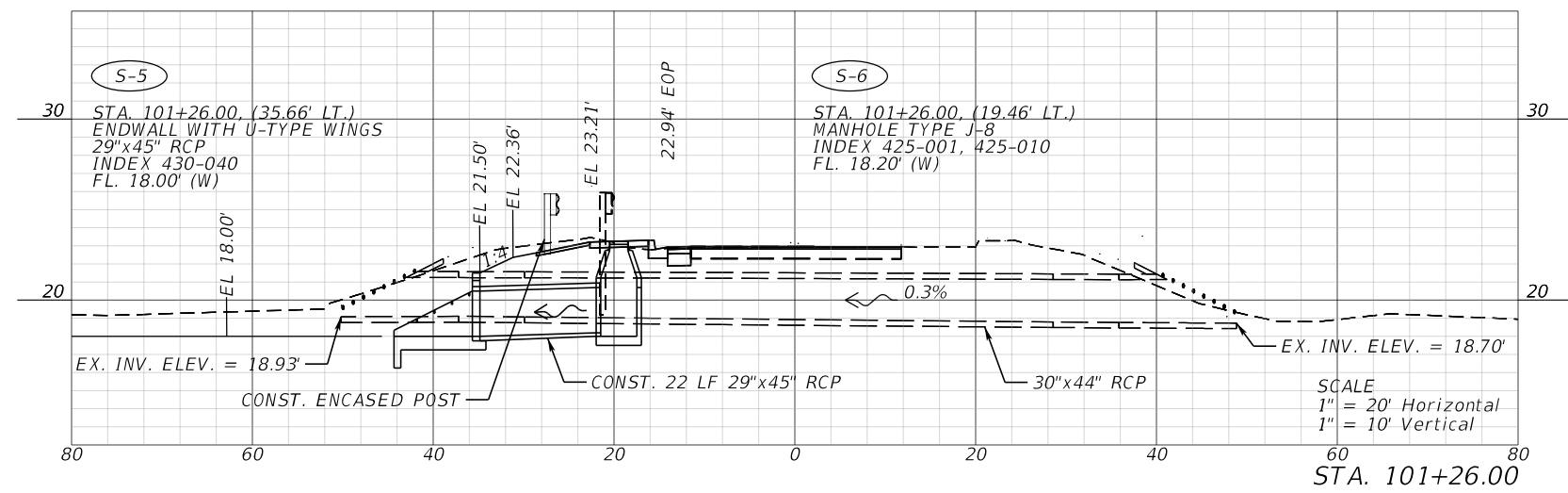

10/29/2025 4:11:35 PM KaiwenChen Z:\Projects\FDOT\Veterans at Norman\Drainage\DRXSRD01.dgn

REVISIONS				ENGINEER OF RECORD		CHARLOTTE COUNTY PUBLIC WORKS DEPARTMENT	DRAINAGE STRUCTURES	SHEET NO.
DATE	DESCRIPTION	DATE	DESCRIPTION	LUIS ALFREDO CELY, P.E. LICENSE NUMBER 70653 ALFKA, LLC. 400 N. TAMPA STREET, STE 1440 TAMPA, FLORIDA 33602				11

10/29/2025 4:11:39 PM KaiwenChen  
Z:\Projects\DOT\Veterans at Norman\Roadway\RD\ASRD01.dgn

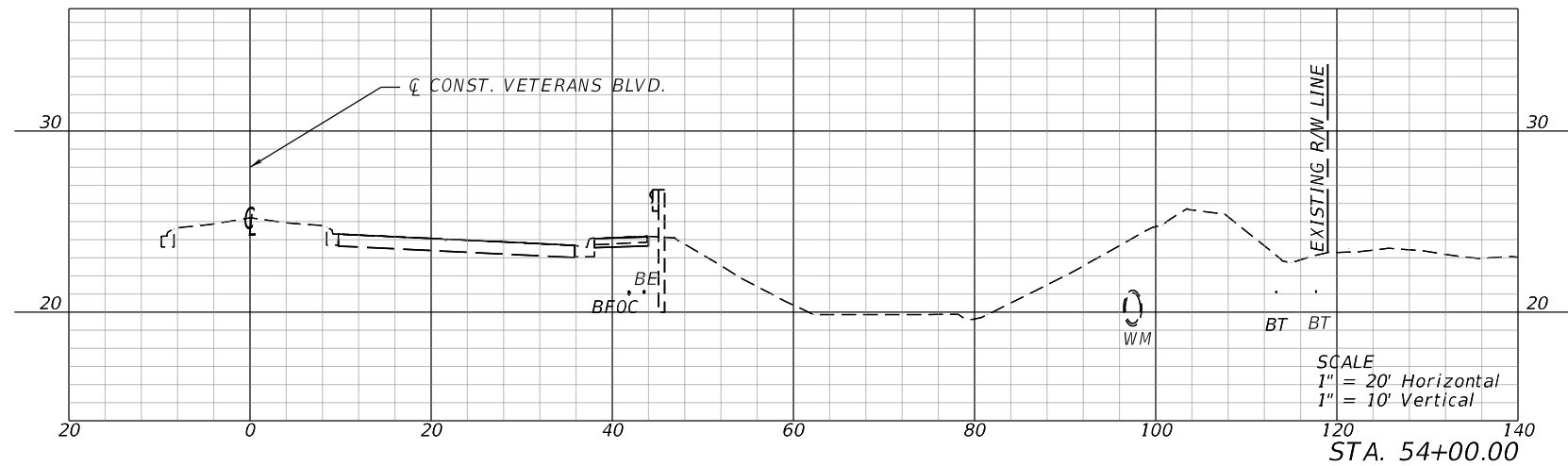
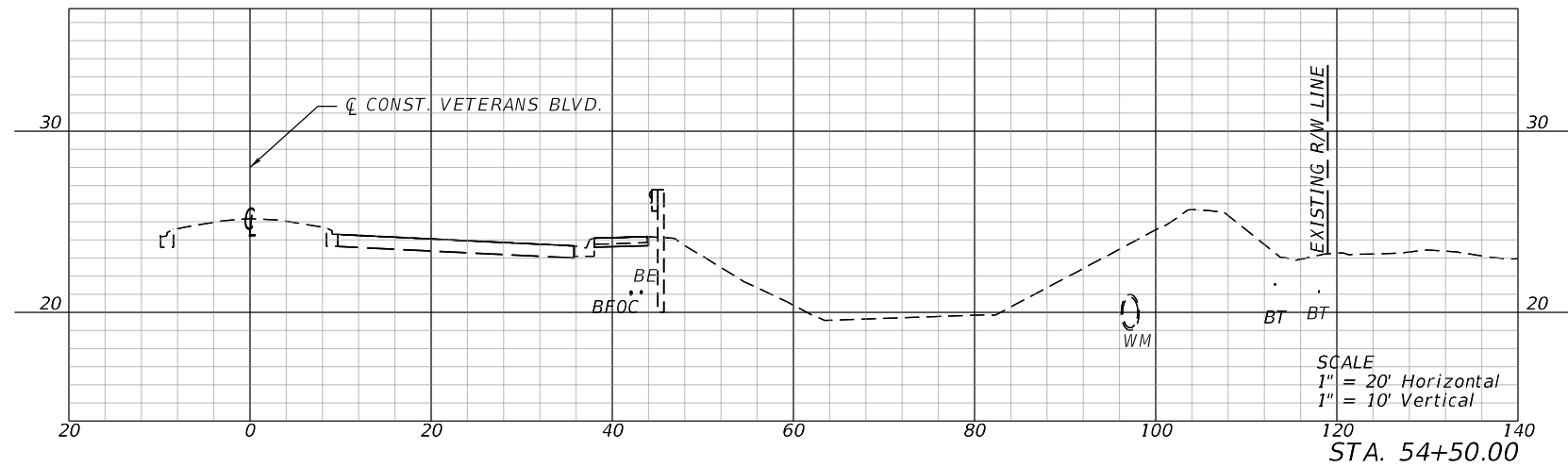
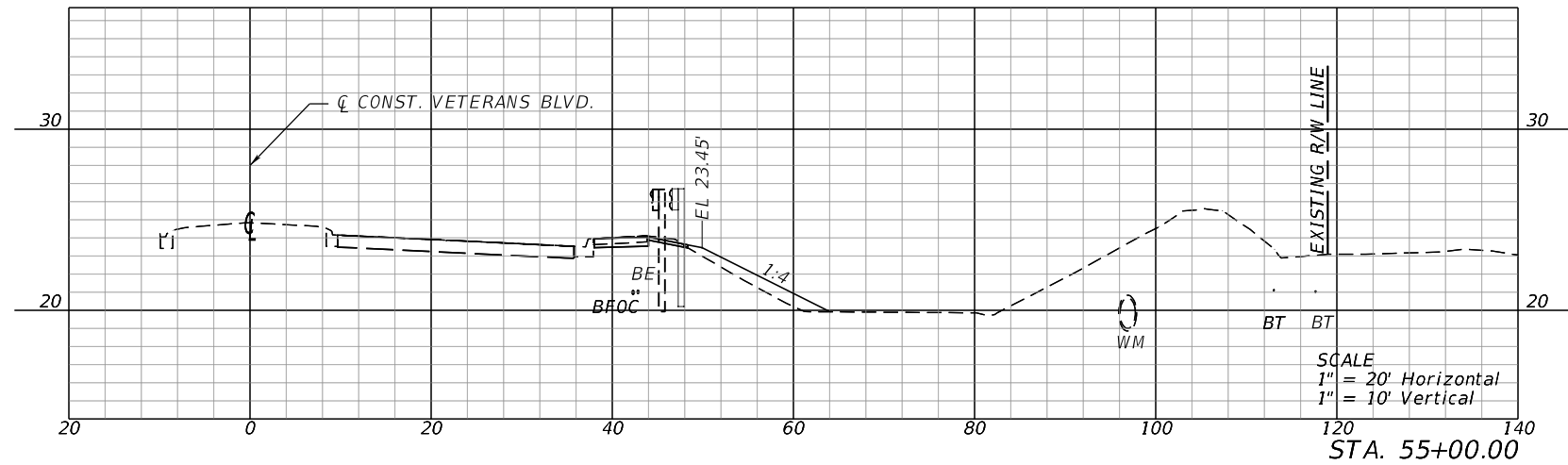

REVISIONS				ENGINEER OF RECORD		CHARLOTTE COUNTY PUBLIC WORKS DEPARTMENT	CROSS SECTIONS (1)	SHEET NO.
DATE	DESCRIPTION	DATE	DESCRIPTION	KRIS KARANXHA, P.E. LICENSE NUMBER 92368 FLORIDA TRANSPORTATION ENGINEERING, INC. 12550 TELECOM DRIVE TEMPLE TERRACE, FLORIDA 33637				12

THE OFFICIAL RECORD OF THIS SHEET IS THE ELECTRONIC FILE DIGITALLY SIGNED AND SEALED UNDER RULE 61G15-23.004, F.A.C.

10/29/2025 4:11:40 PM KaiwenChen Z:\Projects\FDOT\Veterans at Norman\Roadway\RD\ASRD01.dgn

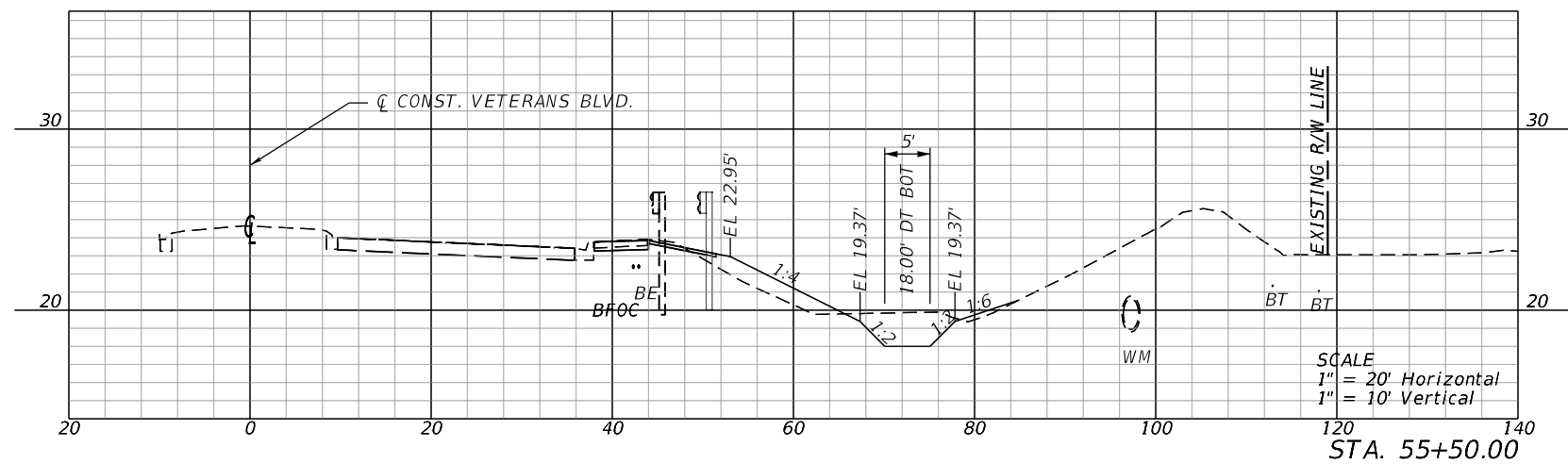
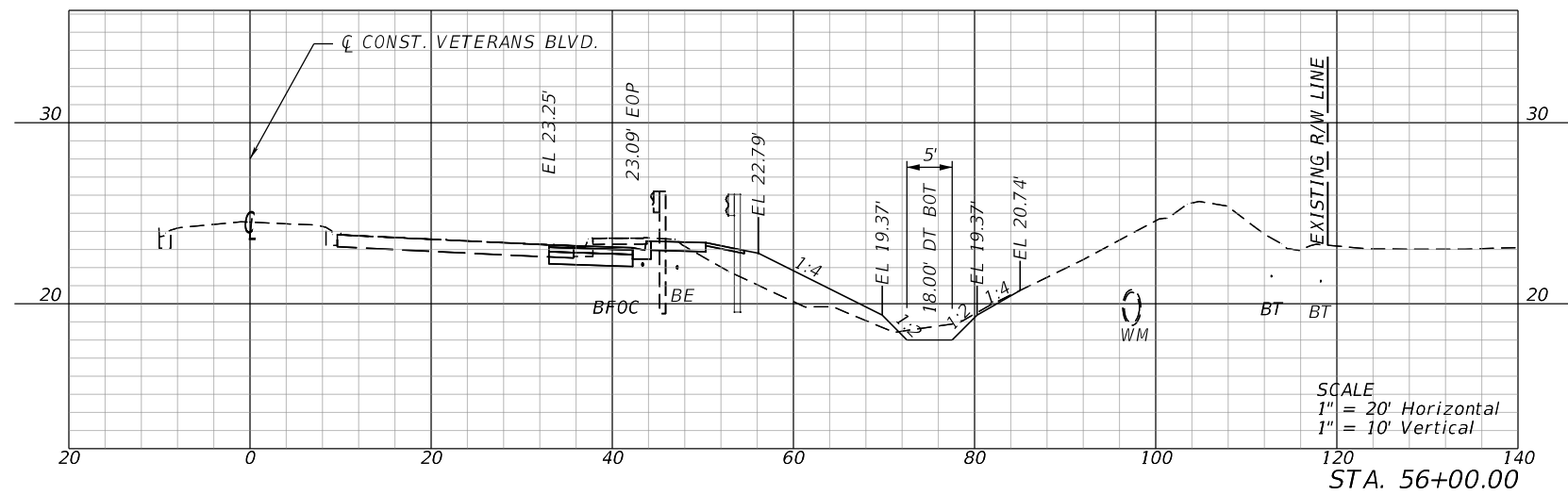
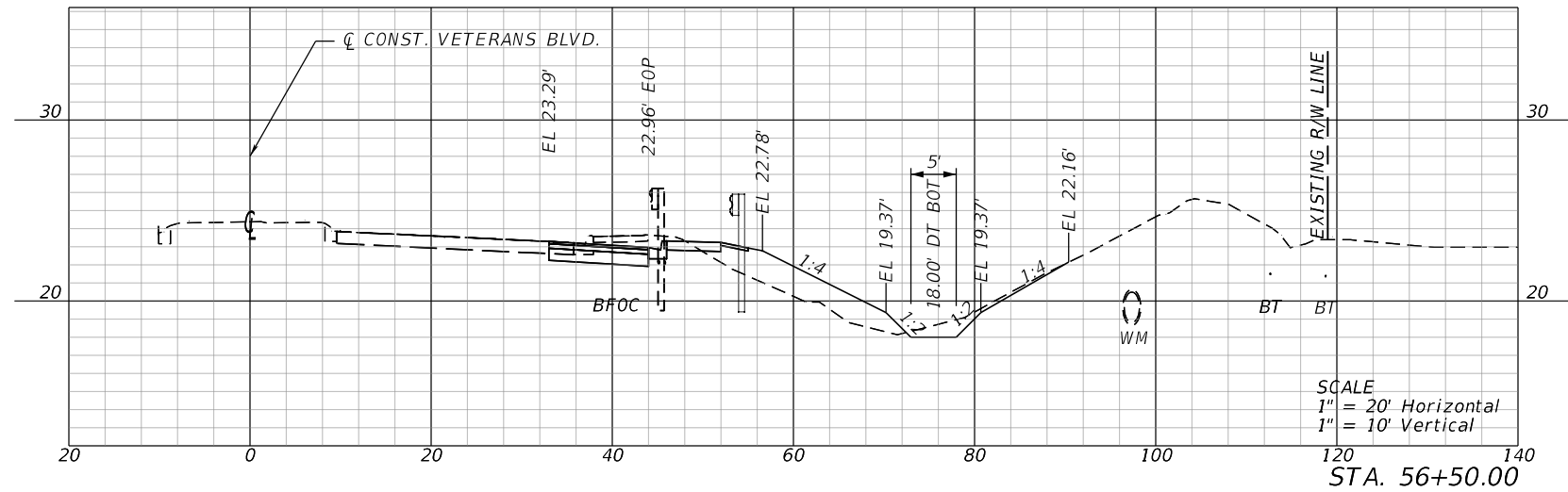

REVISIONS		REVISIONS		ENGINEER OF RECORD		SHEET NO.
DATE	DESCRIPTION	DATE	DESCRIPTION			
				KRIS KARANXHA, P.E. LICENSE NUMBER 92368 FLORIDA TRANSPORTATION ENGINEERING, INC. 12550 TELECOM DRIVE TEMPLE TERRACE, FLORIDA 33637		13
				CHARLOTTE COUNTY PUBLIC WORKS DEPARTMENT		CROSS SECTIONS (2)

THE OFFICIAL RECORD OF THIS SHEET IS THE ELECTRONIC FILE DIGITALLY SIGNED AND SEALED UNDER RULE 61G15-23.004, F.A.C.

10/29/2025 4:11:41 PM KaiwenChen  
Z:\Projects\DOT\Veterans at Norman\Roadway\RD\ASRD01.dgn

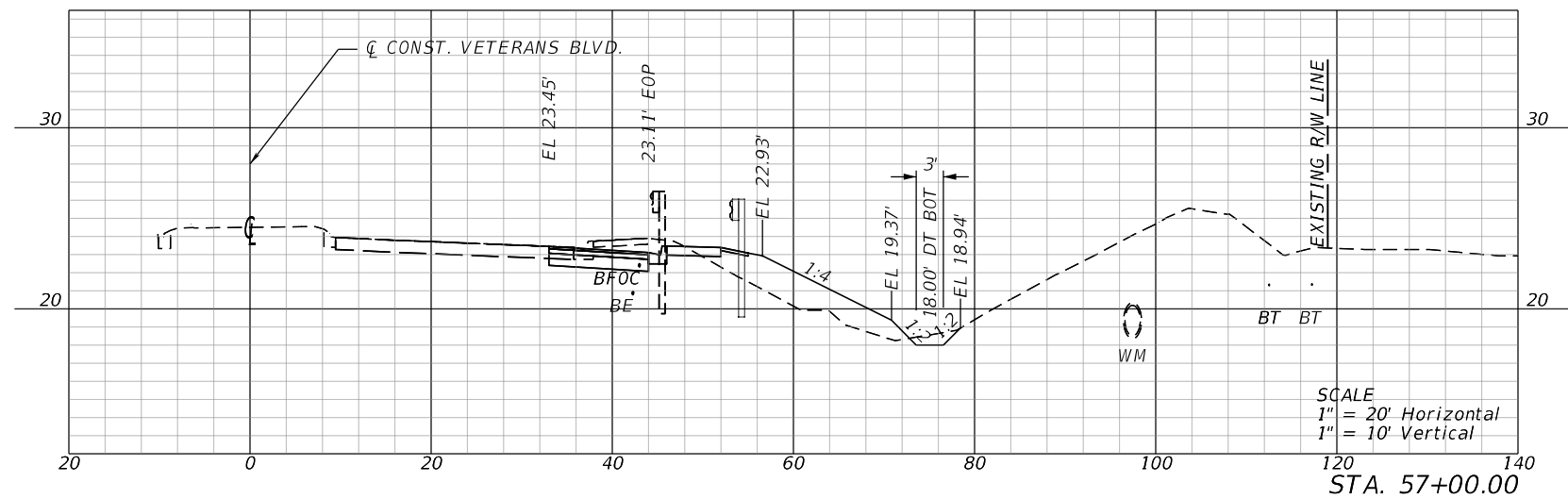
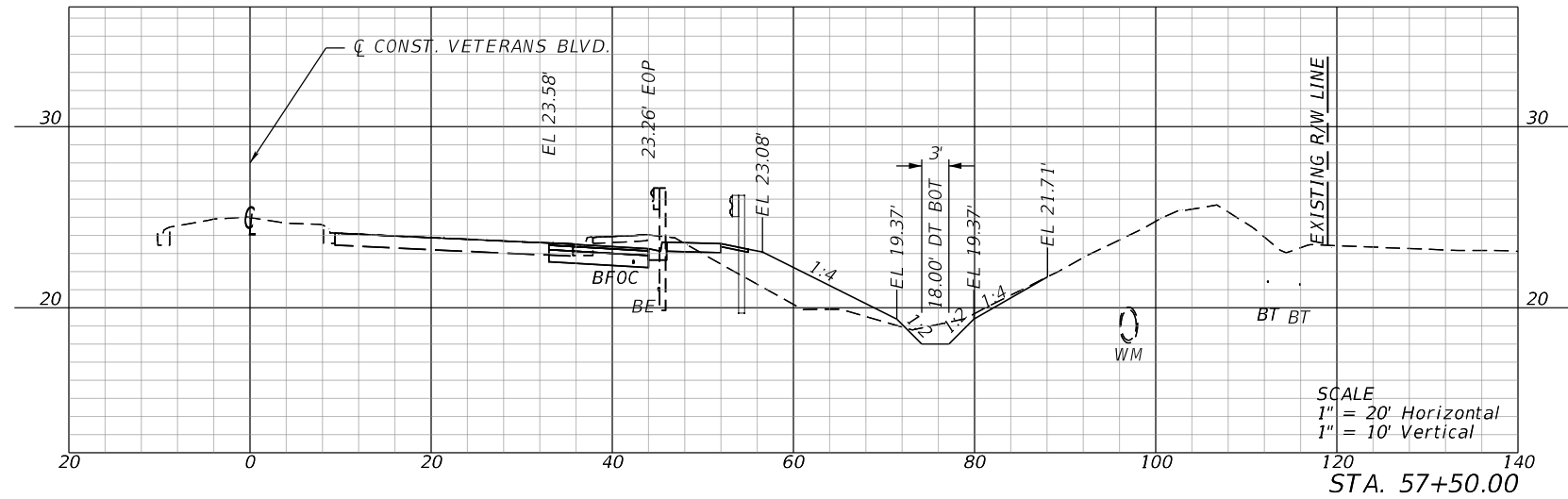
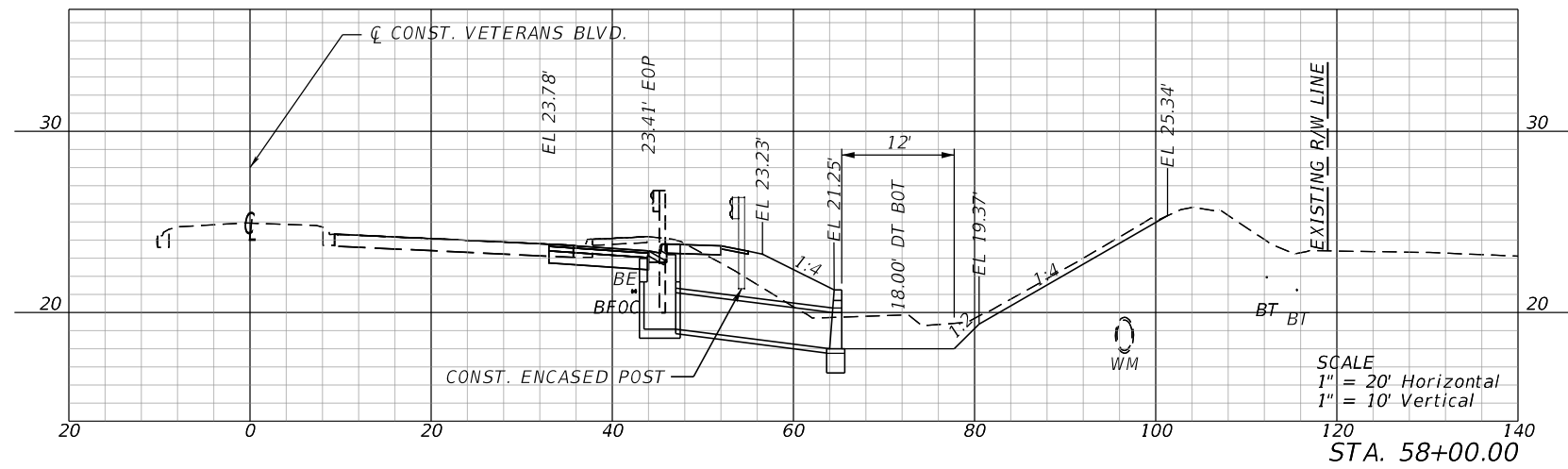

REVISIONS				ENGINEER OF RECORD		CHARLOTTE COUNTY PUBLIC WORKS DEPARTMENT	CROSS SECTIONS (3)	SHEET NO.
DATE	DESCRIPTION	DATE	DESCRIPTION	KRIS KARANXHA, P.E. LICENSE NUMBER 92368 FLORIDA TRANSPORTATION ENGINEERING, INC. 12550 TELECOM DRIVE TEMPLE TERRACE, FLORIDA 33637				14

THE OFFICIAL RECORD OF THIS SHEET IS THE ELECTRONIC FILE DIGITALLY SIGNED AND SEALED UNDER RULE 61G15-23.004, F.A.C.

10/29/2025 4:11:42 PM KaiwenChen  
 Z:\Projects\DOT\Veterans at Norman\Roadway\ARDSR001.dgn

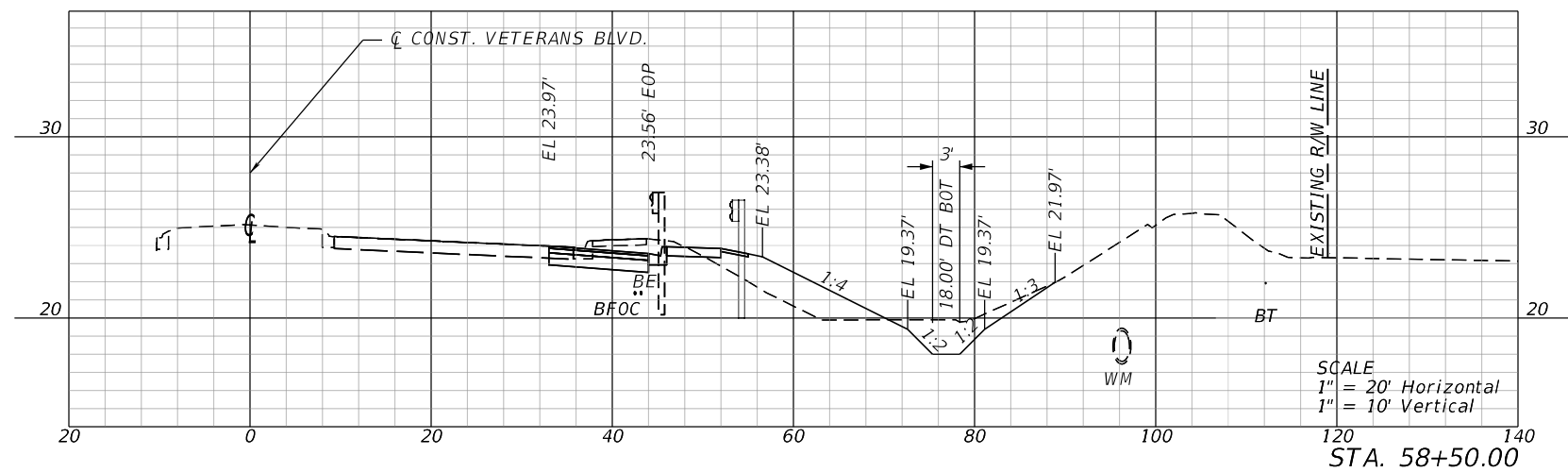
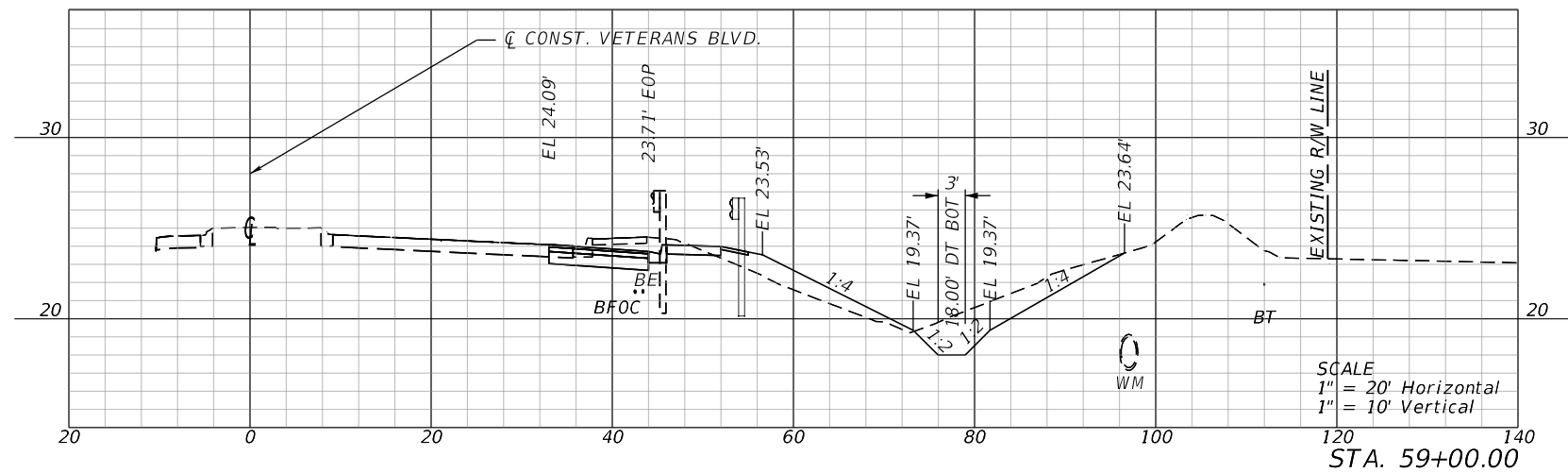
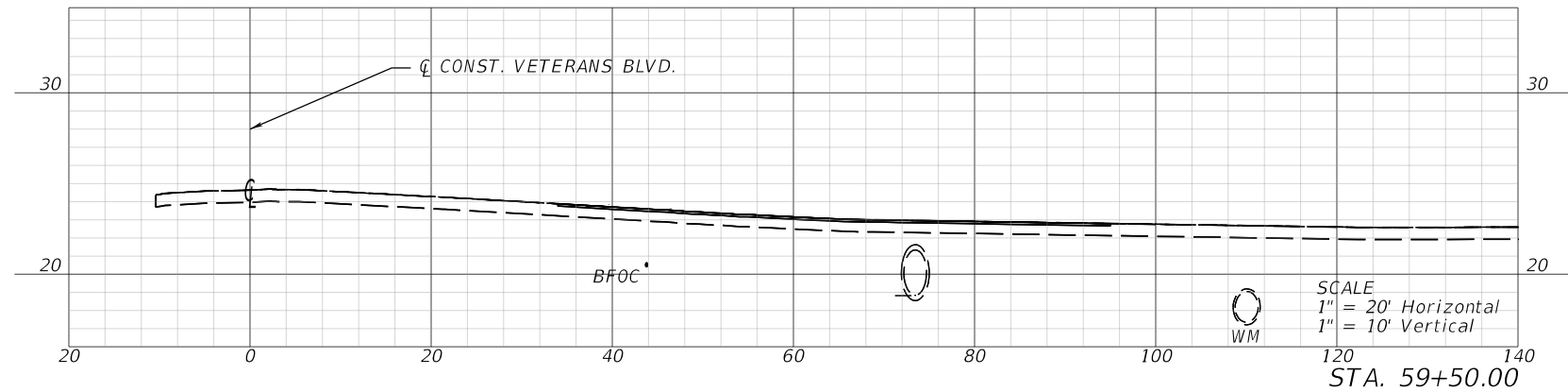

REVISIONS		ENGINEER OF RECORD		CHARLOTTE COUNTY PUBLIC WORKS DEPARTMENT	CROSS SECTIONS (4)	SHEET NO.
DATE	DESCRIPTION	DATE	DESCRIPTION			15
			KRIS KARANXHA, P.E. LICENSE NUMBER 92368 FLORIDA TRANSPORTATION ENGINEERING, INC. 12550 TELECOM DRIVE TEMPLE TERRACE, FLORIDA 33637			

THE OFFICIAL RECORD OF THIS SHEET IS THE ELECTRONIC FILE DIGITALLY SIGNED AND SEALED UNDER RULE 61G15-23.004, F.A.C.











VETERANS BLVD.

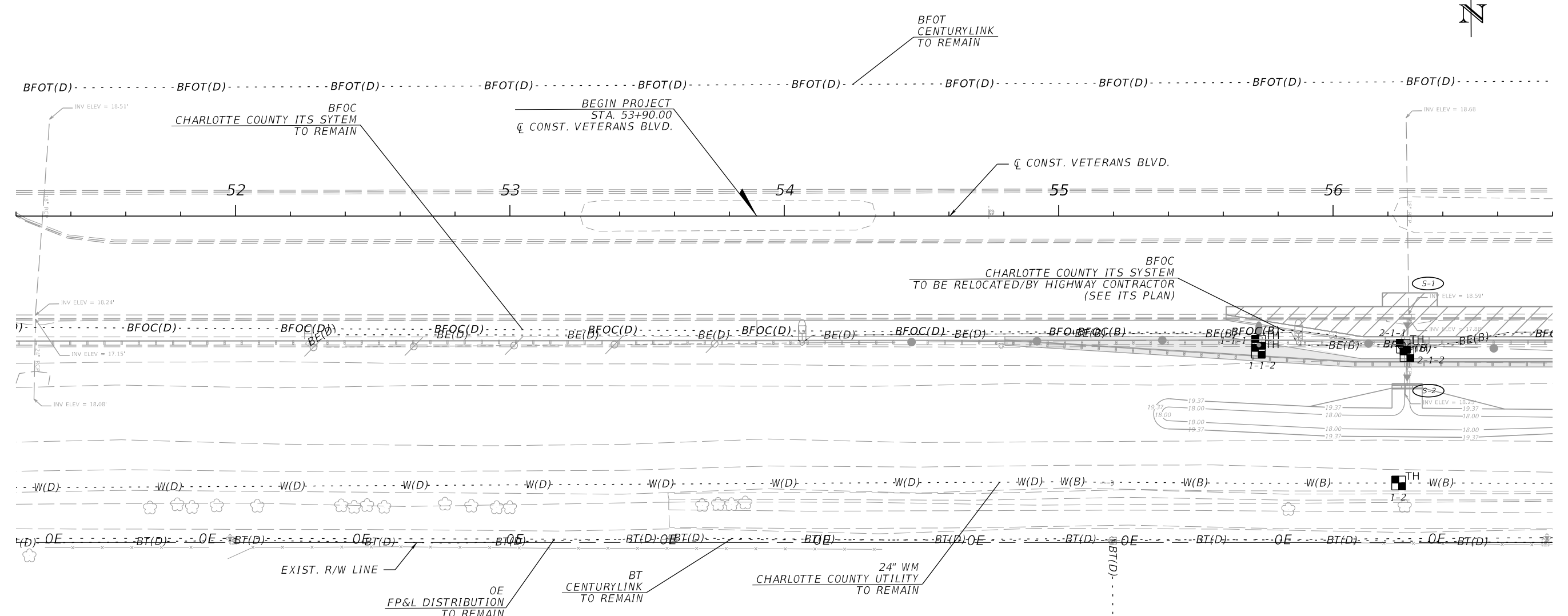
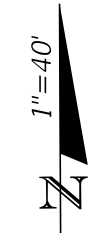

**NOTES**

1. THE LOCATION(S) OF THE UTILITIES SHOWN IN THE PLANS (INCLUDING THOSE DESIGNATED VV, VH, AND VVH) ARE BASED ON LIMITED INVESTIGATION TECHNIQUES AND SHOULD BE CONSIDERED APPROXIMATE ONLY. THE VERIFIED LOCATIONS/ELEVATIONS APPLY ONLY AT THE POINTS SHOWN. INTERPOLATIONS BETWEEN THESE POINTS HAVE NOT BEEN VERIFIED.
2. UTILITY/AGENCY OWNERS FOR THIS PROJECT INCLUDE:

COMPANY  
 CENTURYLINK  
 CHARLOTTE COUNTY LIGHTING DISTRICT  
 CHARLOTTE COUNTY UTILITIES  
 CHARLOTTE COUNTY ITS SYSTEM  
 FLORIDA POWER & LIGHT - CHARLOTTE(DISTRIBUTION)

CONTACT  
 KEN LUTZ  
 JODY MANSELL  
 HENDRIK DOLLEMAN  
 EVAN LEIBMAN  
 CHRIS MCJUNKIN

TELEPHONE NUMBERS  
 (863) 214-1490  
 (941) 575-3648  
 (941) 883-3521  
 (941) 764-5504  
 (941) 267-7476

EMAIL ADDRESSES  
 KEN.LUTZ@CENTURYLINK.COM  
 JODY.MANSELL@CHARLOTTECOUNTYFL.GOV  
 HENDRIK.DOLLEMAN@CHARLOTTECOUNTYFL.GOV  
 EVAN.LEIBMAN@CHARLOTTECOUNTYFL.GOV  
 CHRIS.MCJUNKIN@FPL.COM

10/16/2025 4:41:28 PM CarryCorrales Z:\Projects\DOT\Veterans at Norman\Roadway\UTADR01.dgn

THE OFFICIAL RECORD OF THIS SHEET IS THE ELECTRONIC FILE DIGITALLY SIGNED AND SEALED UNDER RULE 61G15-23.004, F.A.C.

REVISIONS		ENGINEER OF RECORD		SHEET NO.
DATE	DESCRIPTION	DATE	DESCRIPTION	
			KRIS KARANXHA, P.E. LICENSE NUMBER 92368 FLORIDA TRANSPORTATION ENGINEERING, INC. 12550 TELECOM DRIVE TEMPLE TERRACE, FLORIDA 33637	21
		CHARLOTTE COUNTY PUBLIC WORKS DEPARTMENT		
<b>UTILITY ADJUSTMENTS (1)</b>				

VETERANS BLVD.

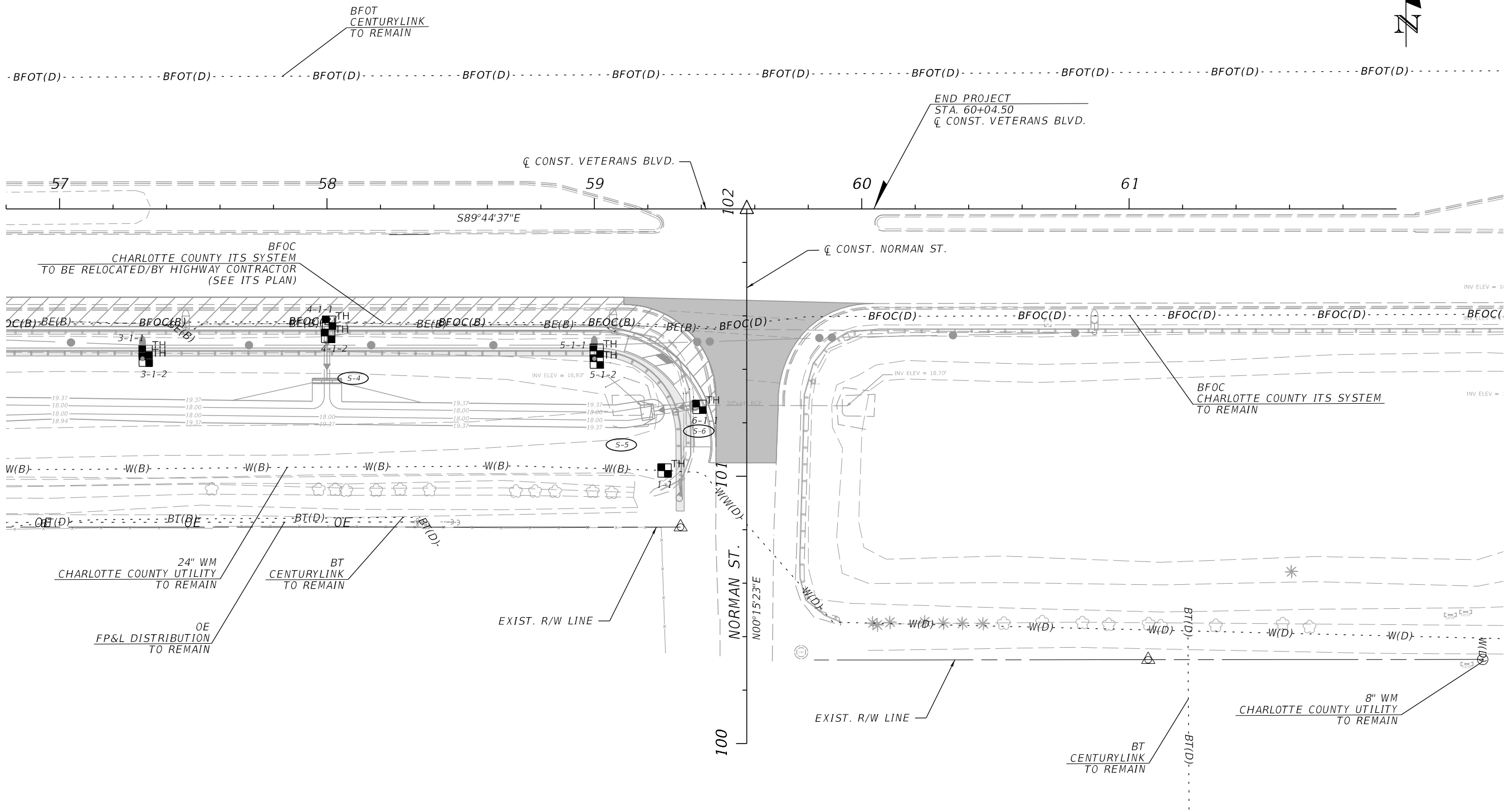

10/16/2025 4:42:20 PM CarryCorrales Z:\Projects\FDOT\Veterans at Norman\Roadway\UTADRD01.dgn

THE OFFICIAL RECORD OF THIS SHEET IS THE ELECTRONIC FILE DIGITALLY SIGNED AND SEALED UNDER RULE 61G15-23.004, F.A.C.

REVISIONS		ENGINEER OF RECORD		CHARLOTTE COUNTY PUBLIC WORKS DEPARTMENT	UTILITY ADJUSTMENT (2)	SHEET NO. 22
DATE	DESCRIPTION	DATE	DESCRIPTION			
				Kris Karanxha, P.E. License Number 92368 Florida Transportation Engineering, Inc. 12550 Telecom Drive Temple Terrace, Florida 33637		

VETERANS BLVD.

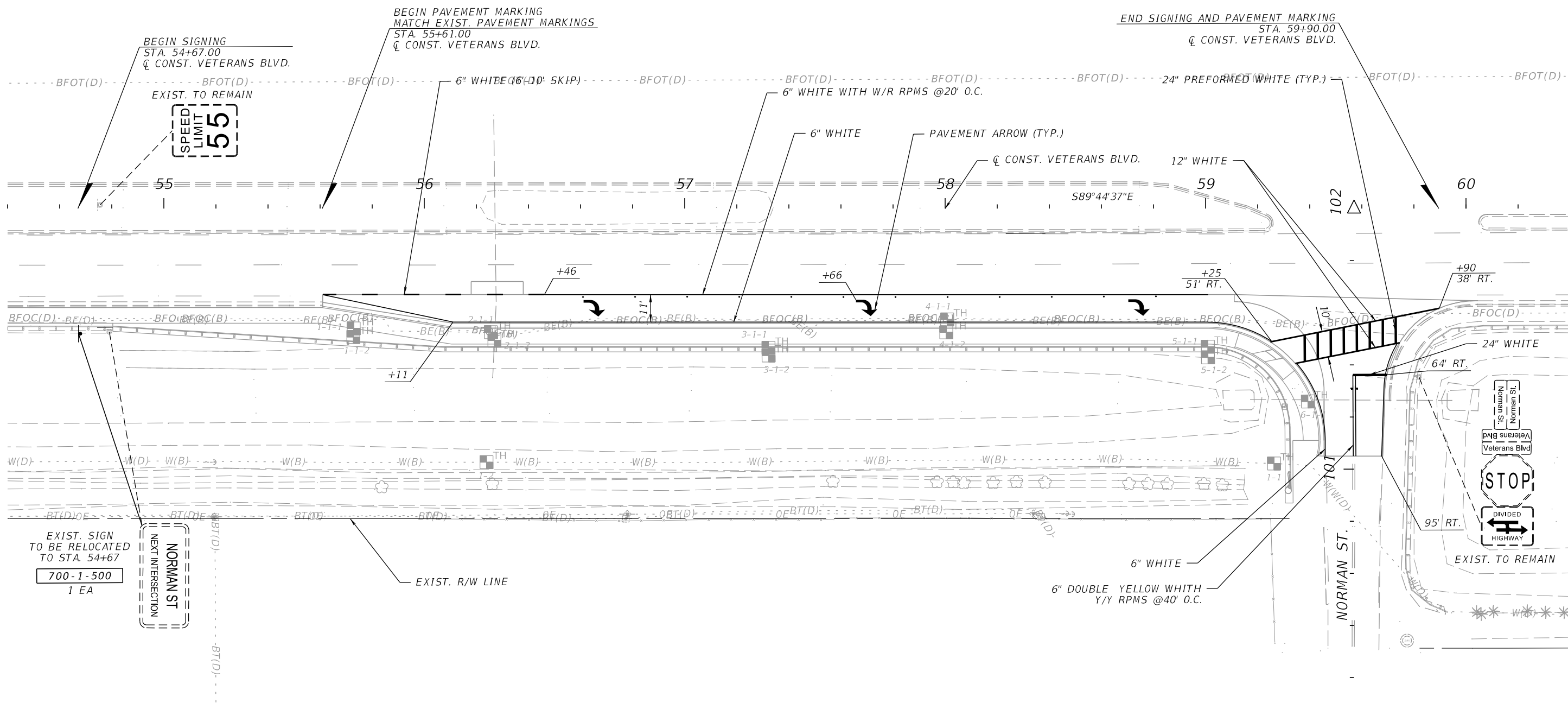

10/15/2025 4:13:50 PM Maxwelling Z:\Projects\FDOT\Veterans at Norman\SigningAndMarking\PLANS\01.dgn

THE OFFICIAL RECORD OF THIS SHEET IS THE ELECTRONIC FILE DIGITALLY SIGNED AND SEALED UNDER RULE 61G15-23.004, F.A.C.

REVISIONS		ENGINEER OF RECORD		CHARLOTTE COUNTY PUBLIC WORKS DEPARTMENT	SIGNING AND PAVEMENT MARKING PLAN	SHEET NO.
DATE	DESCRIPTION	DATE	DESCRIPTION			23
			OLIVER REMY RODRIGUES, P.E., P.T.O.E. LICENSE NUMBER 50646 FLORIDA TRANSPORTATION ENGINEERING, INC. 12550 TELECOM DRIVE TEMPLE TERRACE, FLORIDA 33637			

EXIST. SIGN  
TO BE RELOCATED  
TO STA. 54+67  
700-1-500  
1 EA

NORMAN ST  
NEXT INTERSECTION

EXIST. R/W LINE

6" WHITE  
6" DOUBLE YELLOW WHITE  
Y/Y RPMS @40' O.C.

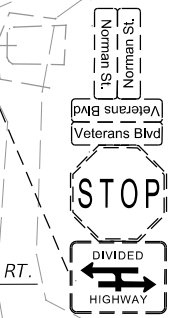









10/15/2025 4:13:55 PM Maxwelling Z:\Projects\DOT\Veterans at Norman\Roadway\GNWTRD01 - Trench.dgn

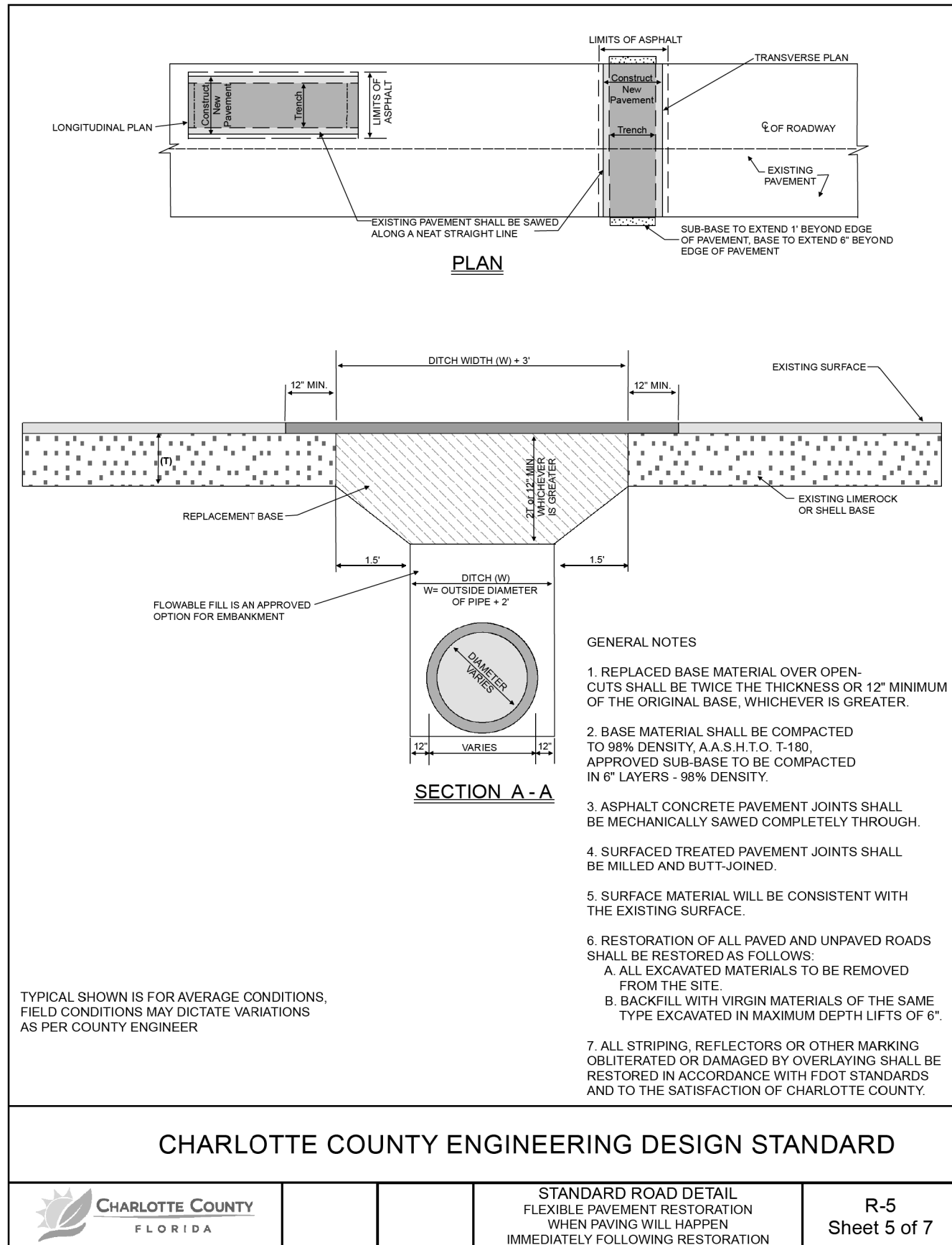

- GENERAL NOTES**
1. REPLACED BASE MATERIAL OVER OPEN-CUTS SHALL BE TWICE THE THICKNESS OR 12" MINIMUM OF THE ORIGINAL BASE, WHICHEVER IS GREATER.
  2. BASE MATERIAL SHALL BE COMPACTED TO 98% DENSITY, A.A.S.H.T.O. T-180, APPROVED SUB-BASE TO BE COMPACTED IN 6" LAYERS - 98% DENSITY.
  3. ASPHALT CONCRETE PAVEMENT JOINTS SHALL BE MECHANICALLY SAWED COMPLETELY THROUGH.
  4. SURFACED TREATED PAVEMENT JOINTS SHALL BE MILLED AND BUTT-JOINED.
  5. SURFACE MATERIAL WILL BE CONSISTENT WITH THE EXISTING SURFACE.
  6. RESTORATION OF ALL PAVED AND UNPAVED ROADS SHALL BE RESTORED AS FOLLOWS:
    - A. ALL EXCAVATED MATERIALS TO BE REMOVED FROM THE SITE.
    - B. BACKFILL WITH VIRGIN MATERIALS OF THE SAME TYPE EXCAVATED IN MAXIMUM DEPTH LIFTS OF 6".
  7. ALL STRIPING, REFLECTORS OR OTHER MARKING OBLITERATED OR DAMAGED BY OVERLAYING SHALL BE RESTORED IN ACCORDANCE WITH FDOT STANDARDS AND TO THE SATISFACTION OF CHARLOTTE COUNTY.

TYPICAL SHOWN IS FOR AVERAGE CONDITIONS, FIELD CONDITIONS MAY DICTATE VARIATIONS AS PER COUNTY ENGINEER

REVISIONS			
DATE	DESCRIPTION	DATE	DESCRIPTION

FOR INFORMATIONAL PURPOSES ONLY.

CHARLOTTE COUNTY  
PUBLIC WORKS DEPARTMENT

*CHARLOTTE COUNTY  
OPEN TRENCH DETAIL*

SHEET NO.  
28