

CHARLOTTE COUNTY
PUBLIC WORKS DEPARTMENT
CONTRACT PLANS

VETERANS BLVD. AT LOVELAND STREET

END PROJECT
 STA. 7+61.96

☒ CONST. VETERANS BLVD.

BEGIN PROJECT
 STA. 3+20.00
 ☒ CONST. VETERANS BLVD.

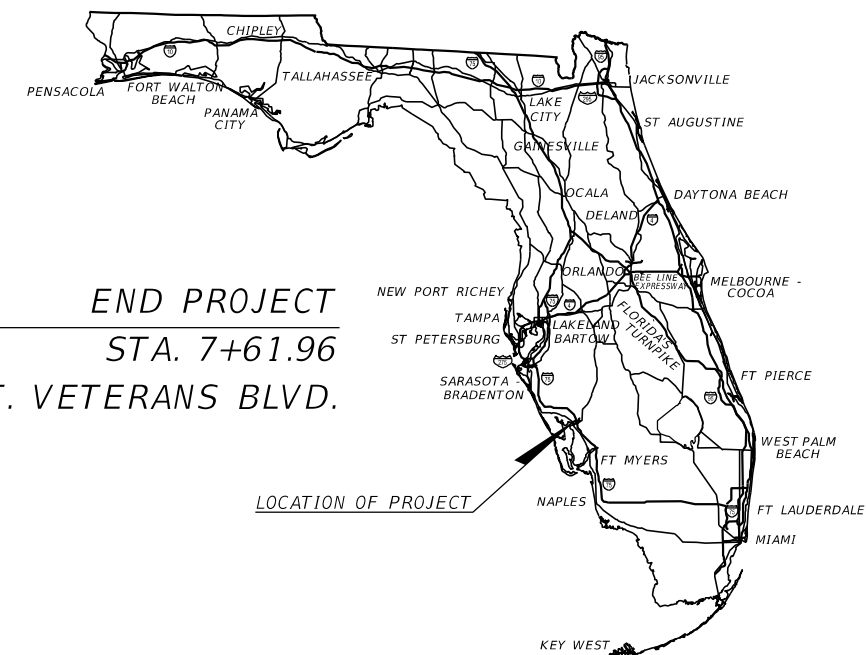

INDEX OF ROADWAY PLANS

| SHEET NO. | SHEET DESCRIPTION |
|-----------|-----------------------------------|
| 1 | KEY SHEET |
| 2 | SIGNATURE SHEET |
| 3 | TYPICAL SECTION |
| 4 | SUMMARY OF DRAINAGE STRUCTURES |
| 5 - 6 | GENERAL NOTES |
| 7 | ROADWAY PLAN |
| 8 | GRADING PLAN |
| 9 | DRAINAGE STRUCTURES |
| 10 - 11 | CROSS SECTIONS |
| 12 | EROSION CONTROL PLAN |
| 13 | TEMPORARY TRAFFIC CONTROL PLAN |
| 14 | SUMMARY OF VERIFIED UTILITIES |
| 15 | UTILITY ADJUSTMENTS |
| 16 | SIGNING AND PAVEMENT MARKING PLAN |
| 17 | ITS PLAN |
| 18 | POLE DATA AND LEGEND |
| 19 | LIGHTING PLAN |

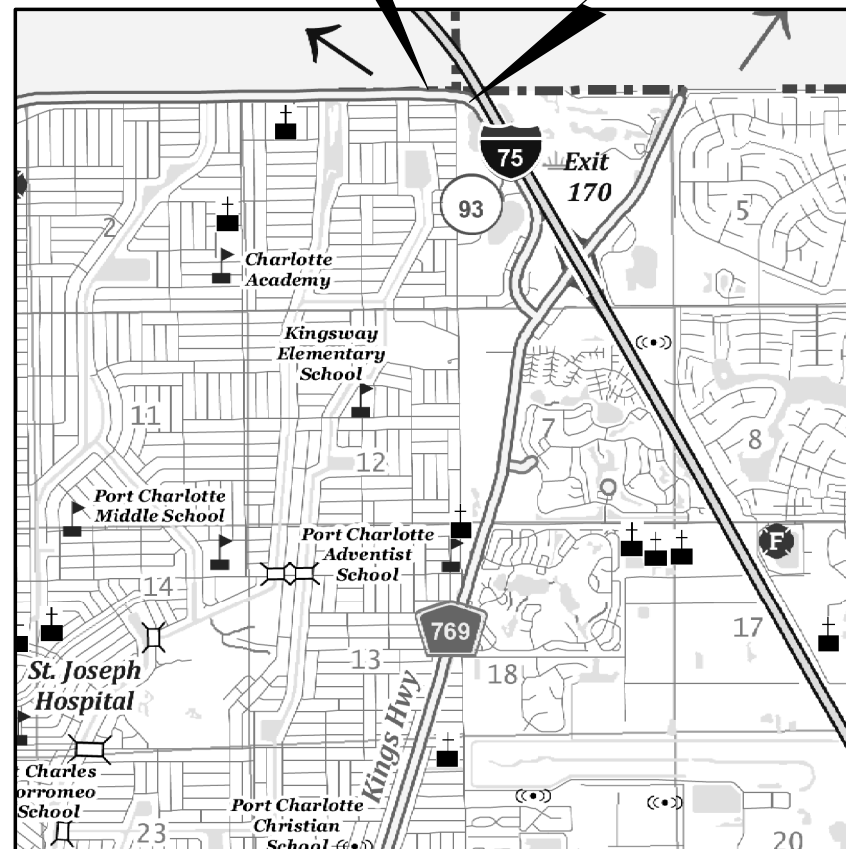

ROADWAY PLANS
 ENGINEER OF RECORD:

KRIS KARANXHA, P.E.
 P.E. LICENSE NUMBER 92368
 FLORIDA TRANSPORTATION ENGINEERING, INC.
 11458 NORTH 53RD STREET
 TAMPA, FLORIDA 33617
 CONTRACT NO.: 2019000297
 VENDOR NO.: F65-0183924

CHARLOTTE COUNTY PUBLIC WORKS DIRECTOR:

JOHN ELIAS

CHARLOTTE COUNTY COUNTY ENGINEER:

JOANNE VERNON, P.E.

CHARLOTTE COUNTY PROJECT MANAGER:

JEFF KEYSER

CHARLOTTE COUNTY BOARD OF COMMISSIONS

- DISTRICT 1: KEN DOHERTY
- DISTRICT 2: CHRISTOPHER CONSTANCE
- DISTRICT 3: BILL TRUOX
- DISTRICT 4: STEPHEN R. DEUTSCH
- DISTRICT 5: JOE TIESO

SHEET
 NO.

1

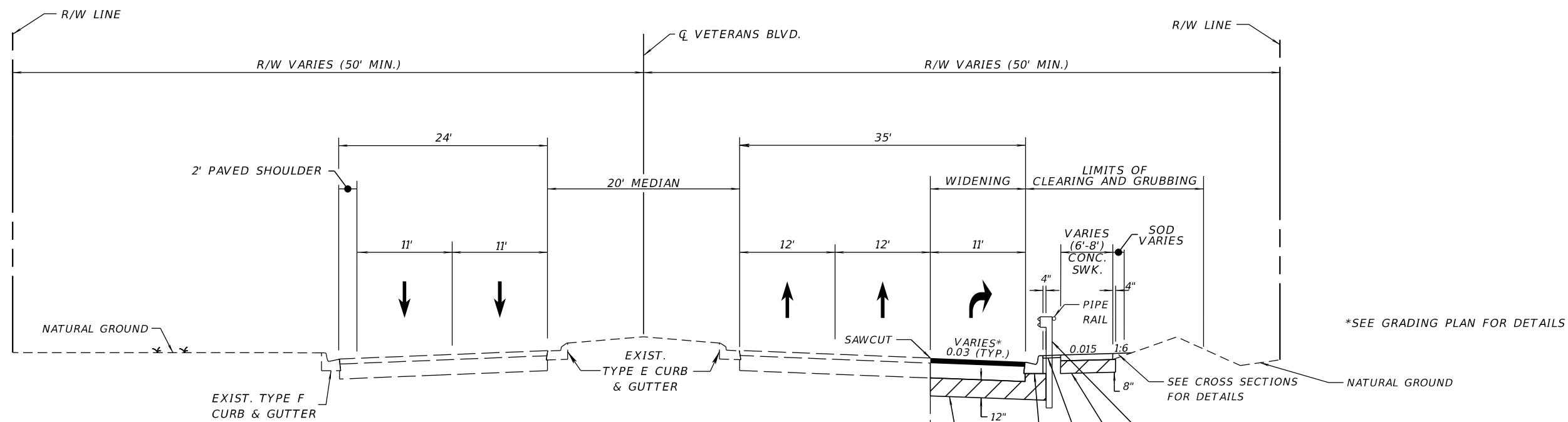

**TYPICAL SECTION
VETERANS BLVD.
STA. 3+20.00 TO STA. 6+10.00**

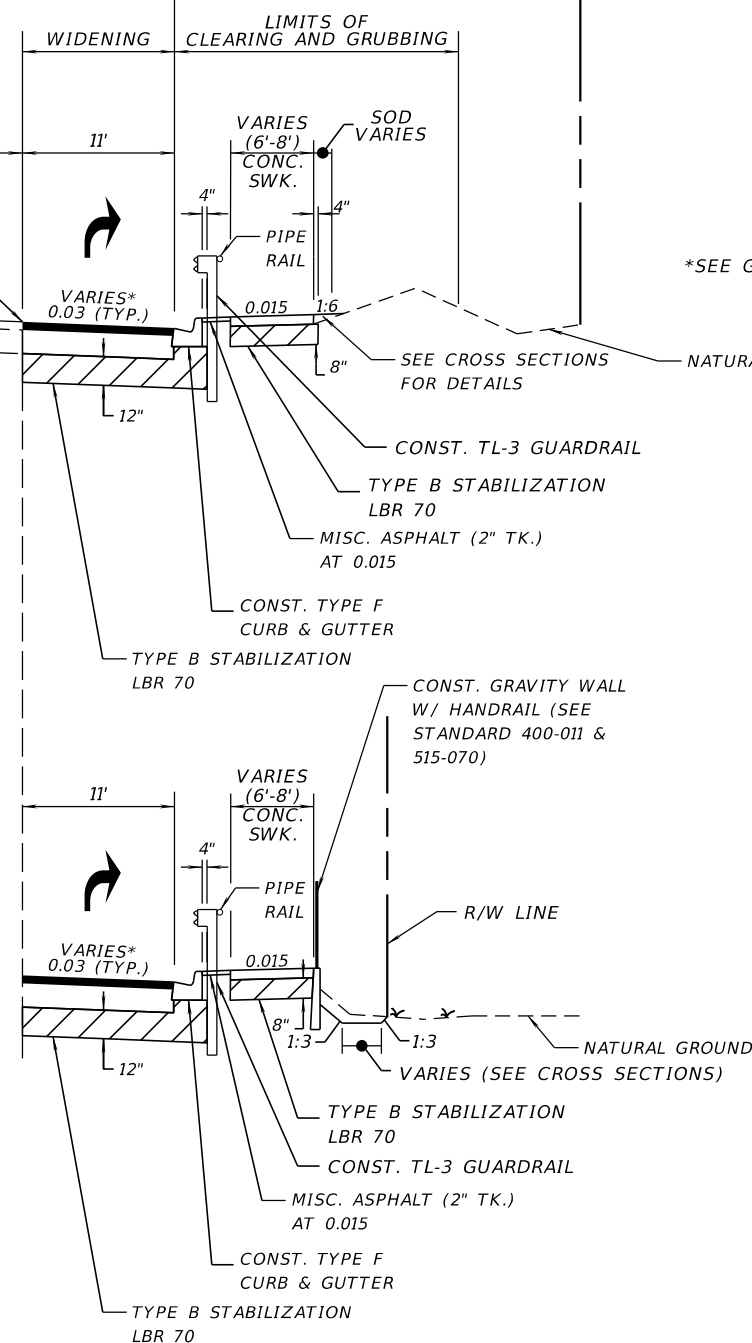

**PARTIAL SECTION
VETERANS BLVD.
STA. 6+10.00 TO STA. 6+90.00**

WIDENING

OPTIONAL BASE GROUP 9 WITH
3" TYPE S-I ASPHALTIC CONCRETE
AND 1.5" TYPE S-III ASPHALT

RESURFACING

MILL EXIST. ASPHALT PAVEMENT 1.5" DEPTH
1.5" TYPE S-III ASPHALT

TRAFFIC DATA

CURRENT YEAR = 2024 AADT = 26000
K = 9% D = 53.2% T = 9% (24 HOUR)
DESIGN SPEED = 45 MPH
POSTED SPEED = 55 MPH

| REVISIONS | | ENGINEER OF RECORD | |
|-----------|-------------|--------------------|--|
| DATE | DESCRIPTION | DATE | DESCRIPTION |
| | | | KRIS KARANXHA, P.E. LICENSE NUMBER 92368 FLORIDA TRANSPORTATION ENGINEERING, INC. 11458 NORTH 53RD STREET TAMPA, FLORIDA 33617 |

CHARLOTTE COUNTY
PUBLIC WORKS DEPARTMENT

TYPICAL SECTION

SHEET NO.

3

11/8/2024 3:24:38 PM KaiwenChen S:\Projects\FDOT\Veterans At Loveland\Roadway\TYP\SRD01.dgn

THE OFFICIAL RECORD OF THIS SHEET IS THE ELECTRONIC FILE DIGITALLY SIGNED AND SEALED UNDER RULE 61G15-23.004, F.A.C.

GENERAL NOTES

- ALL BENCHMARK ELEVATIONS SHOWN ON THE PLANS ARE NORTH AMERICAN VERTICAL DATUM OF 1988 (NAVD 88). EXISTING AND PROPOSED ELEVATIONS SHOWN ARE BASED ON NORTH AMERICAN VERTICAL DATUM OF 1988 (NAVD 88).
- ALL SURVEY INFORMATION WAS OBTAINED FROM A LICENSED FLORIDA PROFESSIONAL SURVEYOR AND MAPPER AND UTILIZED AS SUPPORTING DATA IN THE PRODUCTION OF DESIGN PLANS AND FOR CONSTRUCTION ON THE SUBJECT PROJECT. THE PROFESSIONAL SURVEYOR AND MAPPER OF RECORD IS:
 JOEL LABORDE RIVERA, P.L.S.
 L.S. NO: 7264
 FLORIDA TRANSPORTATION ENGINEERING, INC.
 11458 NORTH 53RD STREET
 TAMPA, FLORIDA, 33617
- CONTACT CHARLOTTE COUNTY UTILITY DEPARTMENT 48 HOURS PRIOR TO CONSTRUCTION.
- ALL WORK AND MATERIALS FOR THE PROJECT SHALL CONFORM TO CURRENT CHARLOTTE COUNTY SPECIFICATIONS.
- EXISTING FACILITIES SHALL BE RESTORED TO A CONDITION EQUIVALENT OR BETTER TO THAT WHICH EXISTED PRIOR TO COMMENCING CONSTRUCTION, AT NO ADDITIONAL COST TO THE OWNER.
- ANY LAND DISTURBED BY CONSTRUCTION SHALL BE SODDED. USE ARGENTINE BAHIA OR LIKE KIND AND CONFORM TO FDOT SPECIFICATION SECTION 570 AND STANDARD PLANS INDEX 570-010. SOD ALONG EDGES OF PAVEMENT OF ALL ROADS, SIDEWALKS, AND/OR CURB SHALL BE 1 INCH BELOW FINISHED PAVEMENT GRADE.
- ADJUST ALL VALVE BOXES, MANHOLE RIMS, GRATES, ETC. AS NECESSARY TO MATCH PROPOSED GRADES.
- CONCRETE SIDEWALKS SHALL BE CONSTRUCTED PER FDOT INDEX NO. 522-001 (FY 2024-25) AND FDOT STANDARD SPECIFICATION NO. 522 EXCEPT FOR CURB CUT RUNS WHICH SHALL BE FINISHED IN ACCORDANCE WITH INDEX NO. 522-002 EXCEPT AMENDMENTS TO DESIGN PER CHARLOTTE COUNTY PUBLIC WORKS - ENGINEERING DIVISION. CLASS 1 CONCRETE, 3,000 PSI @ 28 DAYS SHALL BE USED FOR ALL SIDEWALKS AND CONCRETE STRUCTURES, SIDEWALKS TO RECEIVE FIBERMESH REINFORCING.

DRAINAGE NOTES:

- ALL CONCRETE PIPE SHALL BE REINFORCED WITH STEEL. PIPE LENGTH SHOWN IS CENTER OF STRUCTURE TO CENTER OF STRUCTURE AND OUTLET ENDS OF MITERED END SECTIONS AND FLARED END SECTIONS.
- ALL CONCRETE BOX CULVERTS AND REINFORCED CONCRETE PIPE JOINTS (BOTH ROUND AND ELLIPTICAL PIPE) SHALL BE WRAPPED WITH GEOTEXTILE MATERIAL (MIRAFI, OR EQUAL). THE FABRIC SHALL COMPLETELY ENCIRCLE THE JOINT AND BE OVERLAPPED 2-1/2 FEET, AND EXTENDED 2-1/2 FEET BOTH SIDES OF THE JOINT. ALL FABRIC TO BE SECURED WITH AN APPROVED MASTIC DESIGNED FOR THIS PURPOSE.
- THE STORM DRAINAGE PIPING AND FILTRATION SYSTEM SHALL BE SUBJECT TO A VISUAL INSPECTION BY THE OWNER'S ENGINEER PRIOR TO THE PLACEMENT OF BACKFILL. NOTIFY THE ENGINEER 48 HOURS IN ADVANCE TO SCHEDULE INSPECTION.
- MAINTAIN THE STORM DRAINAGE SYSTEM UNTIL THE FINAL ACCEPTANCE OF THE PROJECT. THE STORM SYSTEM WILL BE INSPECTED BY THE OWNER'S ENGINEER PRIOR TO FINAL ACCEPTANCE.

ORDINANCE 85-43 NOTE:

- ORDINANCE 85-43 REQUIRES A STATEMENT WHETHER PROPOSED SWALE GRADES ARE CONSISTENT WITH ORIGINAL DRAINAGE PLANS.
- THE PROPOSED GRADES ON THESE PLANS ARE CONSISTENT WITH THE ORIGINAL GRADES. THE ONLY MINOR MODIFICATION IS THAT THE FLOWLINE LOCATIONS ADJACENT TO THE PROPOSED ROADWAY ALIGNMENT AND WIDENING HAVE BEEN ADJUSTED. UPSTREAM SWALES OUTSIDE THE PROJECT AREA ARE NOT ALTERED, NO ADVERSE IMPACT FROM THIS ROADWAY PROJECT IS FORESEEN. ENGINEER DOES NOT MAKE ANY STATEMENT AS TO NON R/W DRAINAGE PATTERNS BEYOND THE EXTENT OF THE SURVEY AND PROJECT AREA.

PAY ITEM NOTES

- 520-1-10
DROP CURB AND FLUME QUANTITIES WILL BE PAID FOR UNDER CONCRETE CURB & GUTTER, TYPE F.

| HORIZONTAL & VERTICAL CONTROL TABLE | | | | | | |
|-------------------------------------|---------|----------|------------|------------|-----------|------------------------------|
| POINT | STATION | OFFSET | NORTHING | EASTING | ELEVATION | DESCRIPTION |
| T.B.M. # 43 | 0+24.47 | 0.23 LT | 980,791.78 | 636,731.99 | 24.59 | 5/8" IRON ROD SET L.B. #6639 |
| T.B.M. # 44 | 0+99.75 | 0.19 LT | 980,786.60 | 636,831.76 | 25.07 | 5/8" IRON ROD SET L.B. #6639 |
| T.B.M. # 45 | 1+99.65 | 0.22 LT | 980,780.58 | 636,931.48 | 25.11 | 5/8" IRON ROD SET L.B. #6639 |
| T.B.M. # 46 | 2+99.64 | 0.17 LT | 980,773.60 | 637,031.22 | 25.57 | 5/8" IRON ROD SET L.B. #6639 |
| T.B.M. # 47 | 2+83.14 | 43.47 RT | 980,731.27 | 637,011.60 | 24.85 | NAIL & DISK SET L.B. #6639 |
| T.B.M. # 48 | 3+99.55 | 0.23 LT | 980,765.80 | 637,130.82 | 25.91 | 5/8" IRON ROD SET L.B. #6639 |
| T.B.M. # 49 | 4+99.50 | 0.25 LT | 980,757.08 | 637,230.40 | 26.25 | 5/8" IRON ROD SET L.B. #6639 |
| T.B.M. # 50 | 5+99.51 | 1.52 LT | 980,748.70 | 637,330.07 | 26.57 | 5/8" IRON ROD SET L.B. #6639 |
| T.B.M. # 51 | 6+60.79 | 43.16 RT | 980,697.92 | 637,386.28 | 25.97 | NAIL & DISK SET L.B. #6639 |
| T.B.M. # 52 | 6+99.65 | 0.09 LT | 980,736.72 | 637,429.51 | 26.39 | 5/8" IRON ROD SET L.B. #6639 |

11/08/2024 3:24:47 PM KaiwenChen S:\Projects\DOT\Veterans At LoveLand\Roadway\GMWTRD01.dgn

THE OFFICIAL RECORD OF THIS SHEET IS THE ELECTRONIC FILE DIGITALLY SIGNED AND SEALED UNDER RULE 61G15-23.004, F.A.C.

| REVISIONS | | | | ENGINEER OF RECORD | | SHEET NO. |
|-----------|-------------|------|-------------|--|--|-----------|
| DATE | DESCRIPTION | DATE | DESCRIPTION | | | |
| | | | | KRIS KARANXHA, P.E. LICENSE NUMBER 92368 FLORIDA TRANSPORTATION ENGINEERING, INC. 11458 NORTH 53RD STREET TAMPA, FLORIDA 33617 | | 5 |
| | | | | CHARLOTTE COUNTY PUBLIC WORKS DEPARTMENT | | |

GENERAL NOTES (1)

SIGNING AND PAVEMENT MARKING NOTES

1. ALL MARKINGS SHALL BE PAINT, NO THERMOPLASTIC.
2. PERMANENT RPM'S AS REQUIRED FOR MAINLINE EDGE, CENTER, AND LANE LINES SHALL BE PLACED WITHIN 72 HOURS OF COMPLETION OF THE MAINLINE SURFACE COURSE, OTHER LOCATIONS FOR RPM'S PLACEMENT MAY BE DESIGNATED BY THE COUNTY

LIGHTING NOTES

1. REFER TO STANDARD PLANS INDEX 715-002 FOR USE OF STANDARD CONCRETE FOUNDATIONS.
2. ANY DAMAGED PORTIONS OF POLES, FIXTURES AND BRACKET ARMS WILL BE REJECTED.
3. ALL CONDUITS THAT WILL REMAIN EMPTY SHALL BE MANDREL TESTED, CLEANED INSIDE AND BOTH ENDS CAPPED. LEAVE THE CORROSION RESISTANT PULL WIRE AND PLACE PULL BOXES TO MARK THE LOCATION OF THE ENDS OF THE CONDUITS.
4. ALL MATERIAL, UNLESS OTHERWISE SPECIFIED, SHALL BE UNDERWRITERS LABORATORY (UL APPROVED).
5. PULL BOXES SHALL MEET CHARLOTTE COUNTY STANDARDS.
6. ALL PULL BOXES FOR ROADWAY LIGHTING SHALL HAVE STAMPED COVERS LABELED "STREET LIGHTING".
7. INSTALLATION OF LIGHTING POLES AND CIRCUITS SHALL BE IN ACCORDANCE WITH THE FDOT STANDARD PLANS-FY 2023-24, INDEX 715-001, AND THE LATEST NATIONAL ELECTRIC CODE. ALL COMPONENTS SHALL BE PROPERLY GROUNDED AND BONDED PER N.E.C. AND N.E.S.C. CODE AND CURRENT EDITION OF THE CHARLOTTE COUNTY LIGHTING DISTRICT SUPPLEMENTAL SPECIFICATIONS.
8. FOUR COPIES OF SHOP DRAWINGS AND DESIGN DATA SHALL BE SUBMITTED TO THE ENGINEER OF RECORD WITH A COPY OF THE SUBMITTAL LETTER SENT TO CHARLOTTE COUNTY PUBLIC WORKS, PROJECT MANAGER. A COPY OF SHOP DRAWINGS SHALL BE SENT TO CHARLOTTE COUNTY FOR REVIEW AND APPROVAL, ALLOW A 30 DAY TURNAROUND FOR SUBMITTALS.
9. LIGHTING CONTRACTOR MUST FOLLOW ALL OSHA RULES AND REGULATIONS WHEN WORKING IN THE VICINTY OF ENERGIZED FPL HIGH VOLTAGE ELECTRIC LINES. AT NO TIME SHOULD ANY PERSONNEL OR EQUIPMENT BE CLOSER THAN 10 FEET TO SAID ENERGIZED LINES.
10. PULLING INSTRUCTIONS: CONNECT PULLING DEVICES TO COPPER WIRE AND NOT TO JACKET AND MEET MANUFACTURER'S REQUIREMENTS. ALL BENDS SHALL BE NOT LESS THAN RECOMMENDED BY N.E.C. OR N.E.S.C. FOR CABLES USED.
11. STAKE ALL POLE LOCATIONS AND REQUEST UTILITY COMPANIES TO LOCATE AND STAKE UNDERGROUND UTILITIES PRIOR TO DRILLING, OR SETTING HELICAL FOUNDATIONS.
12. NOTIFY FPL AT LEAST 48 HOURS PRIOR TO ANY INSTALLATION THAT IS WITHIN 10 FEET OF ENERGIZED ELECTRICAL CONDUCTORS. FPL AT ITS OPTION SHALL ASSIST THE CONTRACTOR TO COVER UP ENERGIZED CONDUCTORS AT INSTALLATION SITE OR TAKE OTHER ACTION AT ALL TIMES IN PERFORMANCE OF WORK AROUND ANY PRIMARY, HIGH VOLTAGE COMPONENTS.
13. MINIMUM DEPTH OF COVER ON THE LIGHTING CONDUIT SHALL BE 36".
14. INSTALL SURGE PROTECTIVE DEVICES, PROPERLY GROUNDED IN POWER (SECONDARY) ENTRANCES.
15. WHENEVER POSSIBLE ALL CONDUITS UNDER ROADWAY AND SIDEWALK SHALL BE INSTALLED PRIOR TO INSTALLATION OF THE ROADWAY BASE AND SURFACE. NO OPEN CUT OF FINAL PAVEMENT SURFACES SHALL BE ALLOWED.
16. CONSTRUCT DIRECTIONAL BORE CONDUIT AND TERMINATE INTO SEPARATE PULL BOXES.
17. AT LOCATIONS WHERE UNDERGROUND UTILITIES ARE WITHIN 4 FEET OF THE LIGHTING POLE FOUNDATIONS OR CONDUIT RUN, AS DETERMINED BY THE ENGINEER, IT MAY BE NECESSARY TO INVESTIGATE FOUNDATION OR CONDUIT RUN BY HAND DIGGING.
18. ALL CONDUIT TRENCHES SHALL BE BACKFILLED COMPLETELY TO PROVIDE SAFE CROSSING BY THE END OF EACH WORKING DAY OR WHENEVER THE WORK ZONE BECOMES INACTIVE. DO NOT OPEN ANY AREA THAT CANNOT BE BACKFILLED IN THE SAME DAY/NIGHT OPERATION.
19. ANY EXCESS DIRT AND DEBRIS RESULTING FROM INSTALLATION OF POLE FOUNDATION, TRENCHING OR DIRECTIONAL DRILLING SHALL BE REMOVED DAILY TO AREAS APPROVED BY THE ENGINEER.
20. THERE SHALL BE NO SPLICES MADE IN PULL BOXES UNLESS AUTHORIZED BY CHARLOTTE COUNTY LIGHTING DISTRICT.
21. ALL CURRENT CARRYING CONDUCTORS SHALL HAVE BLACK AND WHITE THHN/THWN INSULATION RATED AT 600 VOLTS. ALL GROUNDED CONDUCTORS SHALL HAVE WHITE CONTINUOUS THHN/THWN INSULATION RATED AT 600 VOLTS. ALL GROUNDING CONDUCTORS SHALL HAVE CONTINUOUS GREEN THHN/THWN INSULATION RATED AT 600 VOLTS.

22. CONDUCTORS SHALL BE INSTALLED WITH SUFFICIENT SLACK AT THE BASE OF THE POLE TO ALLOW WIRES AND CONNECTIONS TO BE PULLED OUTSIDE THE TRANSFORMER BASE HOUSING.
23. AT EACH LIGHT POLE CONNECT PULL BOX TO LIGHT POLE FOUNDATION BY MEANS OF TWO 1 1/4" SEAL TIGHT CONDUITS.
24. ALL NON-ELECTRICAL THREADED HARDWARE, ALL MECHANICAL ELECTRICAL CONNECTIONS AND ANY THREADED COMPONENT REQUIRING ASSEMBLY SHALL BE COATED WITH IDEAL NOALOX ANTI-OXIDANT COMPOUND.

ITS NOTES







1. OBTAIN PRIOR AUTHORIZATION FOR MODIFICATION TO CHARLOTTE COUNTY IT FIBER. ALL IT FIBER WORK IS TO BE COMPLETED AFTER NORMAL WORKING HOURS

11/08/2024 3:24:47 PM KaiwenChen S:\Projects\DOT\Veterans At Loveland\Roadway\GMWTRD01.dgn

| REVISIONS | | ENGINEER OF RECORD | | CHARLOTTE COUNTY PUBLIC WORKS DEPARTMENT | GENERAL NOTES (2) | SHEET NO. |
|-----------|-------------|--------------------|--|---|-------------------|-----------|
| DATE | DESCRIPTION | DATE | DESCRIPTION | | | 6 |
| | | | OLIVER REMY RODRIGUES, P.E., P.T.O.E. LICENSE NUMBER 50646 FLORIDA TRANSPORTATION ENGINEERING, INC. 11458 NORTH 53RD STREET TAMPA, FLORIDA 33617 | | | |

THE OFFICIAL RECORD OF THIS SHEET IS THE ELECTRONIC FILE DIGITALLY SIGNED AND SEALED UNDER RULE 61G15-23.004, F.A.C.

LEGEND

-  WIDENING
-  4" THICK CONCRETE SIDEWALK
-  2" MISCELLANEOUS ASPHALT PAVEMENT
-  DETECTABLE WARNING
-  MILLING AND RESURFACING
-  6" CONC. DRIVEWAY
-  CONC. REMOVAL

VETERANS BLVD

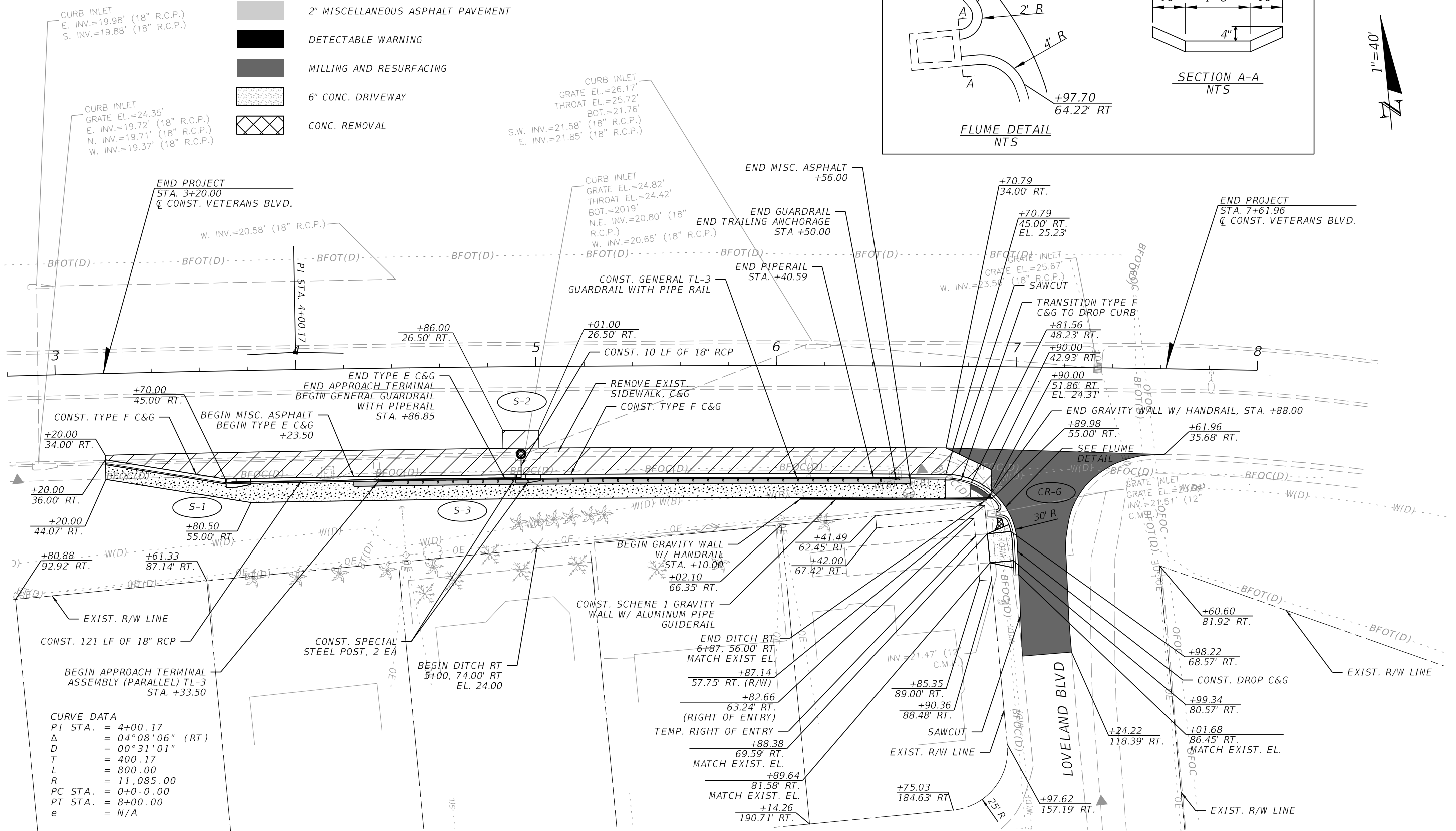
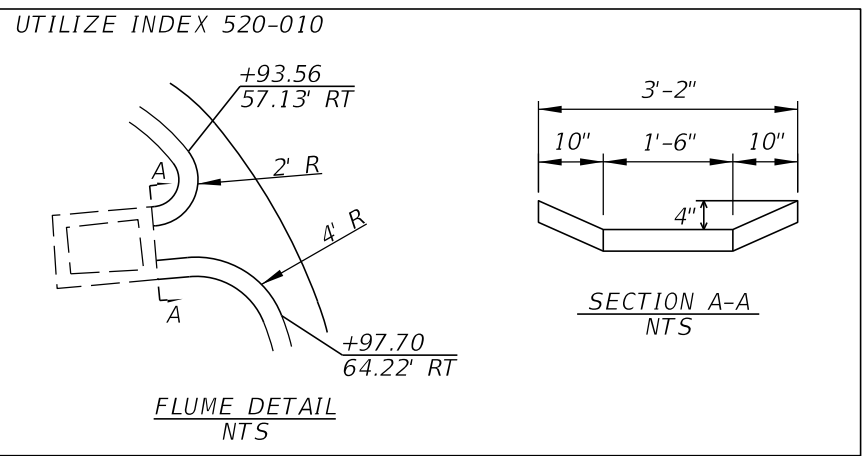

CURVE DATA
 PI STA. = 4+00.17
 Δ = 04°08'06" (RT)
 D = 00°31'01"
 T = 400.17
 L = 800.00
 R = 11,085.00
 PC STA. = 0+0-0.00
 PT STA. = 8+00.00
 e = N/A

11/08/2024 4:45:01 PM Carly S:\Projects\FDOT\Veterans At Loveland\Roadway\PLAN\RD01.dgn

THE OFFICIAL RECORD OF THIS SHEET IS THE ELECTRONIC FILE DIGITALLY SIGNED AND SEALED UNDER RULE 61G15-23.004, F.A.C.

| REVISIONS | | ENGINEER OF RECORD | | SHEET NO. |
|-----------|-------------|--------------------|--|------------------------------|
| DATE | DESCRIPTION | DATE | DESCRIPTION | |
| | | | KRIS KARANXHA, P.E. LICENSE NUMBER 92368 FLORIDA TRANSPORTATION ENGINEERING, INC. 11458 NORTH 53RD STREET TAMPA, FLORIDA 33617 | ROADWAY PLAN 7 |
| | | | CHARLOTTE COUNTY PUBLIC WORKS DEPARTMENT | |

VETERANS BLVD

LEGEND

- [XX.XX] EXIST. ELEVATION
- [XX.XX] PROPOSED ELEVATION

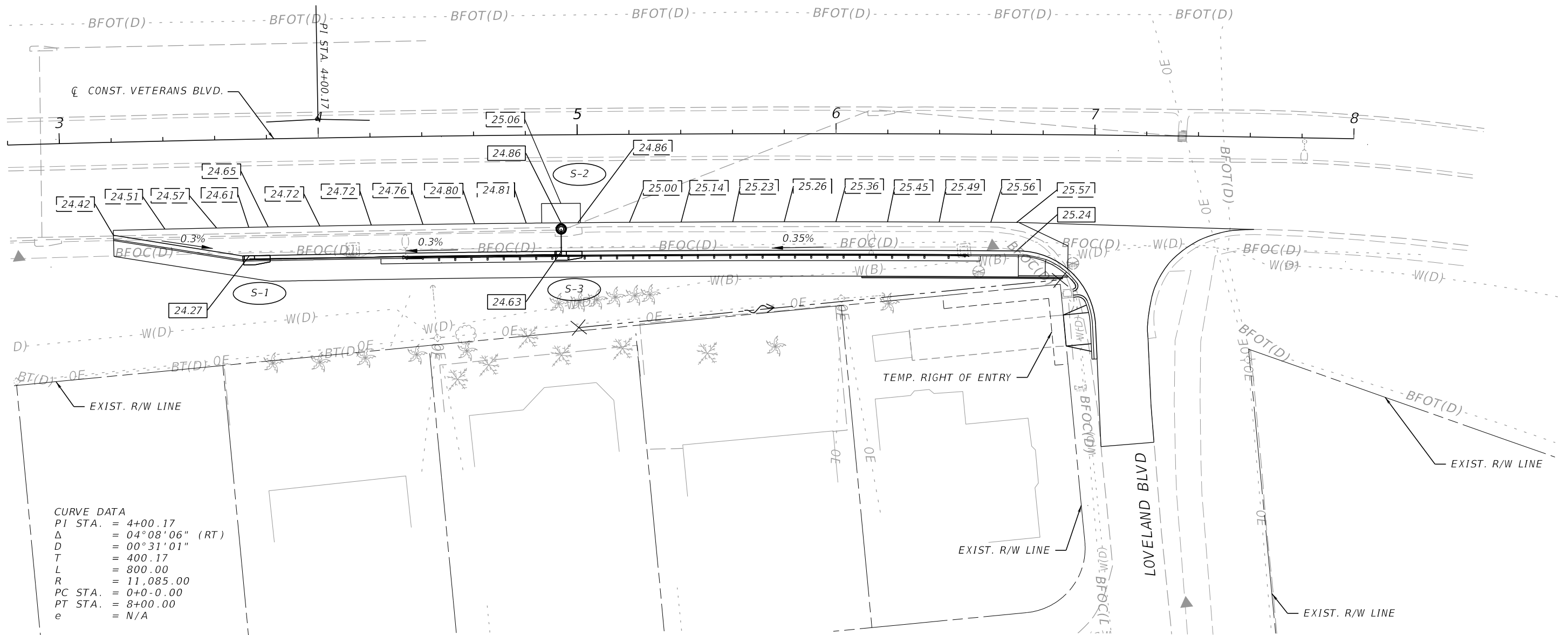

CURVE DATA

| | |
|---------|------------------|
| PI STA. | = 4+00.17 |
| Δ | = 04°08'06" (RT) |
| D | = 00°31'01" |
| T | = 400.17 |
| L | = 800.00 |
| R | = 11,085.00 |
| PC STA. | = 0+0-0.00 |
| PT STA. | = 8+00.00 |
| e | = N/A |

| REVISIONS | | ENGINEER OF RECORD | | CHARLOTTE COUNTY PUBLIC WORKS DEPARTMENT | GRADING PLAN | SHEET NO. 8 |
|-----------|-------------|--------------------|-------------|---|--------------|----------------|
| DATE | DESCRIPTION | DATE | DESCRIPTION | | | |
| | | | | | | |

11/19/2025 2:24:25 PM KaiwenChen Z:\Projects\DOT\Veterans At Loveland\Roadway\PLAN\RD01 - Grading.dgn

THE OFFICIAL RECORD OF THIS SHEET IS THE ELECTRONIC FILE DIGITALLY SIGNED AND SEALED UNDER RULE 61G15-23.004, F.A.C.

11/8/2024 3:25:06 PM KaiwenChen S:\Projects\FDOT\Veterans At Loveland\Drainage\DRX\SRD01.dgn

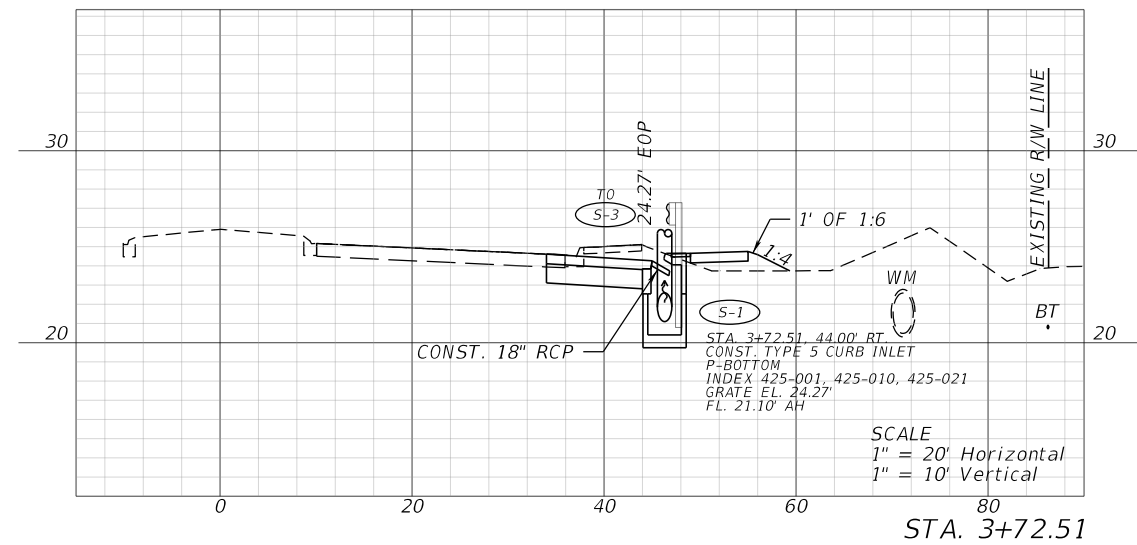
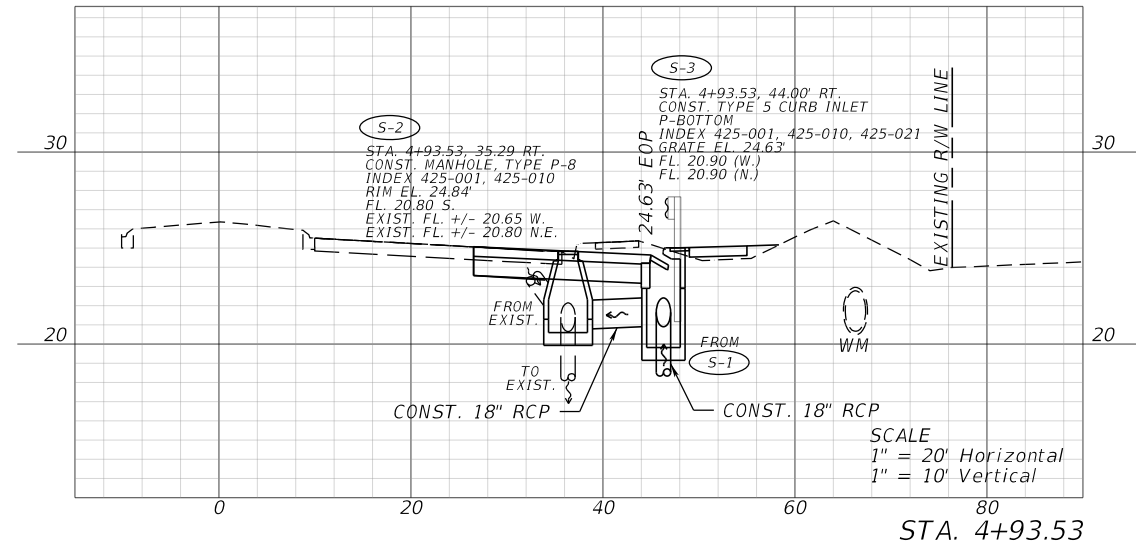

| REVISIONS | | | | ENGINEER OF RECORD | |
|-----------|-------------|------|-------------|--|--|
| DATE | DESCRIPTION | DATE | DESCRIPTION | | |
| | | | | MICHAEL T. MELTON, P.E. LICENSE NUMBER 77054 FLORIDA TRANSPORTATION ENGINEERING, INC. 8250 PASCAL DRIVE PUNTA GORDA, FLORIDA 33950 | |

CHARLOTTE COUNTY
PUBLIC WORKS DEPARTMENT

DRAINAGE STRUCTURES

SHEET
NO.

9

THE OFFICIAL RECORD OF THIS SHEET IS THE ELECTRONIC FILE DIGITALLY SIGNED AND SEALED UNDER RULE 61G15-23.004, F.A.C.

11/8/2024 3:25:15 PM KaiwenChen
 S:\Projects\DOT Veterans At Loveland\Roadway\RD\SRD01.dgn

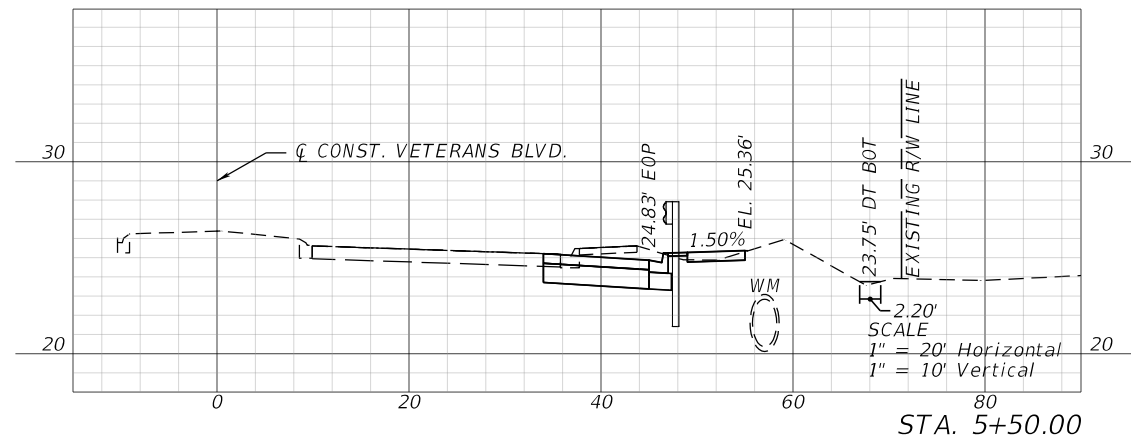
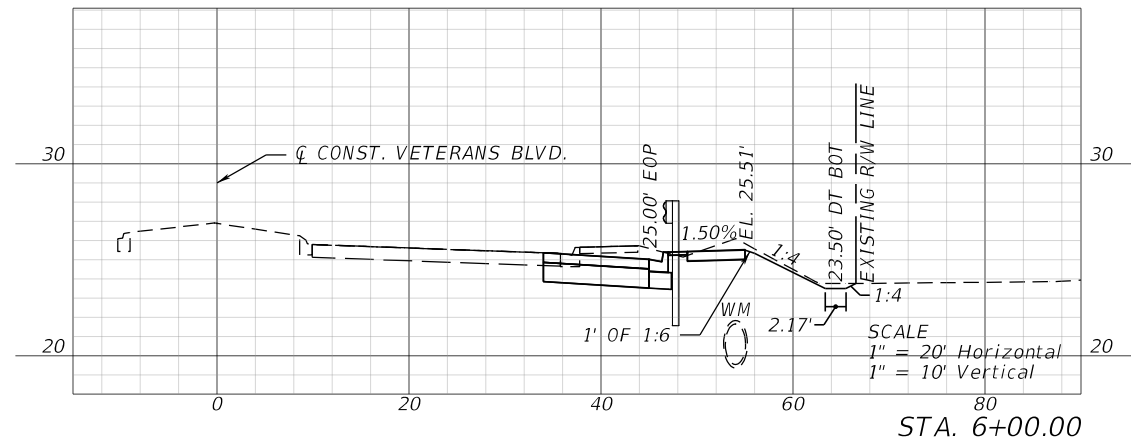
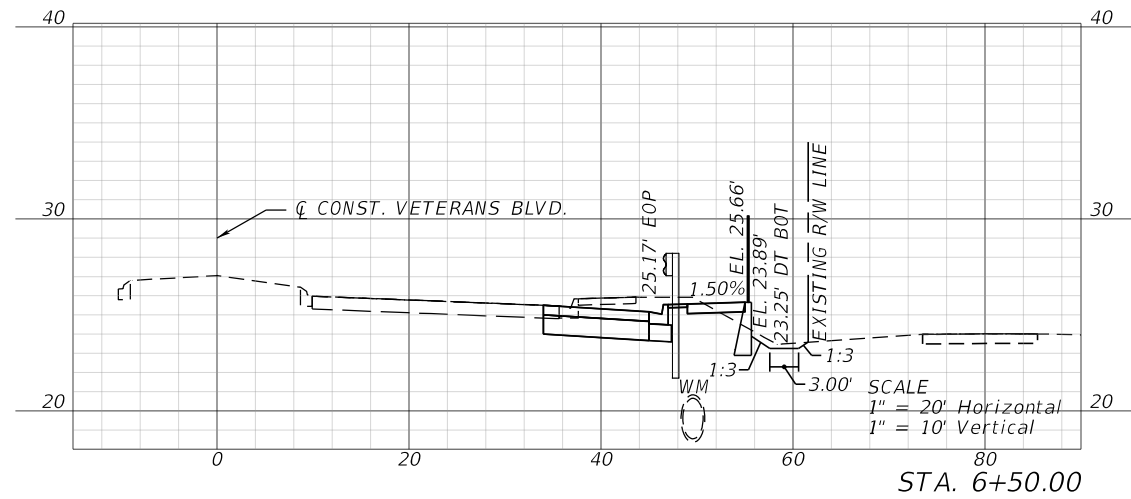
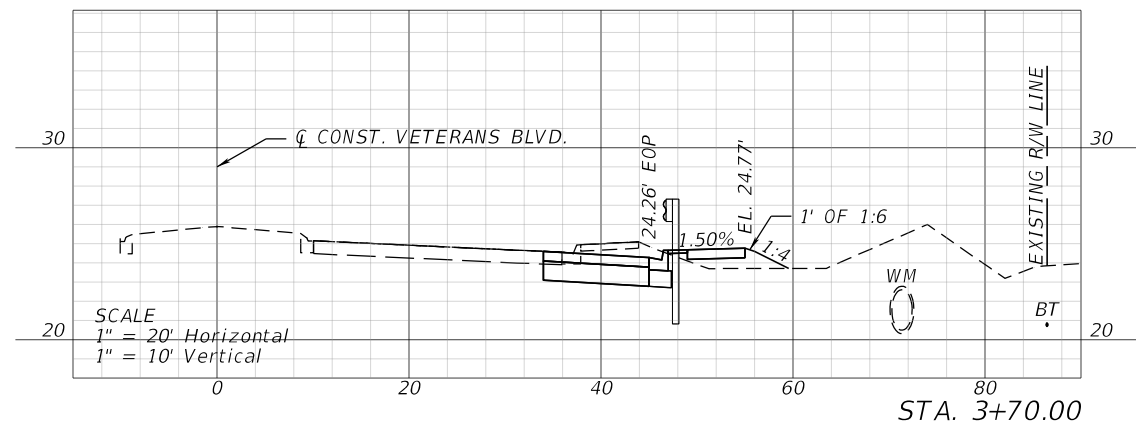
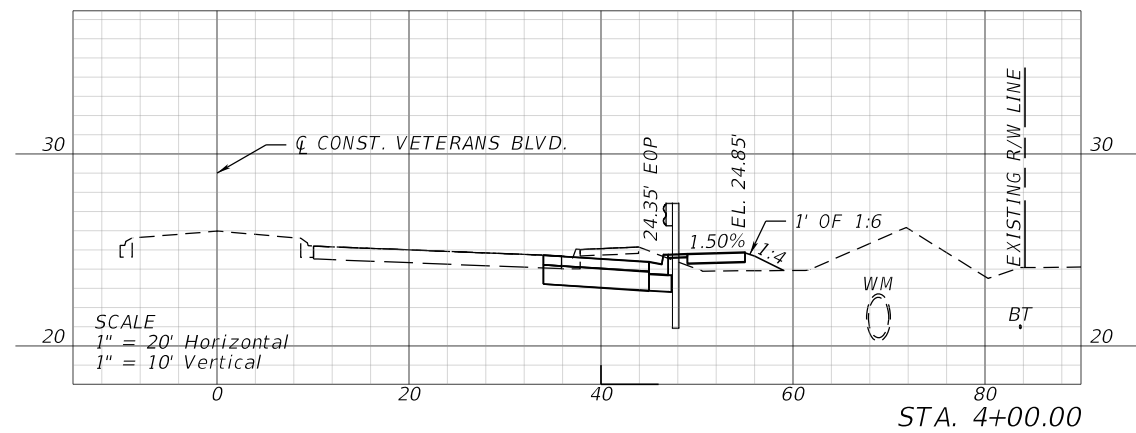
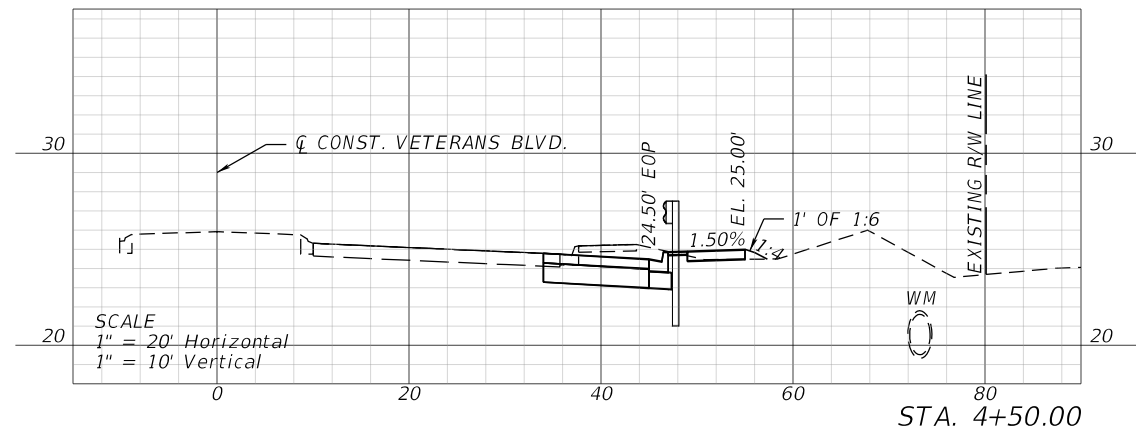
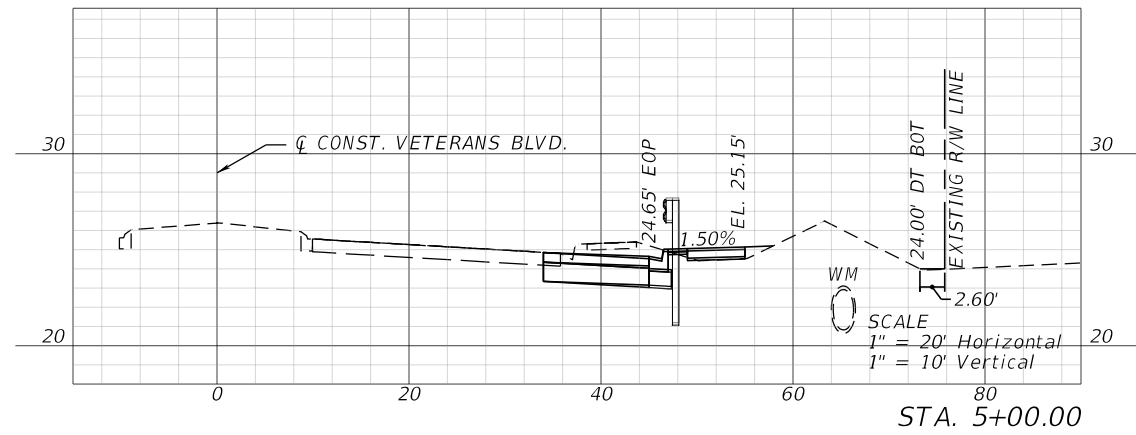

| REVISIONS | | | | ENGINEER OF RECORD | | SHEET NO. |
|---------------------------|-------------|------|-------------|--|--|-----------|
| DATE | DESCRIPTION | DATE | DESCRIPTION | | | |
| | | | | KRIS KARANXHA, P.E. LICENSE NUMBER 92368 FLORIDA TRANSPORTATION ENGINEERING, INC. 11458 NORTH 53RD STREET TAMPA, FLORIDA 33617 | | 10 |
| | | | | CHARLOTTE COUNTY PUBLIC WORKS DEPARTMENT | | |
| CROSS SECTIONS (1) | | | | | | |

THE OFFICIAL RECORD OF THIS SHEET IS THE ELECTRONIC FILE DIGITALLY SIGNED AND SEALED UNDER RULE 61G15-23.004, F.A.C.

11/8/2024 3:25:15 PM KaiwenChen
 S:\Projects\DOT Veterans At Loveland\Roadway\RD\SRD01.dgn

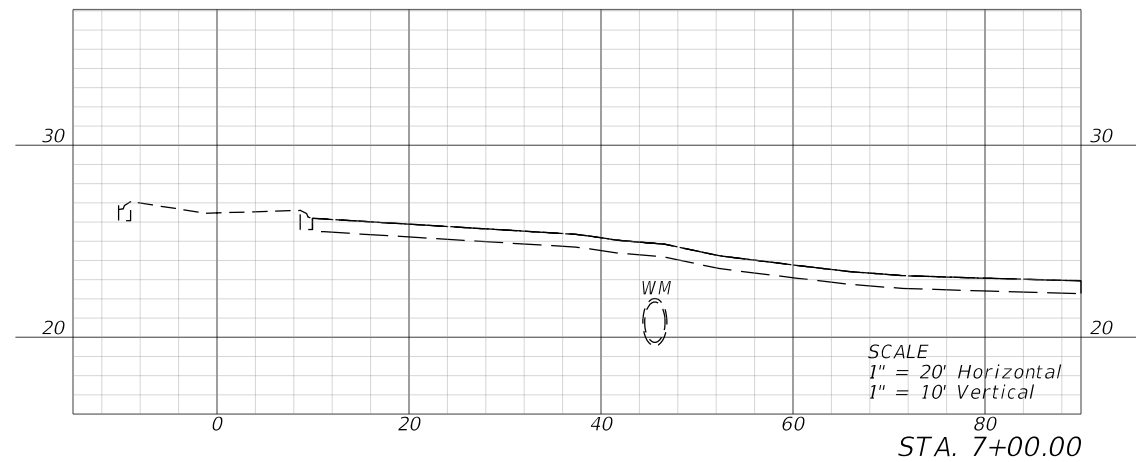

| REVISIONS | | REVISIONS | | ENGINEER OF RECORD | | CHARLOTTE COUNTY PUBLIC WORKS DEPARTMENT | CROSS SECTIONS (2) | SHEET NO. |
|-----------|-------------|-----------|-------------|--|--|---|--------------------|-----------|
| DATE | DESCRIPTION | DATE | DESCRIPTION | KRIS KARANXHA, P.E. LICENSE NUMBER 92368 FLORIDA TRANSPORTATION ENGINEERING, INC. 11458 NORTH 53RD STREET TAMPA, FLORIDA 33617 | | | | 11 |
| | | | | | | | | |

THE OFFICIAL RECORD OF THIS SHEET IS THE ELECTRONIC FILE DIGITALLY SIGNED AND SEALED UNDER RULE 61G15-23.004, F.A.C.

LEGEND

INLET PROTECTION

VETERANS BLVD

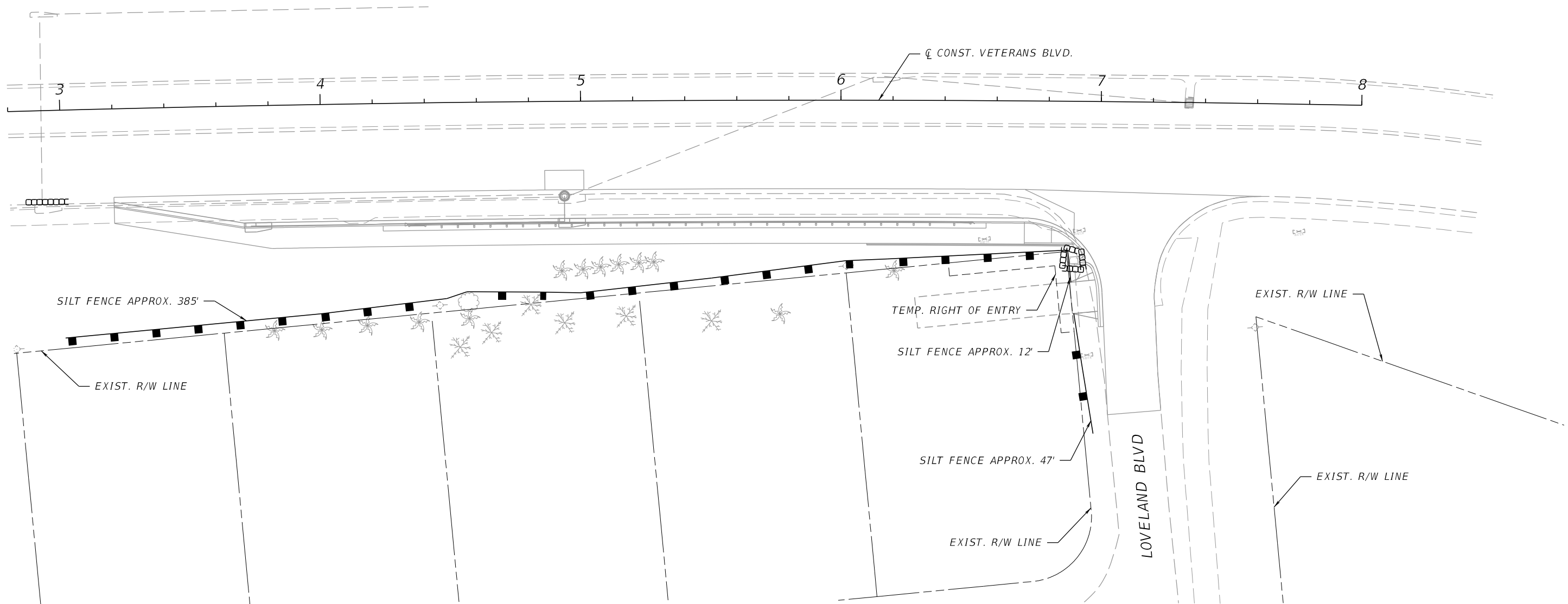

11/19/2025 2:24:27 PM KaiwenChen Z:\Projects\DOT\Veterans At Loveland\Roadway\PLAN\RD01_EC.dgn

THE OFFICIAL RECORD OF THIS SHEET IS THE ELECTRONIC FILE DIGITALLY SIGNED AND SEALED UNDER RULE 61G15-23.004, F.A.C.

| REVISIONS | | ENGINEER OF RECORD | | CHARLOTTE COUNTY PUBLIC WORKS DEPARTMENT | EROSION CONTROL PLAN | SHEET NO. |
|-----------|-------------|--------------------|-------------|--|----------------------|-----------|
| DATE | DESCRIPTION | DATE | DESCRIPTION | | | 12 |
| | | | | KRIS KARANXHA, P.E. LICENSE NUMBER 92368 FLORIDA TRANSPORTATION ENGINEERING, INC. 11458 NORTH 53RD STREET TAMPA, FLORIDA 33617 | | |
| | | | | | | |

PHASING NOTES

PHASE I

1. INSTALL ADVANCE WARNING SIGNS AND WARNING DEVICES UTILIZING TRAFFIC CONTROL PLAN AND STANDARD PLAN INDEX 102 SERIES.
2. INSTALL TEMPORARY EROSION CONTROL DEVICES.
3. CONSTRUCT DRAINAGE AND ROADWAY WIDENING (EXCLUDING FINAL PAVEMENT LAYER) AND PEDESTRIAN IMPROVEMENTS UTILIZING INDEX 102-600, 102-602, 102-613, AND 102-615.

PHASE II

1. PLACE FINAL PAVEMENT LAYER, FINAL PAVEMENT MARKINGS AND SIGNS, UTILIZING INDEX 102-600, 102-602, 102-613, AND 102-615.

TRAFFIC CONTROL NOTES

1. REDUCE THE EXISTING POSTED SPEED FROM 55 MPH TO 45 MPH IN ADVANCE OF THE CONSTRUCTION LIMITS UTILIZING INDEX 102-613.
2. MAINTAIN PEDESTRIAN ACCESS UTILIZING INDEX 102-660.

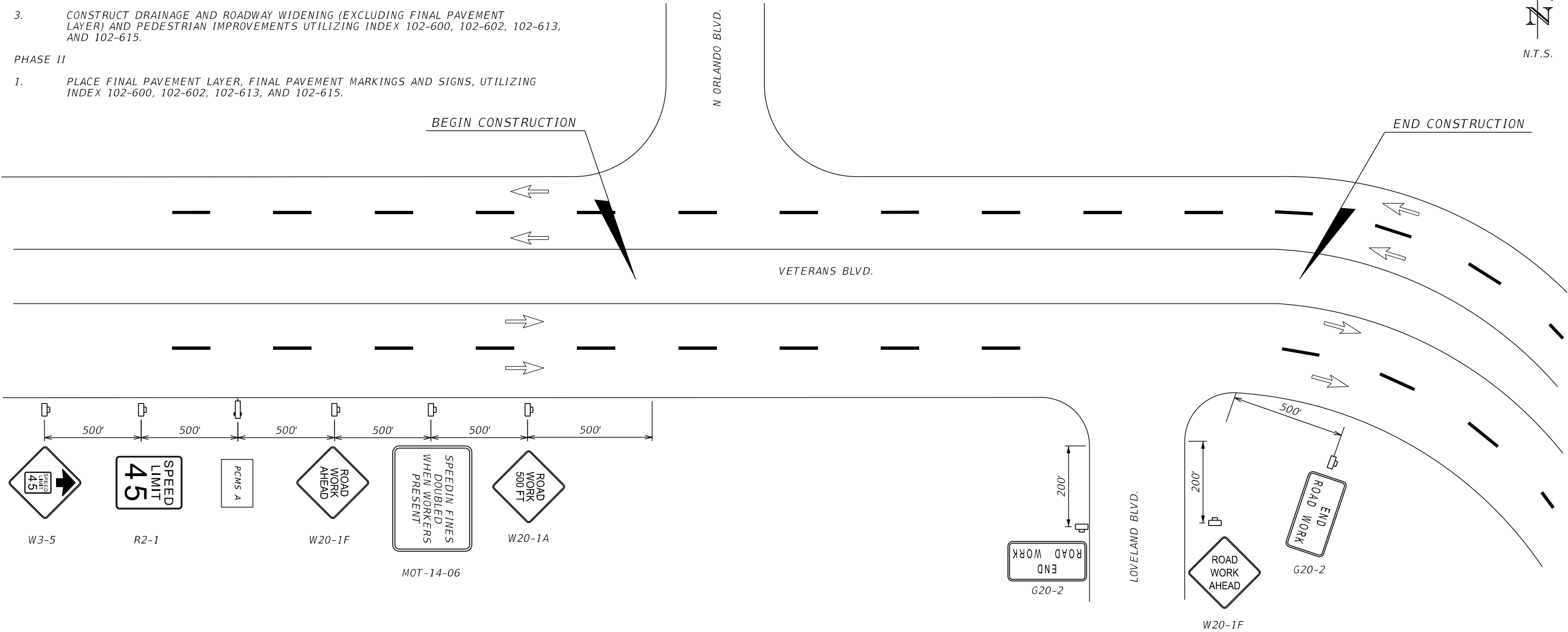

| | | | |
|-------------------------------|----------------|---------------------|------------|
| PCMS A | | PCMS A | |
| 14 DAYS PRIOR TO CONSTRUCTION | | DURING CONSTRUCTION | |
| ROAD WORK | XX/XX TO XX/XX | RIGHT LANE CLOSED | MERGE LEFT |

11/08/2024 3:25:27 PM KaiwenChen S:\Projects\FDOT\Veterans At Loveland\Roadway\TCPLRD01.dgn

THE OFFICIAL RECORD OF THIS SHEET IS THE ELECTRONIC FILE DIGITALLY SIGNED AND SEALED UNDER RULE 61G15-23.004, F.A.C.

| <table border="1"> <thead> <tr> <th colspan="2">REVISIONS</th> <th colspan="2">ENGINEER OF RECORD</th> </tr> <tr> <th>DATE</th> <th>DESCRIPTION</th> <th>DATE</th> <th>DESCRIPTION</th> </tr> </thead> <tbody> <tr> <td> </td> <td> </td> <td> </td> <td> </td> </tr> </tbody> </table> | | | | REVISIONS | | ENGINEER OF RECORD | | DATE | DESCRIPTION | DATE | DESCRIPTION | | | | | KRIS KARANXHA, P.E. LICENSE NUMBER 92368 FLORIDA TRANSPORTATION ENGINEERING, INC. 11458 NORTH 53RD STREET TAMPA, FLORIDA 33617 | | CHARLOTTE COUNTY PUBLIC WORKS DEPARTMENT | | TEMPORARY TRAFFIC CONTROL PLAN | | SHEET NO. 13 |
|---|-------------|--------------------|-------------|-----------|--|--------------------|--|------|-------------|------|-------------|--|--|--|--|--|--|---|--|-----------------------------------|--|--------------------|
| REVISIONS | | ENGINEER OF RECORD | | | | | | | | | | | | | | | | | | | | |
| DATE | DESCRIPTION | DATE | DESCRIPTION | | | | | | | | | | | | | | | | | | | |
| | | | | | | | | | | | | | | | | | | | | | | |

VETERANS BLVD



NOTES

1. THE LOCATION(S) OF THE UTILITIES SHOWN IN THE PLANS (INCLUDING THOSE DESIGNATED VV, VH, AND VVH) ARE BASED ON LIMITED INVESTIGATION TECHNIQUES AND SHOULD BE CONSIDERED APPROXIMATE ONLY. THE VERIFIED LOCATIONS/ELEVATIONS APPLY ONLY AT THE POINTS SHOWN. INTERPOLATIONS BETWEEN THESE POINTS HAVE NOT BEEN VERIFIED.
2. UTILITY/AGENCY OWNERS FOR THIS PROJECT INCLUDE:

COMPANY
 CENTURYLINK
 CHARLOTTE COUNTY LIGHTING DISTRICT
 CHARLOTTE COUNTY UTILITIES
 CHARLOTTE COUNTY ITS SYSTEM
 CROWN CASTLE
 FLORIDA POWER & LIGHT - CHARLOTTE (DISTRIBUTION)
 FLORIDA POWER & LIGHT - CHARLOTTE (TRANSMISSION)

CONTACT
 BILL CASE
 JODY MANSELL
 HENDRIK DOLLEMAN
 EVAN LEIBMAN
 DANNY HASKETT
 CHRIS MCJUNKIN
 CRAIG LEDBETTER

TELEPHONE NUMBERS
 (813) 558-3303
 (941) 575-3648
 (941) 883-3521
 (941) 764-5504
 (786) 610-7073
 (941) 267-7476
 (561) 803-7942

EMAIL ADDRESSES
 CASEB@AYRESASSOCIATES.COM
 JODY.MANSELL@CHARLOTTECOUNTYFL.GOV
 HENDRIK.DOLLEMAN@CHARLOTTECOUNTYFL.GOV
 EVAN.LEIBMAN@CHARLOTTECOUNTYFL.GOV
 SOUTHFLORIDAPLANSREVIEW@CROWNCastle.COM
 CHRIS.MCJUNKIN@FPL.COM
 CRAIG.LEDBETTER@FPL.COM

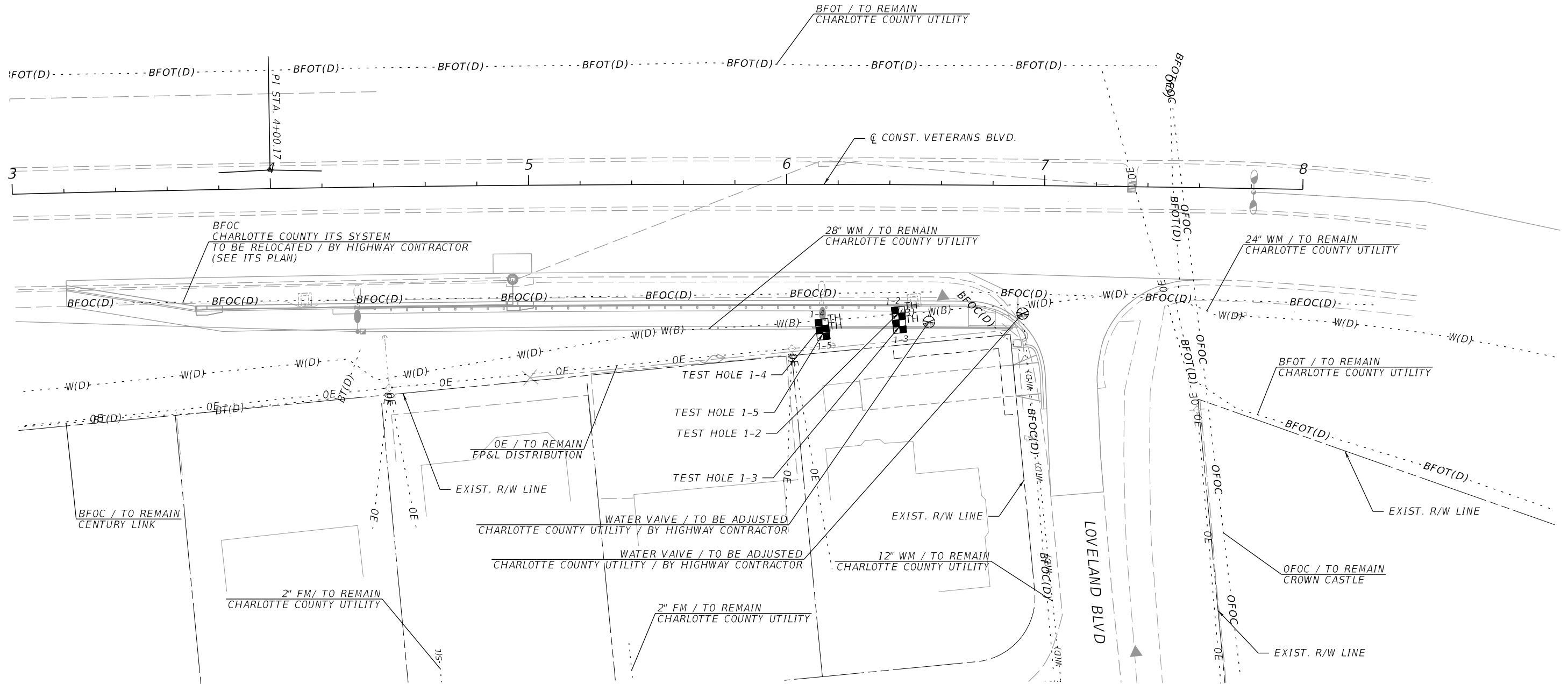

11/18/2025 10:40:29 AM KaiwenChen Z:\Projects\DOT\Veterans At Loveland\Roadway\UT\ADRD01.dgn

THE OFFICIAL RECORD OF THIS SHEET IS THE ELECTRONIC FILE DIGITALLY SIGNED AND SEALED UNDER RULE 61G15-23.004, F.A.C.

| REVISIONS | | ENGINEER OF RECORD | | CHARLOTTE COUNTY PUBLIC WORKS DEPARTMENT | UTILITY ADJUSTMENTS | SHEET NO. 15 |
|-----------|-------------|--------------------|-------------|--|---------------------|--------------------|
| DATE | DESCRIPTION | DATE | DESCRIPTION | | | |
| | | | | KRIS KARANXHA, P.E. LICENSE NUMBER 92368 FLORIDA TRANSPORTATION ENGINEERING, INC. 11458 NORTH 53RD STREET TAMPA, FLORIDA 33617 | | |

VETERANS BLVD.

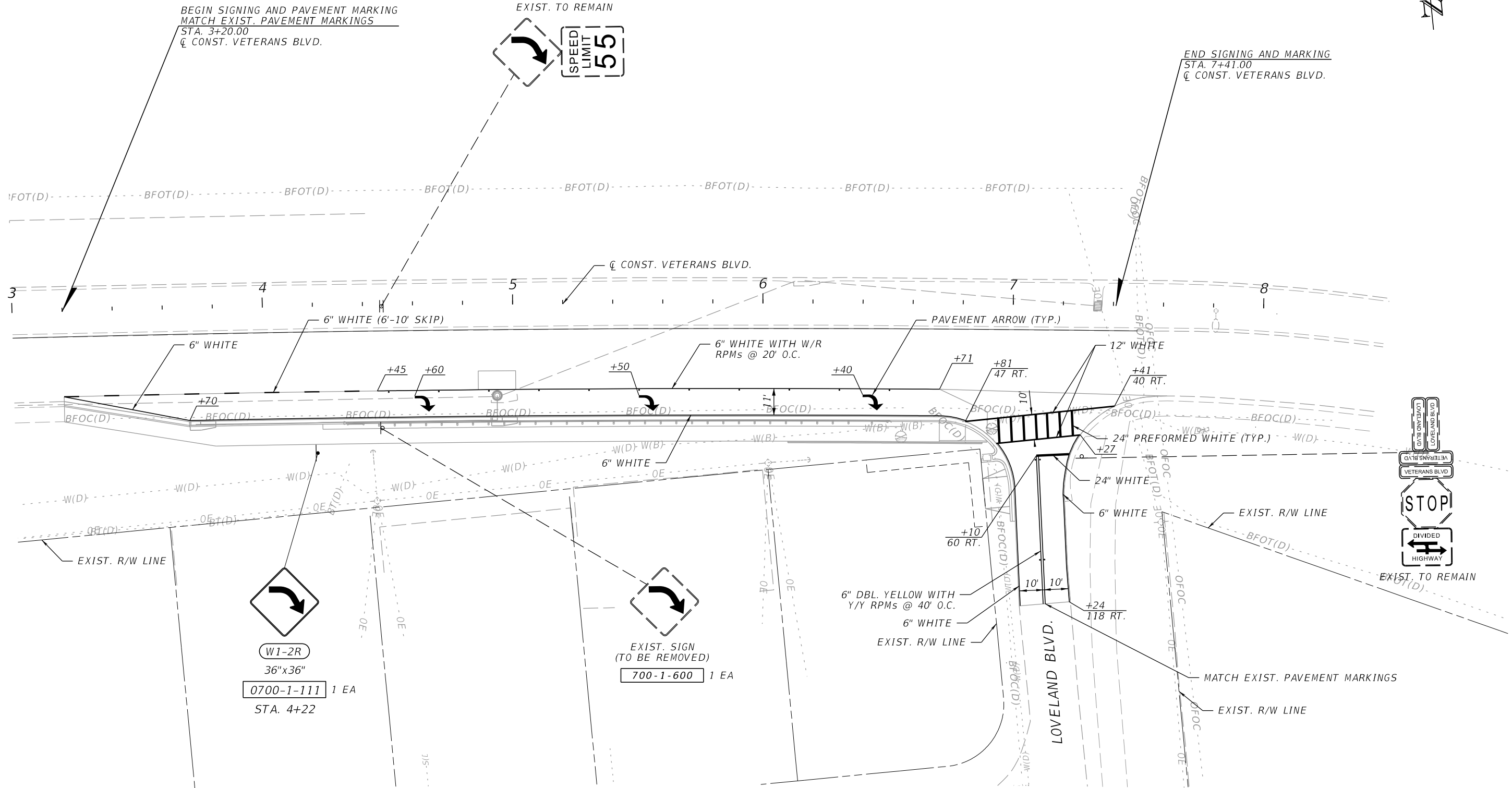

11/19/2025 4:26:40 PM CarryCorrales Z:\Projects\DOT\Veterans At Loveland\SigningAndMarking\PLANSPO2.dgn

THE OFFICIAL RECORD OF THIS SHEET IS THE ELECTRONIC FILE DIGITALLY SIGNED AND SEALED UNDER RULE 61G15-23.004, F.A.C.

| REVISIONS | | ENGINEER OF RECORD | | CHARLOTTE COUNTY PUBLIC WORKS DEPARTMENT | SIGNING AND PAVEMENT MARKING PLAN | SHEET NO. |
|-----------|-------------|--------------------|-------------|--|--------------------------------------|-----------|
| DATE | DESCRIPTION | DATE | DESCRIPTION | | | 16 |
| | | | | OLIVER REMY RODRIGUES, P.E., P.T.O.E. LICENSE NUMBER 50646 FLORIDA TRANSPORTATION ENGINEERING, INC. 11458 NORTH 53RD STREET TAMPA, FLORIDA 33617 | | |

W1-2R
 36"x36"
0700-1-111 1 EA
 STA. 4+22

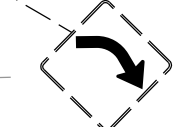
 EXIST. SIGN
 (TO BE REMOVED)
700-1-600 1 EA

VETERANS BLVD.

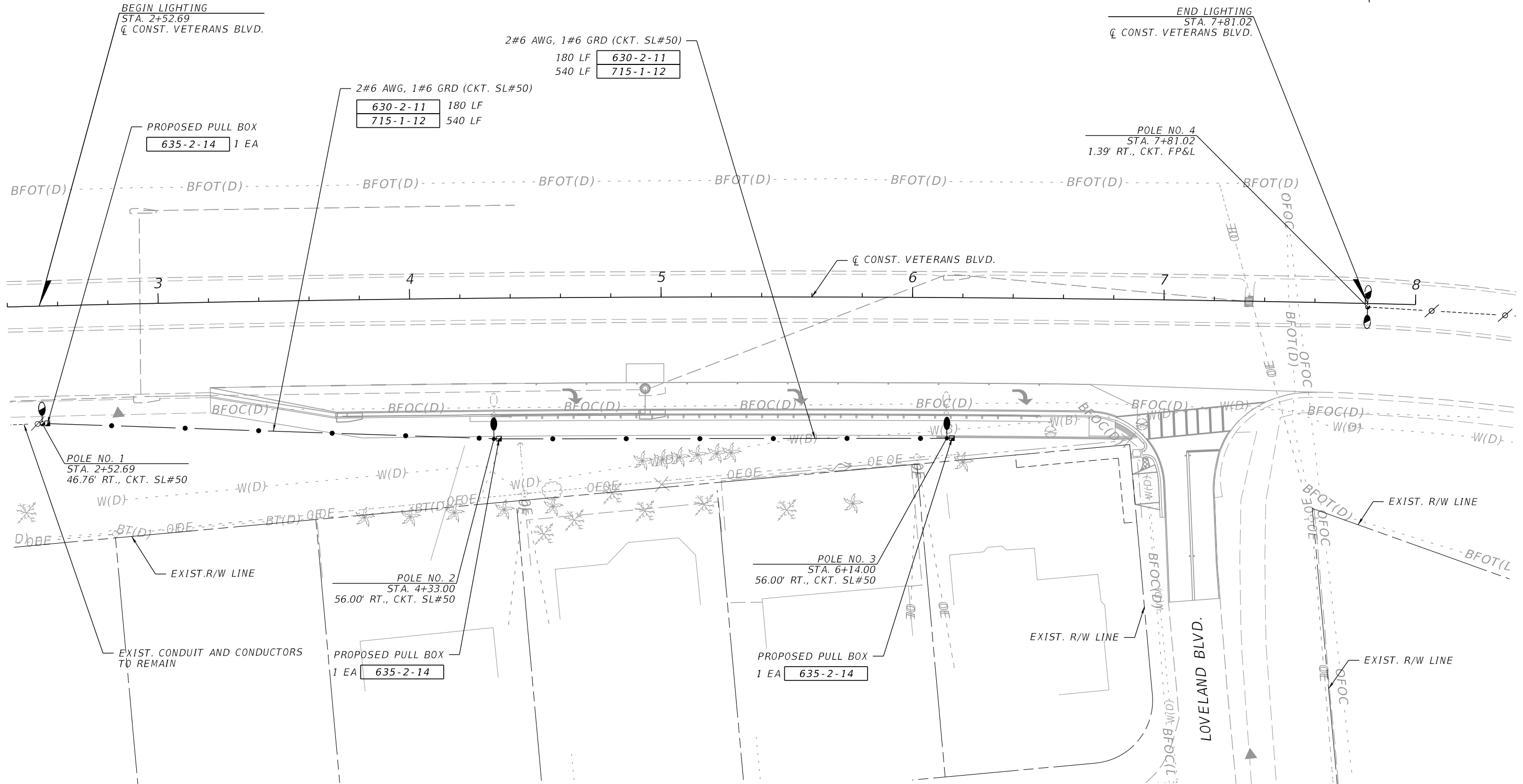

11/18/2025 10:22:27 AM KaiwenChen S:\Projects\FDOT Veterans At Loveland\Lighting\PLAN\T02.dgn

THE OFFICIAL RECORD OF THIS SHEET IS THE ELECTRONIC FILE DIGITALLY SIGNED AND SEALED UNDER RULE 61G15-23.004, F.A.C.

| REVISIONS | | | | ENGINEER OF RECORD | | SHEET NO. |
|-----------|-------------|------|-------------|--|--|-----------|
| DATE | DESCRIPTION | DATE | DESCRIPTION | CHARLOTTE COUNTY PUBLIC WORKS DEPARTMENT | | |
| | | | | OLIVER REMY RODRIGUES, P.E., P.T.O.E. LICENSE NUMBER 50646 FLORIDA TRANSPORTATION ENGINEERING, INC. 11458 NORTH 53RD STREET TAMPA, FLORIDA 33617 | | 19 |
| | | | | LIGHTING PLAN | | |